

# XB4BK124G5

red complete illuminated selector switch Ø22 2-  
position stay put 1NO+1NC 120V

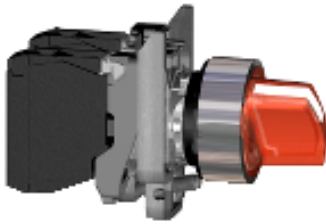

## Main

|                               |  |
|-------------------------------|--|
| Range of product              | Harmony XB4  |
| Product or component type     | Complete illuminated selector switch   |
| Device short name             | XB4  |
| Bezel material                | Chromium plated metal  |
| Fixing collar material        | Zamak  |
| Mounting diameter             | 22 mm  |
| Sale per indivisible quantity | 1  |
| Shape of signaling unit head  | Round  |
| Type of operator              | Stay put   |
| Operator profile              | Red standard handle  |
| Operator position information | 2 positions 90°  |
| Contacts type and composition | 1 NO + 1 NC  |
| Contact operation             | Slow-break   |
| Connections - terminals       | Screw clamp terminals : $\leq 2 \times 1.5 \text{ mm}^2$ with cable end conforming to EN/IEC 60947-1<br>Screw clamp terminals : $\geq 1 \times 0.22 \text{ mm}^2$ without cable end conforming to EN/IEC 60947-1 |
| Light source                  | Protected LED  |
| Bulb base                     | Integral LED   |
| [Us] rated supply voltage     | 110...120 V AC, 50/60 Hz   |

## Complementary

|                                    |                                      |
|------------------------------------|--------------------------------------|
| Height                             | 47 mm                                |
| Width                              | 30 mm                                |
| Depth                              | 68 mm                                |
| Terminals description ISO n°1      | (13-14)NO<br>(21-22)NC               |
| Product weight                     | 0.111 kg                             |
| Resistance to high pressure washer | 7000000 Pa at 55 °C, distance: 0.1 m |
| Contacts usage                     | Standard contacts                    |

|  |   |
|--|---|
| Positive opening   | With positive opening conforming to EN/IEC 60947-5-1 appendix K   |
| Operating torque   | 0.14 N.m (NO changing electrical state)   |
| Mechanical durability                                    | 1000000 cycles  |
| Tightening torque  | 0.8...1.2 N.m conforming to EN 60947-1  |
| Shape of screw head                                      | Cross head compatible with Philips no 1 screwdriver<br>Cross head compatible with pozidriv No 1 screwdriver<br>Slotted head compatible with flat Ø 4 mm screwdriver<br>Slotted head compatible with flat Ø 5.5 mm screwdriver   |
| Contacts material  | Silver alloy (Ag/Ni)  |
| Short-circuit protection                                 | 10 A cartridge fuse type gG conforming to EN/IEC 60947-5-1  |
| [I <sub>th</sub> ] conventional free air thermal current | 10 A conforming to EN/IEC 60947-5-1   |
| [U <sub>i</sub> ] rated insulation voltage               | 600 V (degree of pollution: 3) conforming to EN 60947-1   |
| [U <sub>imp</sub> ] rated impulse withstand voltage      | 6 kV conforming to EN 60947-1   |
| [I <sub>e</sub> ] rated operational current              | 3 A at 240 V, AC-15, A600 conforming to EN/IEC 60947-5-1<br>6 A at 120 V, AC-15, A600 conforming to EN/IEC 60947-5-1<br>0.1 A at 600 V, DC-13, Q600 conforming to EN/IEC 60947-5-1<br>0.27 A at 250 V, DC-13, Q600 conforming to EN/IEC 60947-5-1<br>0.55 A at 125 V, DC-13, Q600 conforming to EN/IEC 60947-5-1<br>1.2 A at 600 V, AC-15, A600 conforming to EN/IEC 60947-5-1  |
| Electrical durability                                    | 1000000 cycles, AC-15, 2 A at 230 V, operating rate: 3600 cyc/h, load factor: 0.5 conforming to EN 60947-5-1 appendix C<br>1000000 cycles, AC-15, 3 A at 120 V, operating rate: 3600 cyc/h, load factor: 0.5 conforming to EN 60947-5-1 appendix C<br>1000000 cycles, AC-15, 4 A at 24 V, operating rate: 3600 cyc/h, load factor: 0.5 conforming to EN 60947-5-1 appendix C<br>1000000 cycles, DC-13, 0.2 A at 110 V, operating rate: 3600 cyc/h, load factor: 0.5 conforming to EN 60947-5-1 appendix C<br>1000000 cycles, DC-13, 0.5 A at 24 V, operating rate: 3600 cyc/h, load factor: 0.5 conforming to EN 60947-5-1 appendix C |
| Electrical reliability                                   | $\Lambda < 10\exp(-6)$ at 5 V, 1 mA in clean environment conforming to EN/IEC 60947-5-4<br>$\Lambda < 10\exp(-8)$ at 17 V, 5 mA in clean environment conforming to EN/IEC 60947-5-4   |
| Signalling type  | Steady  |
| Supply voltage limits                                    | 100...132 V AC  |
| Current consumption                                      | 14 mA   |
| Service life   | 100000 h at rated voltage and 25 °C   |
| Surge withstand  | 1 kV conforming to IEC 61000-4-5  |

## Environment

|                                       |   |
|---------------------------------------|---|
| Protective treatment                  | TH  |
| Ambient air temperature for storage   | -40...70 °C   |
| Ambient air temperature for operation | -40...70 °C   |
| Electrical shock protection class     | Class I conforming to IEC 60536   |
| IP degree of protection               | IP69<br>IP67<br>IP66 conforming to IEC 60529<br>IP69K   |
| NEMA degree of protection             | NEMA 13<br>NEMA 4X  |
| IK degree of protection               | IK06 conforming to IEC 50102  |
| Standards                             | EN/IEC 60947-1<br>EN/IEC 60947-5-1<br>EN/IEC 60947-5-4<br>EN/IEC 60947-5-5<br>JIS C 4520<br>UL 508<br>CSA C22.2 No 14 |
| Product certifications                | BV<br>CSA<br>DNV<br>GL<br>LROS (Lloyds register of shipping)<br>RINA  |

UL

|                                       |  |
|---------------------------------------|--|
| Vibration resistance                  | 5 gn (f = 2...500 Hz) conforming to IEC 60068-2-6  |
| Shock resistance                      | 30 gn (duration = 18 ms) for half sine wave acceleration conforming to IEC 60068-2-27<br>50 gn (duration = 11 ms) for half sine wave acceleration conforming to IEC 60068-2-27 |
| Resistance to fast transients         | 2 kV conforming to IEC 61000-4-4   |
| Resistance to electromagnetic fields  | 10 V/m conforming to IEC 61000-4-3   |
| Resistance to electrostatic discharge | 6 kV on contact (on metal parts) conforming to IEC 61000-4-2<br>8 kV in free air (in insulating parts) conforming to IEC 61000-4-2   |
| Electromagnetic emission              | Class B conforming to IEC 55011  |

**Contractual warranty**

|                 |           |
|-----------------|-----------|
| Warranty period | 18 months |
|-----------------|-----------|

Dimensions



e : clamping thickness: 1 to 6 mm / 0.04 to 0.24 in.

Panel Cut-out for Pushbuttons, Switches and Pilot Lights (Finished Holes, Ready for Installation)

| Connection by Screw Clamp Terminals or Plug-in Connectors or on Printed Circuit Board   | Connection by Faston Connectors  |
|---|--|
|    |  |
| <p>(1) Diameter on finished panel or support<br/>                 (2) 40 mm min. / 1.57 in. min.<br/>                 (3) 30 mm min. / 1.18 in. min.<br/>                 (4) <math>\text{Ø } 22.5 \text{ mm} / 0.89 \text{ in. recommended } (\text{Ø } 22.3 \text{ mm }_0^{+0.4} / 0.88 \text{ in. }_0^{+0.016})</math><br/>                 (5) 45 mm min. / 1.78 in. min.<br/>                 (6) 32 mm min. / 1.26 in. min.</p> |  |