

**PLEASE CHECK WWW.MOLEX.COM FOR LATEST PART INFORMATION**

**Part Number:** [1300700024](#)  
**Status:** **Active**  
**Overview:** [Brad Quick-Change Connectors](#)  
**Description:** Quick-Change Male Field Attachable, 4 Pole, Straight

**Documents:**

[Drawing \(PDF\)](#) [RoHS Certificate of Compliance \(PDF\)](#)

**Agency Certification**

UL E258922

**General**

Product Family Field Attachable / Accessories  
 Series [130070](#)  
 IP Rating IP67  
 Material - Contact Copper Alloy  
 Overview [Brad Quick-Change Connectors](#)  
 Product Name Quick-Change  
 Type Field Attachable Connector  
 UPC 78678804606

**Physical**

Cable Diameter N/A  
 Coupling Type Internal Thread  
 Diagnostics / LEDs No  
 Diagnostics Port No  
 Gender Male  
 Keyway Single  
 Material - Connector Body PVC  
 Material - Coupling Nut Anodized Aluminum  
 Material - Plating Mating Gold over Copper  
 Net Weight 141.520/g  
 Orientation Straight  
 Poles 4  
 Temperature Range - Operating -20°C to +90°C  
 Wire Size AWG N/A

**Electrical**

Current - Maximum per Contact 30.0A  
 Voltage - Maximum 600V DC

**Material Info**

Engineering Number CA4006-39

**Reference - Drawing Numbers**

Sales Drawing SD-120336-002

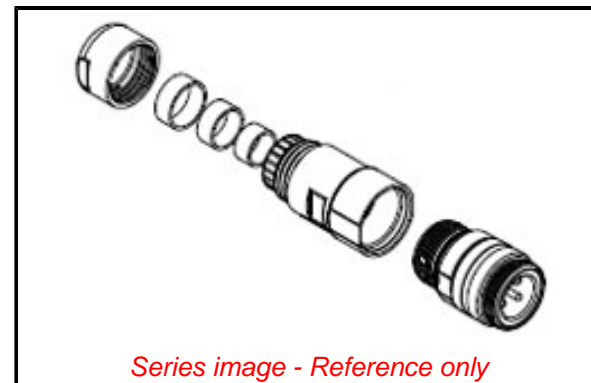

*Series image - Reference only*

**EU ELV**

**Not Relevant**

**EU RoHS**

**Not Reviewed**

**REACH SVHC**

Not Reviewed

**Halogen-Free**

**Status**

**Not Low-Halogen**

**Need more information on product environmental compliance?**

Email [productcompliance@molex.com](mailto:productcompliance@molex.com)  
 Please visit the [Contact Us](#) section for any non-product compliance questions.

China ROHS	Not Reviewed
ELV	Not Relevant
RoHS Phthalates	Not Reviewed

**China RoHS**

**Search Parts in this Series**

[130070 Series](#)