

Panel-mount Socket LB-I2R

Insulated Ø 2 mm rigid. Machined brass. Metal thread jacket on the insulation. The socket can be screw-mounted in predrilled panels.

Flat connecting tab 2.8 mm x 0.8 mm.

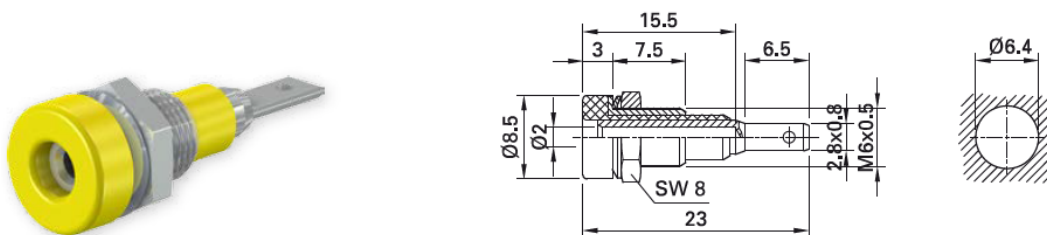

Order No.	Type	Rated voltage/current		*Colors										
23.0030-*	LB-I2R	30 VAC / 10 A 60 VDC / 10 A	Opt	<table border="1"> <tr> <td>20</td> <td>21</td> <td>22</td> <td>23</td> <td>24</td> </tr> <tr> <td>25</td> <td>26</td> <td>27</td> <td>28</td> <td>29</td> </tr> </table>	20	21	22	23	24	25	26	27	28	29
20	21	22	23	24										
25	26	27	28	29										

Component parts

23.5059-*	BI-LB-I2R	Socket
Page 68	MU/M6x0,5	Hexagon nut
Page 69	SP2	Washer