

# Plug XL-410

In-line, Ø 4 mm, with spring-loaded MULTILAM, for self-assembly of test leads.

With rigid insulating sleeve. **Screw connection.**

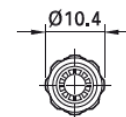
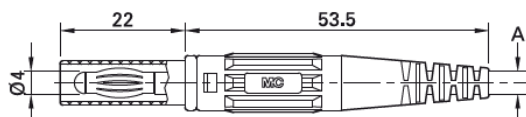

Order No.	Type	Rated voltage/current	Cable (A)		*Colors										
66.9196-*	XL-410	1000 V, CAT II / 32 A 600 V, CAT III / 32 A	max. Ø 3,9 mm    max. 2,5 mm <sup>2</sup>	Ni	<table border="1"> <tr> <td>21</td> <td>22</td> <td>23</td> <td>24</td> <td>25</td> </tr> <tr> <td>26</td> <td>27</td> <td>29</td> <td></td> <td></td> </tr> </table>	21	22	23	24	25	26	27	29		
21	22	23	24	25											
26	27	29													



Assembly instructions MAH503

[www.staubli.com/electrical](http://www.staubli.com/electrical)