

## Plug SLS2-F

Stackable, Ø 2 mm hollow plugs for self-assembly of test leads.

**Solder connection.**

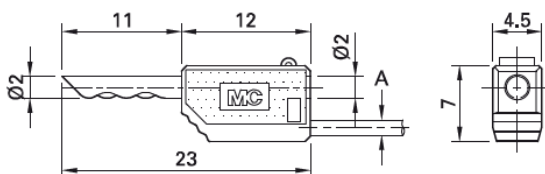
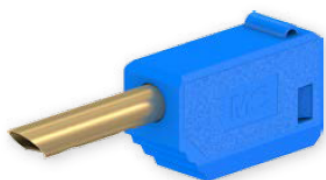

Assembly instructions MA133

[www.staubli.com/electrical](http://www.staubli.com/electrical)

Order No.	Type	Rated voltage/current	Cable (A)		*Colors																					
22.2611-*	SLS2-F	30 VAC / 10 A 60 VDC / 10 A	<table border="0"> <tr> <td>PVC</td> <td>TPE</td> <td>Ø 2.1 mm</td> <td rowspan="2">0.5 mm<sup>2</sup></td> <td rowspan="2">Au</td> <td rowspan="2"> <table border="0"> <tr> <td>21</td> <td>22</td> <td>23</td> <td>24</td> <td>25</td> </tr> <tr> <td>27</td> <td>29</td> <td></td> <td></td> <td></td> </tr> </table> </td> </tr> <tr> <td>SIL</td> <td></td> <td>Ø 2.3 mm</td> <td></td> <td></td> </tr> </table>	PVC	TPE	Ø 2.1 mm	0.5 mm <sup>2</sup>	Au	<table border="0"> <tr> <td>21</td> <td>22</td> <td>23</td> <td>24</td> <td>25</td> </tr> <tr> <td>27</td> <td>29</td> <td></td> <td></td> <td></td> </tr> </table>	21	22	23	24	25	27	29				SIL		Ø 2.3 mm				
PVC	TPE	Ø 2.1 mm	0.5 mm <sup>2</sup>	Au	<table border="0"> <tr> <td>21</td> <td>22</td> <td>23</td> <td>24</td> <td>25</td> </tr> <tr> <td>27</td> <td>29</td> <td></td> <td></td> <td></td> </tr> </table>	21				22	23	24	25	27	29											
21	22	23				24	25																			
27	29																									
SIL		Ø 2.3 mm																								

### Component parts

22.2020-*	KT2-F	Insulator
22.1006	LS2-F	Plug