

# Product Sheet



**Part Number:**      **APS 14**



<b>Family</b>	AC boxes for control devices and signals
<b>Series</b>	AP containing boxes complete with cover
<b>Product type</b>	complete boxes external dimensions 168x192x80
<b>Execution</b>	APS unpainted containing boxes
<b>IP degree of protection</b>	IP66/IP67 (EN 60529) degree of protection

Part No.	R	S	T
AP.. 9	86	80	6
AP.. 11	100	120	6
AP.. 12	125	144	6,5
AP.. 14	149	168	6,5
AP.. 19	196	226	9
AP.. 20	236	275	9
AP.. 21	283	367	9

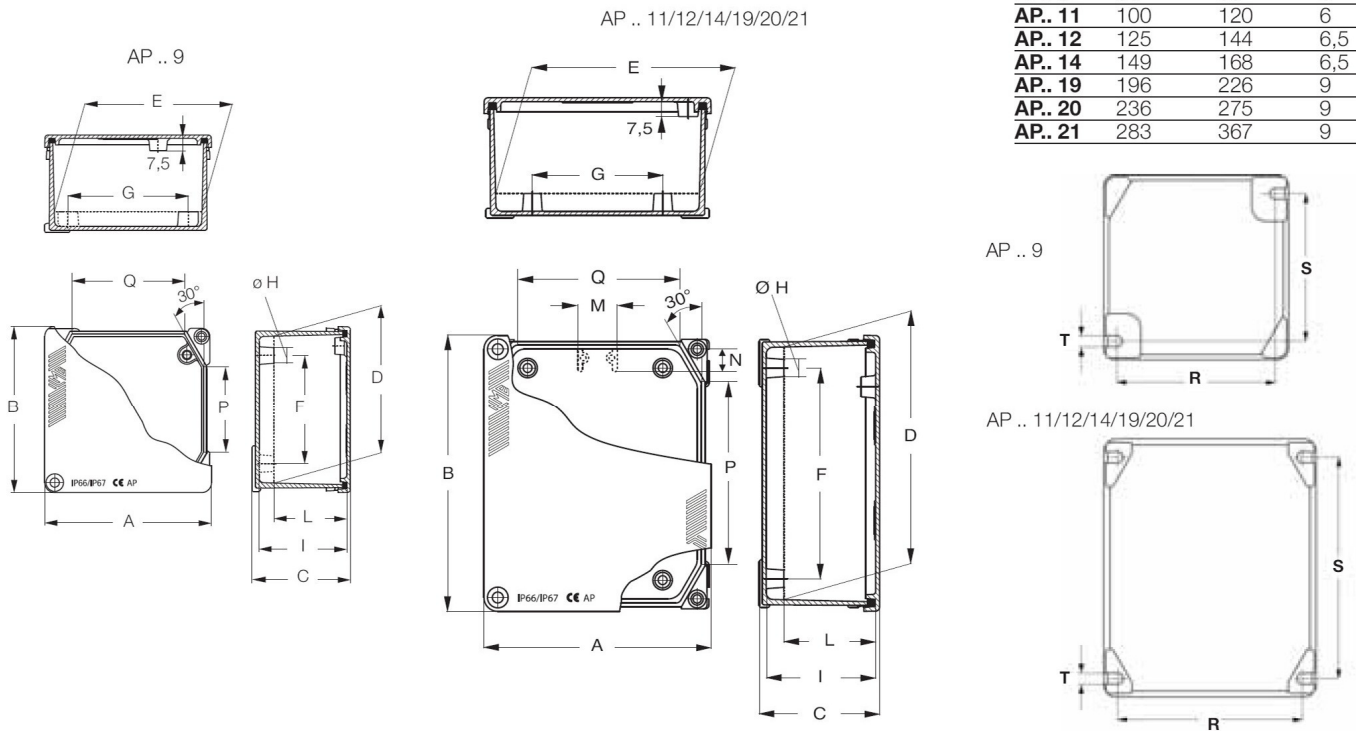

Part No.	A	B	C	D (*)	E (*)	F	G	øH	I	L	M	N	P	Q
AP.. 9	100	100	59	88	88	66	70,5	10	53	44	-	-	48	65
AP.. 11	115	140	61	128	103	107	66	10	55	46	-	-	90	81
AP.. 12	141	166	64	153	128	121	99	12,5	58	49	-	-	104	100
AP.. 14	168	192	80	176	152	153	113	10	74	65	-	-	128	125
AP.. 19	217	253	93	236	201	188	153	12,5	85	75	38	21	169	162
AP.. 20	264	314	122	292	243	238	198	12,5	114	104	49	24	203	192
AP.. 21	315	410	150	386	291	333	248	12,5	141	126	61	31	295	240

The dimensions shown are not binding and may be changed without notice.

Dimension in mm.