

SKINTOP® MS-HF-M

SKINTOP® MS-M, brass cable gland for cable diameters up to 98mm, in areas where mechanical and chemical stability are critical

Info

Cable gland for railway applications

Hazard Level: HL 3

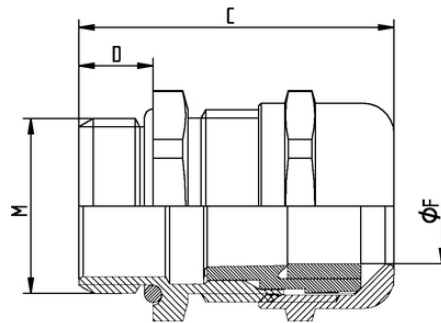

Reliability



Halogen-free



Rail



Flame-retardant

Benefits

Halogen-free and flame-retardant

Optimum strain relief

Wide, variable clamping ranges

Maximum reliability

Application range

Underground railways and trains

In areas where mechanical and chemical stability are critical

When the protection of people and property is a priority.

SKINTOP® MS-HF-M

Norm references / Approvals

DIN EN 45545-2

DIN EN 45545-3: 2013-08

DIN EN 1363-1: 2012-10

DIN EN 13501-2: Klassifizierung E30

Product Make-up

Metric connection thread acc. to DIN EN 60423

Basis for technical information DIN IEC 62444

Note

Refer to SKINTOP® metric accessories for suitable accessories

Technical Data

Classification ETIM 5:

ETIM 5.0 Class-ID: EC000441

ETIM 5.0 Class-Description: Cable screw gland

Classification ETIM 6:

ETIM 6.0 Class-ID: EC000441

ETIM 6.0 Class-Description: Cable screw gland

Caution:

Refer to Appendix T21 for the installation dimensions and torques

Material:

Body: nickel-plated brass

Insert: halogenfree polyamide acc. to UL 94 V0

Sealing: special elastomere

O-ring: special elastomere

Protection rating:

IP 68 - 5 bar

Temperature range:

dynamic -25°C up to + 100°C

Fixed: -40°C to +100°C

Note

Photographs and graphics are not to scale and do not represent detailed images of the respective products.

Prices are net prices without VAT and surcharges. Sale to business customers only.

**SKINTOP® MS-HF-M**

Article number	Article designation / size	Clamping range ØF (mm)	SW wrench size mm	Overall length, C (mm)	Thread length, D (mm)
53112570	M 12 x 1,5	3.5 - 7	16	26.5	6.5
53112571	M 16 x 1,5	4.5 - 10	20	33	7
53112572	M 20 x 1,5	7 - 13	24	37	8
53112573	M 25 x 1,5	9 - 17	29	38.5	8
53112574	M 32 x 1,5	11 - 21	36	45.5	9
53112575	M 40 x 1,5	19 - 28	45	48	9
53112576	M 50 x 1,5	27 - 35	54	55.5	10
53112577	M 63 x 1,5	34 - 45	67	67	15

Last Update (22.01.2018)

©2018 Lapp Group - Technical changes reserved

Product Management www.lappkabel.de

You can find the current technical data in the corresponding data sheet.
PN 0456 / 02_03.16