

EAO – Your Expert Partner for Human Machine Interfaces

61-3440.4/1 - Stop switch actuator

61-3440.4/1 - Stop switch actuator

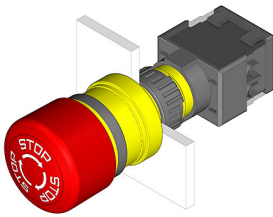

Attention: The preview is based on a sample product. This can differ from your current configuration.

Mounting

Mounting cut-out Ø 16 mm
Design raised

Front

Front shape round
Front dimension Ø 27 mm

Other Attributes

Marking Arrows
Weight 0,02 kg

Operating-/Indication part

Lens material Plastic
Lens colour red
Lens profile Mushroom
Lens illumination non-illuminative
Lens optics opaque

IP-Rating

Front protection IP65

Actuator

Switching action Maintained
Housing colour yellow
Housing material Plastic

Switching element

max. number of switching elements 1

Function

Emergency stop switch

EAO – Your Expert Partner for Human Machine Interfaces

61-3440.4/1 - Stop switch actuator

Dimensions

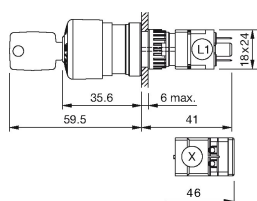

L1 = Solder/Plug-in terminal 2.8 x 0.5 mm

Mounting cut-outs

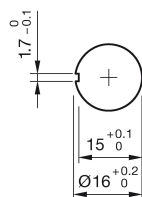

Wiring diagram

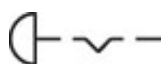

Additional information

Twist to unlock clockwise
Position indication ring black

Legend

Switching action: C = Maintained