

# HARTING



## Han-Kit® Complete Connector Sets

Industrial Connectors for Applications  
up to 500 V / 16 A

Economical and Reliable Connections - 1 Kit per Package - Easy Choice for You!

**Specifications**

VDE 0110 Table for clearance and creepage distances  
 DIN EN 61 984  
 VDE 0627 Connectors  
 Safety requirements and Tests

**Standards**

DIN EN 175 301-801

**Approvals**

UL, CSA, SEV for inserts



Certified accd. to EN ISO 9001  
 in design/ development, production,  
 installation and service.

**General Remarks:**

It is the user's responsibility to check whether the componenets belonging to these kits comply with different regulations from those stated in special fields of application which we are unable to foresee.  
 We reserve the right to modify designs in order to improve quality and keep pace with technological requirements in production.  
 No part of this information leaflet must be reproduced in any form (print, photocopy, microfilm or any other process) processed, duplicated or distributed by means of electronic systems without the written permission of HARTING ELectric GmbH & Co. KG, Espelkamp (Copyright Law, Fair Trading Law, Civil Code).  
 We are bound by the German version only.

**Note**

**Connectors should not be coupled or decoupled under electrical load.**  
**Connectors of the same or different series being mounted side by side may be protected against incorrect mating by the use of coding options.**

**Han® 3 A**

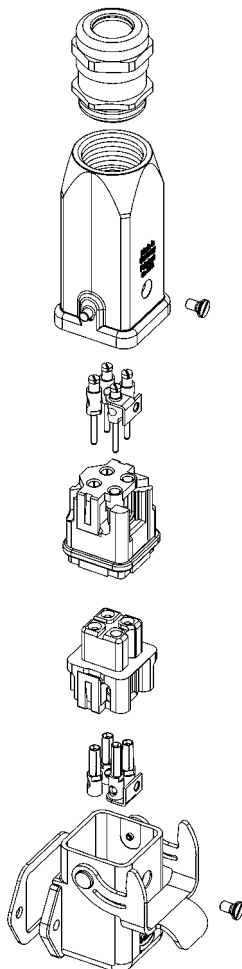

**Connector Set Up**

Cable Gland

Hood

Male contacts

Male insert

Female insert

Female contacts

Bulkhead mounted housing

**Han® 10 B**

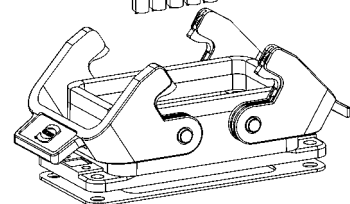
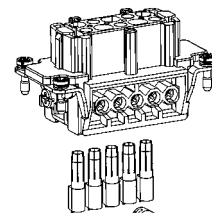
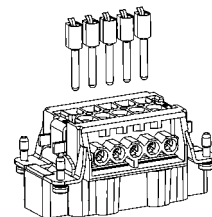
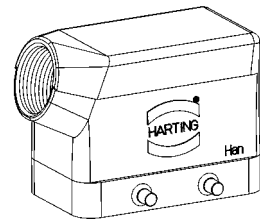
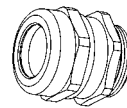

## Screw Terminal

Inserts	Stripping length a (mm)	Sheath length x (mm)
Han 3A ... + 4A...	4.5	40
Han 10 A	7	85
Han 16 A	7	100
Han 6 E	7	70
Han 10 E	7	90
Han 16 E	7	110
Han 24 E	7	130

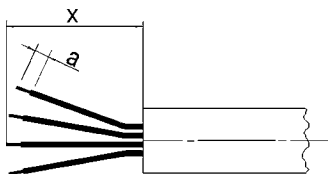

Recommended Tightening Torques and Screw Driver Blades				
Size of screw	Type of connector	Tightening torque [Nm]	Tightening torque [lbft]	Recomm. screw driver blade [mm]
M3	Screw terminal Han 3A.../4A...	0.25	0.4	0.5 x 2.5
M3	Screw terminal Han 10A + 16A Han 6B - 24 B	0.5	0.4	0.5 x 3.5
M3.5	PE contact Han 10A + 16A	1.2	0.9	0.5 x 3.5
M4	PE contact Han 6B - 24 B	1.2	0.9	0.5 x 3.5

## Derating Diagrammes



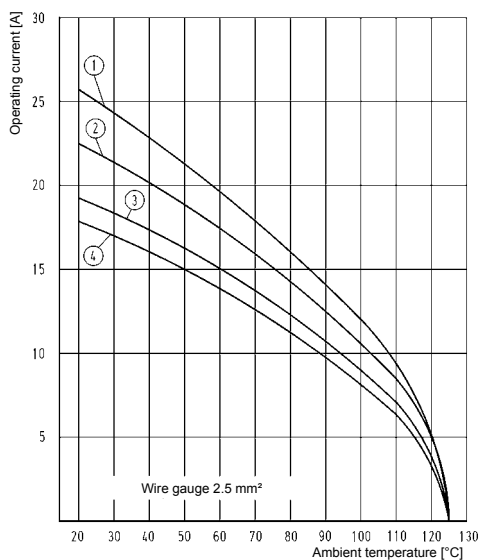

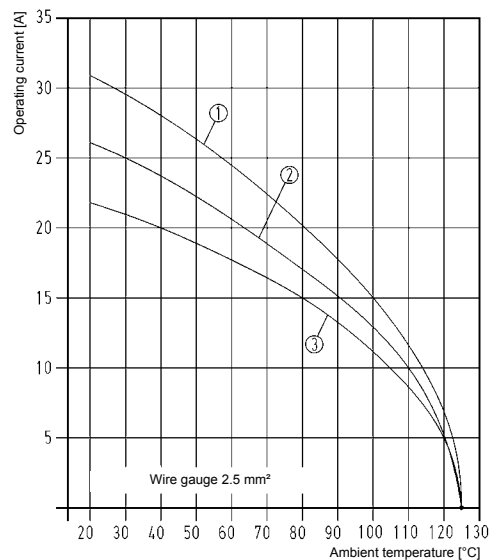

The current carrying capacity is limited by the thermal properties of materials which are used for inserts as well as by the insulation materials. The rated current is the continuous, not interrupted current a connector can take when simultaneous power on all contacts is given, without exceeding the maximum temperature according to DIN IEC 60 512-3.

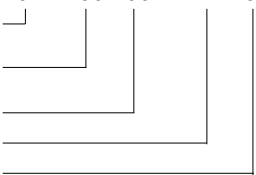

- 1 = Han 6 E
- 2 = Han 10 E
- 3 = Han 16 E
- 4 = Han 24 E

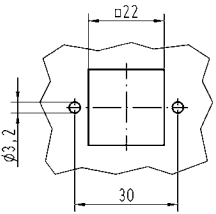
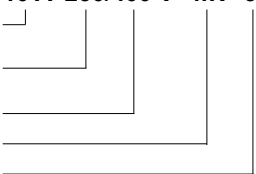

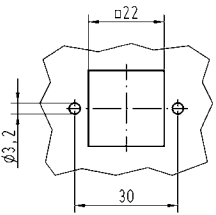
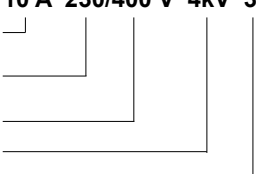
- 1 = Han 3 A / 4 A
- 2 = Han 10 A
- 3 = Han 16 A

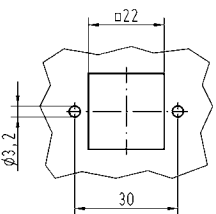
Han® 3 A Metal Version	Part-Number	Dimensions in mm
<p><b>Han-Kit®-3AGM</b></p> <p>Hood Han® 3 A straight                      Bulkhead mounted hous.<sup>1)</sup> Han® 3 A straight                      Material Die cast zinc alloy                      Protection degree<sup>2)</sup> IP 67                      Cable gland M20, metal                      Cable diameter 5 - 9 mm / 6 - 12 mm                      Insert Han® 3 A, 3-pins + PE                      Screw terminal 1-2.5 mm<sup>2</sup>, AWG 18-14                      Electrical data accd. to DIN EN 61 984<sup>3)</sup>  <b>10 A 230/400 V 4kV 3</b></p>  <p>Rated current                      Rated voltage conductor-ground                      Rated voltage conductor-conductor                      Rated impulse voltage                      Pollution degree                      Rated voltage accd. to UL/CSA 600 V</p>	<p>10 20 003 0001</p>	 <p>Assembly cut out bulkhead mounted housing 22 x 22 mm</p> 
<p><b>Han-Kit®-3AWM</b></p> <p>Hood Han® 3 A straight                      Bulkhead mounted hous.<sup>1)</sup> Han® 3 A angled                      Material Die cast zinc alloy                      Protection degree<sup>2)</sup> IP 67                      Cable gland M20, metal                      Cable diameter 5 - 9 mm / 6 - 12 mm                      Insert Han® 3 A, 3-pins + PE                      Screw terminal 1-2.5 mm<sup>2</sup>, AWG 18-14                      Electrical data accd. to DIN EN 61 984<sup>3)</sup>  <b>10 A 230/400 V 4kV 3</b></p>  <p>Rated current                      Rated voltage conductor-ground                      Rated voltage conductor-conductor                      Rated impulse voltage                      Pollution degree                      Rated voltage accd. to UL/CSA 600 V</p>	<p>10 20 003 0003</p>	 <p>Assembly cut out bulkhead mounted housing 22 x 22 mm</p> 
<p><b>Han-Kit®-3AWSM</b></p> <p>Hood Han® 3 A angled                      Bulkhead mounted hous.<sup>1)</sup> Han® 3 A straight                      Material Die cast zinc alloy                      Protection degree<sup>2)</sup> IP 67                      Cable gland M20, metal                      Cable diameter 5 - 9 mm / 6 - 12 mm                      Insert Han® 3 A, 3-pins + PE                      Screw terminal 1-2.5 mm<sup>2</sup>, AWG 18-14                      Electrical data accd. to DIN EN 61 984<sup>3)</sup>  <b>10 A 230/400 V 4kV 3</b></p>  <p>Rated current                      Rated voltage conductor-ground                      Rated voltage conductor-conductor                      Rated impulse voltage                      Pollution degree                      Rated voltage accd. to UL/CSA 600 V</p>	<p>10 20 003 0005</p> <p>1) Bulkhead mounted housing with flange gasket                      2) Protection degree accd. to DIN EN 60 529 in locked position                      3) For only use in grounded circuits</p>	 <p>Assembly cut out bulkhead mounted housing 22 x 22 mm</p> 

**Han® 3 A** Plastic Version

Part-Number

Dimensions in mm

**Han-Kit®-3AGK**

Hood Han® 3 A straight  
 Bulkhead mounted hous.<sup>1)</sup> Han® 3 A straight  
 Material Plastic  
 Protection degree<sup>2)</sup> IP 67  
 Cable gland M20, plastic  
 Cable diameter 5 - 9 mm / 6 - 12 mm  
 Insert Han® 3 A, 3-pins + PE  
 Screw terminal 1-2.5 mm<sup>2</sup>, AWG 18-14

10 20 003 0002

Electrical data accd. to DIN EN 61 984<sup>3)</sup>  
**10 A 230/400 V 4kV 3**

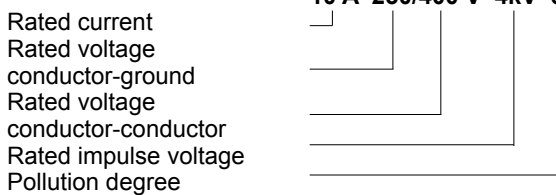

Rated voltage accd. to UL/CSA 600 V



Assembly cut out bulkhead mounted housing 22 x 22 mm

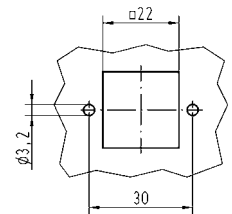

**Han-Kit®-3AWK**

Hood Han® 3 A straight  
 Bulkhead mounted hous.<sup>1)</sup> Han® 3 A angled  
 Material Plastic  
 Protection degree<sup>2)</sup> IP 67  
 Cable gland M20, plastic  
 Cable diameter 5 - 9 mm / 6 - 12 mm  
 Insert Han® 3 A, 3-pins + PE  
 Screw terminal 1-2.5 mm<sup>2</sup>, AWG 18-14

10 20 003 0004

Electrical data accd. to DIN EN 61 984<sup>3)</sup>  
**10 A 230/400 V 4kV 3**

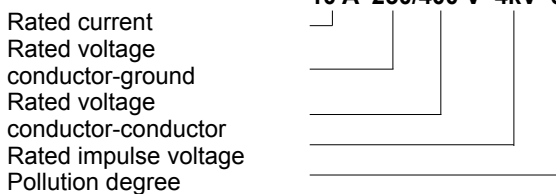





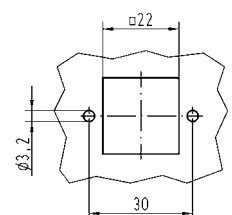

Rated voltage accd. to UL/CSA 600 V

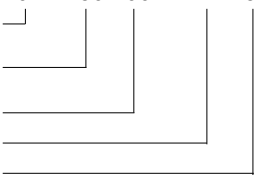

Assembly cut out bulkhead mounted housing 22 x 22 mm

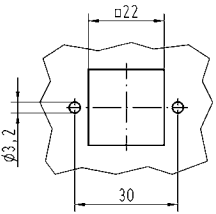
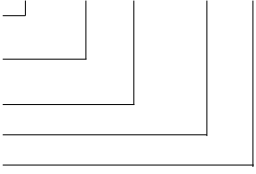

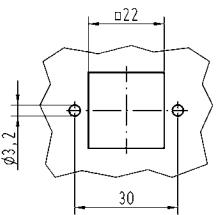
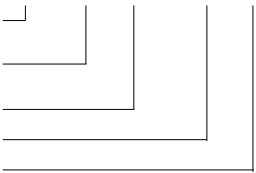
- 1) Bulkhead mounted housing with flange gasket
- 2) Protection degree accd. to DIN EN 60 529 in locked position
- 3) For only use in grounded circuits

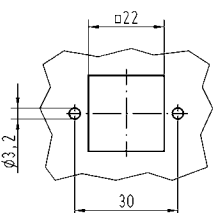
Han® 4 A Metal Version	Part-Number	Dimensions in mm
<p><b>Han-Kit®-4AGM</b></p> <p>Hood Han® 3 A straight                      Bulkhead mounted hous.<sup>1)</sup> Han® 3 A straight                      Material Die cast zinc alloy                      Protection degree<sup>2)</sup> IP 67                      Cable gland M20, metal                      Cable diameter 5 - 9 mm / 6 - 12 mm                      Insert Han® 4 A, 4-pins + PE                      Screw terminal 1-2.5 mm<sup>2</sup>, AWG 18-14                      Electrical data accd. to DIN EN 61 984<sup>3)</sup>  <b>10 A 230/400 V 4kV 3</b></p>  <p>Rated current                      Rated voltage conductor-ground                      Rated voltage conductor-conductor                      Rated impulse voltage                      Pollution degree                      Rated voltage accd. to UL/CSA 600 V</p>	<p>10 20 004 0001</p>	 <p>Assembly cut out bulkhead mounted housing 22 x 22 mm</p> 
<p><b>Han-Kit®-4AWM</b></p> <p>Hood Han® 3 A straight                      Bulkhead mounted hous.<sup>1)</sup> Han® 3 A angled                      Material Die cast zinc alloy                      Protection degree<sup>2)</sup> IP 67                      Cable gland M20, metal                      Cable diameter 5 - 9 mm / 6 - 12 mm                      Insert Han® 4 A, 4-pins + PE                      Screw terminal 1-2.5 mm<sup>2</sup>, AWG 18-14                      Electrical data accd. to DIN EN 61 984<sup>3)</sup>  <b>10 A 230/400 V 4kV 3</b></p>  <p>Rated current                      Rated voltage conductor-ground                      Rated voltage conductor-conductor                      Rated impulse voltage                      Pollution degree                      Rated voltage accd. to UL/CSA 600 V</p>	<p>10 20 004 0003</p>	 <p>Assembly cut out bulkhead mounted housing 22 x 22 mm</p> 
<p><b>Han-Kit®-4AWSM</b></p> <p>Hood Han® 3 A angled                      Bulkhead mounted hous.<sup>1)</sup> Han® 3 A straight                      Material Die cast zinc alloy                      Protection degree<sup>2)</sup> IP 67                      Cable gland M20, metal                      Cable diameter 5 - 9 mm / 6 - 12 mm                      Insert Han® 4 A, 4-pins + PE                      Screw terminal 1-2.5 mm<sup>2</sup>, AWG 18-14                      Electrical data accd. to DIN EN 61 984<sup>3)</sup>  <b>10 A 230/400 V 4kV 3</b></p>  <p>Rated current                      Rated voltage conductor-ground                      Rated voltage conductor-conductor                      Rated impulse voltage                      Pollution degree                      Rated voltage accd. to UL/CSA 600 V</p>	<p>10 20 004 0005</p> <p>1) Bulkhead mounted housing with flange gasket                      2) Protection degree accd. to DIN EN 60 529 in locked position                      3) For only use in grounded circuits</p>	 <p>Assembly cut out bulkhead mounted housing 22 x 22 mm</p> 

**Han® 4 A** Plastic Version

Part-Number

Dimensions in mm

**Han-Kit®-4AGK**

Hood	Han® 3 A straight
Bulkhead mounted hous. <sup>1)</sup>	Han® 3 A straight
Material	Plastic
Protection degree <sup>2)</sup>	IP 67
Cable gland	M20, plastic
Cable diameter	5 - 9 mm / 6 - 12 mm
Insert	Han® 4 A, 4-pins + PE
Screw terminal	1-2.5 mm <sup>2</sup> , AWG 18-14
Electrical data accd. to DIN EN 61 984 <sup>3)</sup>	<b>10 A 230/400 V 4kV 3</b>
Rated current	
Rated voltage conductor-ground	
Rated voltage conductor-conductor	
Rated impulse voltage	
Pollution degree	
Rated voltage accd. to UL/CSA	600 V

10 20 004 0002



Assembly cut out bulkhead mounted housing 22 x 22 mm

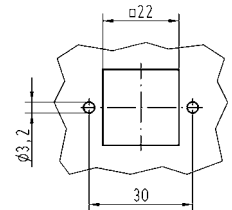

**Han-Kit®-4AWK**

Hood	Han® 3 A straight
Bulkhead mounted hous. <sup>1)</sup>	Han® 3 A angled
Material	Plastic
Protection degree <sup>2)</sup>	IP 67
Cable gland	M20, plastic
Cable diameter	5 - 9 mm / 6 - 12 mm
Insert	Han® 4 A, 4-pins + PE
Screw terminal	1-2.5 mm <sup>2</sup> , AWG 18-14
Electrical data accd. to DIN EN 61 984 <sup>3)</sup>	<b>10 A 230/400 V 4kV 3</b>
Rated current	
Rated voltage conductor-ground	
Rated voltage conductor-conductor	
Rated impulse voltage	
Pollution degree	
Rated voltage accd. to UL/CSA	600 V

10 20 004 0004



Assembly cut out bulkhead mounted housing 22 x 22 mm

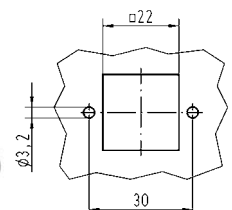

- 1) Bulkhead mounted housing with flange gasket
- 2) Protection degree accd. to DIN EN 60 529 in locked position
- 3) For only use in grounded circuits



Han® 10 A

Part-Number

Dimensions in mm

**Han-Kit®-10A**

Hood<sup>1)</sup> Han® 10 A  
 Material Die cast aluminium alloy  
 Protection degree<sup>2)</sup> IP 65  
 Cable gland M20, metal  
 Cable diameter 5 - 9 mm / 6 - 12 mm

Insert Han® 10 A, 10-pins + PE  
 Screw terminal 1-2.5 mm<sup>2</sup>, AWG 18-14

Electrical data accd. to DIN EN 61 984<sup>3)</sup>  
**16 A 250 V 4kV 3**

Rated current  
 Rated voltage<sup>3)</sup>  
 Rated impulse voltage  
 Pollution degree

Rated voltage  
 accd. to UL/CSA 600 V

10 20 010 0000



Assembly cut out  
 bulkhead mounted  
 housing  
 57 x 24 mm

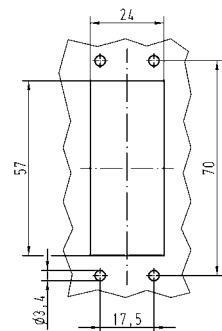

Han® 16 A

Part-Number

Dimensions in mm

**Han-Kit®-16A**

Hood<sup>1)</sup> Han® 16 A  
 Material Die cast aluminium alloy  
 Protection degree<sup>2)</sup> IP 65  
 Cable gland M20, metal  
 Cable diameter 5 - 9 mm / 6 - 12 mm

Insert Han® 16 A, 16-pins + PE  
 Screw terminal 1-2.5 mm<sup>2</sup>, AWG 18-14

Electrical data accd. to DIN EN 61 984<sup>3)</sup>  
**16 A 250 V 4kV 3**

Rated current  
 Rated voltage<sup>3)</sup>  
 Rated impulse voltage  
 Pollution degree

Rated voltage  
 accd. to UL/CSA 600 V

10 20 016 0000



Assembly cut out  
 bulkhead mounted  
 housing  
 73 x 24 mm

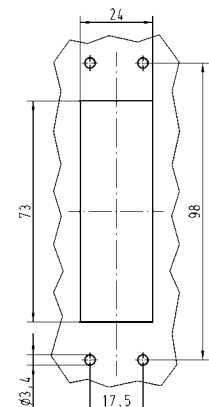

1) Bulkhead mounted housing with flange gasket  
 2) Protection degree accd. to DIN EN 60 529 in locked position  
 3) For use in a un-grounded circuit or a grounded delta circuit



Han® 6 B

Part-Number

Dimensions in mm

**Han-Kit®-6B**

Hood<sup>1)</sup> Han® 6 B  
 Material Die cast aluminium alloy  
 Protection degree<sup>2)</sup> IP 65  
 Cable gland M20, metal  
 Cable diameter 5 - 9 mm / 6 - 12 mm

Insert Han® 6 E, 6-pins + PE  
 Screw terminal 1-2.5 mm<sup>2</sup>, AWG 18-14

Electrical data accd. to DIN EN 61 984<sup>3)</sup>

**16 A 500 V 6kV 3**

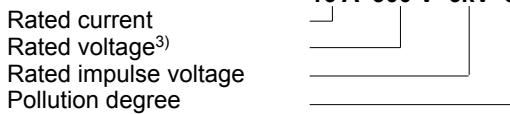

Rated voltage accd. to UL/CSA 600 V

10 33 006 0000



Dimensions in mm	Han-Kit 6 B
a	48
b	70
Assembly cut out bulkhead mounted housing	48x35

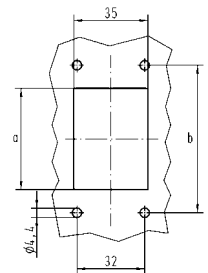

Han® 10 B

Part-Number

Dimensions in mm

**Han-Kit®-10B**

Hood<sup>1)</sup> Han® 10 B  
 Material Die cast aluminium alloy  
 Protection degree<sup>2)</sup> IP 65  
 Cable gland M25, metal  
 Cable diameter 9 - 16 mm / 13 - 18 mm

Insert Han® 10 E, 10-pins + PE  
 Screw terminal 1-2.5 mm<sup>2</sup>, AWG 18-14

Electrical data accd. to DIN EN 61 984<sup>3)</sup>

**16 A 500 V 6kV 3**

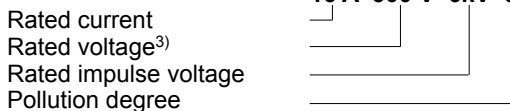

Rated voltage accd. to UL/CSA 600 V

10 33 010 0000



Dimensions in mm	Han-Kit 10 B
a	60
b	83
Assembly cut out bulkhead mounted housing	60 x 35

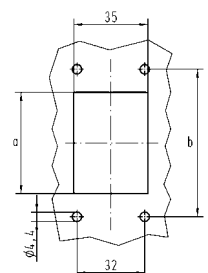

1) Bulkhead mounted housing with flange gasket  
 2) Protection degree accd. to DIN EN 60 529 in locked position  
 3) For use in a un-grounded circuit or a grounded delta circuit

## Han® 16 B

Part-Number

Dimensions in mm

### Han-Kit®-16B

Hood<sup>1)</sup> Han® 16 B  
 Material Die cast aluminium alloy  
 Protection degree<sup>2)</sup> IP 65  
 Cable gland M32, metal  
 Cable diameter 13-20 mm / 18-25 mm

Insert Han® 16 E, 16-pins + PE  
 Screw terminal 1-2.5 mm<sup>2</sup>, AWG 18-14

Electrical data accd. to DIN EN 61 984<sup>3)</sup>

**16 A 500 V 6kV 3**

Rated current  
 Rated voltage<sup>3)</sup>  
 Rated impulse voltage  
 Pollution degree

Rated voltage  
 accd. to UL/CSA 600 V

10 33 016 0000



Dimensions in mm	Han-Kit 16 B
a	82
b	103
Assembly cut out bulkhead mounted housing	82 x 35

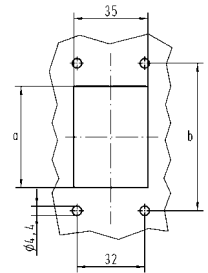

## Han® 24 B

Part-Number

Dimensions in mm

### Han-Kit®-24B

Hood<sup>1)</sup> Han® 24 B  
 Material Die cast aluminium alloy  
 Protection degree<sup>2)</sup> IP 65  
 Cable gland M32, metal  
 Cable diameter 13-20 mm / 18-25 mm

Insert Han® 24 E, 24-pins + PE  
 Screw terminal 1-2.5 mm<sup>2</sup>, AWG 18-14

Electrical data accd. to DIN EN 61 984<sup>3)</sup>

**16 A 500 V 6kV 3**

Rated current  
 Rated voltage<sup>3)</sup>  
 Rated impulse voltage  
 Pollution degree

Rated voltage  
 accd. to UL/CSA 600 V

10 33 024 0000



Dimensions in mm	Han-Kit 24 B
a	108
b	130
Assembly cut out bulkhead mounted housing	108x35

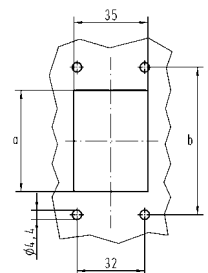

1) Bulkhead mounted housing with flange gasket  
 2) Protection degree accd. to DIN EN 60 529 in locked position  
 3) For use in a un-grounded circuit or a grounded delta circuit

Product Range



Industrial Connectors Han®



Network components for industrial communication

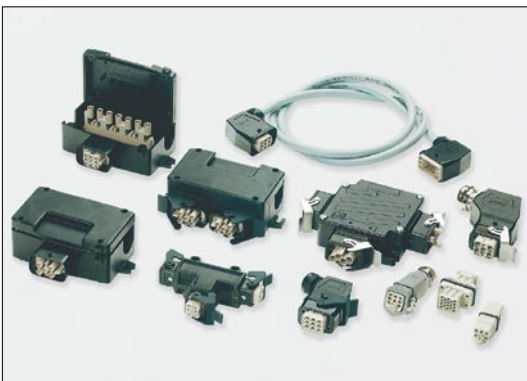

Components for energy distribution Han-Power® and Han-Compact®



Circular Connectors HARAX® and overmoulded variants for automation



Fiber optic data link systems and components



Components for cabinets and boxes Han-Snap® and Han-Port®

## Subsidiary companies – worldwide



## Sales partner – worldwide



**Austria:** HARTING Ges. m. b. H.  
Deutschstraße 19, A-1230 Wien  
Phone +431/6162121, Fax +431/6162121-21  
E-Mail: at@HARTING.com

**Belgium:** HARTING N.V./S.A.  
Z.3 Doornveld 23, B-1731 Zellik  
Phone +322/4660190, Fax +322/4667855  
E-Mail: be@HARTING.com

**Brazil:** HARTING Ltda.  
Av. Dr. Lino de Moraes, Pq. Jabaquara, 255  
CEP 04360-001 - São Paulo - SP - Brazil  
Phone +5511/5035-0073, Fax +5511/5034-4743  
E-Mail: br@HARTING.com, Internet: www.HARTING.com.br

**China:** Zhuhai HARTING, Limited Shanghai Branch  
Room 5403, 300 Huaihai Zhong Road  
Hong Kong New World Tower, Luwan District, P.R.C  
Shanghai 200021, China  
Phone +86 21 - 63 86 22 00, Fax +86 21 - 63 86 86 36  
E-Mail: cn@HARTING.com

**Czech Republic:** HARTING spol. s.r.o.,  
Mlýnská 2, 16000 Praha 6  
Phone +420 220 380 460, Fax +420 220 380 461  
E-Mail: cz@HARTING.com, Internet: www.HARTING.cz

**Eastern-Europe:** HARTING Eastern Europe GmbH  
Bamberger Straße 7, D-01187 Dresden  
Phone +49 351 / 4361760, Fax +49 351 / 4361770  
E-Mail: Eastern.Europe@HARTING.com

**Finland:** HARTING Oy  
Hakamäenkuja 11 A, FIN-01510 Vantaa  
Phone +358 9 350 873 00, Fax +358 9 350 873 20  
E-Mail: fi@HARTING.com

**France:** HARTING France  
181 avenue des Nations, Paris Nord 2  
BP 66058 Tremblay en France  
F-95972 Roissy Charles de Gaulle Cédex  
Phone +33149383400, Fax +33148632306  
E-Mail: fr@HARTING.com

**Germany:** HARTING Deutschland GmbH & Co. KG  
Postfach 2451 · D-32381 Minden  
Simeons carré 1 · D-32427 Minden  
Phone (0571) 8896-0, Fax (0571) 8896-282  
E-Mail: de@HARTING.com, Internet: www.HARTING.com

**Office Germany:** HARTING Deutschland GmbH & Co. KG  
Blankenauer Straße 99, D-09113 Chemnitz  
Phone +49 0371 429211, Fax +49 0371 429222  
E-Mail: de@HARTING.com

**Great Britain:** HARTING Ltd.  
Caswell Road, Brackmills Industrial Estate  
GB-Northampton, NN4 7PW  
Phone +441604/766686, 827500, Fax +441604/706777,  
E-Mail: gb@HARTING.com, Internet: www.HARTING.co.uk

**Hong Kong:** HARTING (HK) Ltd.  
Regional Office Asia Pacific  
4208 Metroplaza Tower 1, 223 Hing Fong Road  
Kwai Fong, N. T., Hong Kong  
Phone +852/2423-7338, Fax +852/2480-4378  
E-Mail: ap@HARTING.com  
Internet: www.HARTING.com.hk

**Hungary:** HARTING Magyarország Kft.  
Fehérvári út 89-95, H1119 Budapest  
Phone +36-1-205 3464, Fax +36-1-205 3465  
E-Mail: hu@HARTING.com, Internet: www.HARTING.hu

**India:** HARTING India Private Limited  
No. D, 4th Floor, 'Doshi Towers'  
No. 156 Poonamallee High Rd,  
Kilpauk, Chennai 600 010, Tamil Nadu, Chennai, INDIA  
Phone +91-44-4356 0415/6, Fax +91-44-4356 0417  
E-Mail: in@HARTING.com, Internet: www.HARTING.com

**Italy:** HARTING SpA  
Via Dell' Industria 7, I-20090 Vimodrone (Milano)  
Phone +3902/250801, Fax +3902/2650597  
E-Mail: it@HARTING.com

**Japan:** HARTING K. K.  
Yusen Shin-Yokohama 1 Chome Bldg., 2F  
1-7-9, Shin-Yokohama  
Kohoku-ku, Yokohama, 222-0033 Japan  
Phone +81 45 476 3456, Fax +81 45 476 3466  
E-Mail: jp@HARTING.com, Internet: www.HARTING.co.jp

**Korea:** HARTING Korea Limited  
#308 Leaders Bldg., 342-1, Yatap-dong, Bundang-gu,  
Sungnam-City, Kyunggi-do, 463-828, Korea  
Phone +82-31-781-4615, Fax +82-31-781-4616  
E-Mail: kr@HARTING.com

**Netherlands:** HARTING B.V.  
Larenweg 44, NL-5234 KA 's-Hertogenbosch  
Phone +3173/6410404, Fax +3173/6440699  
E-Mail: nl@HARTING.com

**Norway:** HARTING A/S,  
Østensjøveien 36, N-0667 Oslo,  
Phone +4722/700555, Fax +4722/700570  
E-Mail: no@HARTING.com

**Poland:** HARTING Polska Sp. z o.o.  
ul. Kamieńskiego 201-219, 51-126 Wrocław  
Phone +48 71-352 81 71/74, Fax +48 71-320 74 44  
E-Mail: pl@HARTING.com, Internet: www.HARTING.pl

**Portugal:** HARTING Iberia, S. A.  
Avda. Josep Tarradellas, 20-30, 4º 6º, E-08029 Barcelona  
Phone +351.219.673.177, Fax +351.219.678.457  
E-Mail: es@HARTING.com

**Russia:** HARTING ZAO  
ul. Tobolskaja 12, Saint Petersburg, 194044 Russia  
Phone +7812/3276477, Fax +7812/3276478  
E-Mail: ru@HARTING.com, Internet: www.HARTING.ru

**Singapore:** HARTING Singapore Pte Ltd.  
No. 1 Coleman Street, #B1-21 The Adelphi  
Singapore 179803  
Phone +6562255285, Fax +6562259947  
E-Mail: sg@HARTING.com

**Spain:** HARTING Iberia S.A.  
Josep Tarradellas 20-30 4º 6º, E-08029 Barcelona  
Phone +34 933 638 475, Fax +34 934 199 585  
E-Mail: es@HARTING.com

**Sweden:** HARTING AB  
Gustavslundsvägen 141 B 4tr, 167 51 Bromma  
Phone +468/4457171, Fax +468/4457170  
E-Mail: se@HARTING.com

**Switzerland:** HARTING AG  
Industriestrasse 26, CH-8604 Volketswil  
Phone +41 44 908 20 60, Fax +41 44 908 20 69  
E-Mail: ch@HARTING.com

**Taiwan:** HARTING R.O.C. Limited  
Rm 1, 5th Floor, No. 495, GuangFu-South-Rd,  
Taipei, 110 Taiwan  
Tel. +886-2-2758-6177, Fax +886-2-2758-7177  
E-Mail: tw@HARTING.com  
Internet: www.HARTING.com.tw

**USA:** HARTING Inc. of North America  
1370 Bowes Road, Elgin, Illinois 60123  
Phone +1 (877) 741-1500 (toll free)  
Fax +1 (866) 278-0307 (Inside Sales)  
Fax +1 (847) 717-9430 (Sales and Marketing)  
E-Mail: us@HARTING.com  
Internet: www.HARTING-USA.com

**Other countries:**  
Please contact your Global Business Unit

**Argentina:** Condel Electronica  
Julian Agüero 3355  
(1605) Munro - Pcia. de Buenos Aires  
Phone + Fax +54 11 4762.0118  
E-Mail: mediavicondel@arnet.com.ar

**Denmark:** Knud Wexøe A/S  
Skaettekaeret 11, P.O. Box 152  
Phone +359-2-9155800, Fax +359-2-9540384  
office@comet.bg; www.comet.bg

**Estland:** SKS Tehnika OÜ  
Liimi 1, EE-10621 Tallinn  
Tel. +372 699 0171, Fax +372 699 0170  
E-Mail: tehnika@sk.fi, Internet: www.sk.fi

**Finland:** SKS Automaatio OY  
Martinkyläntie 50, FIN-01720 Vantaa  
Phone +358 20 76461, Fax +35 20 7646820  
E-Mail: automaatio@sk.fi, Internet: www.sk.fi

**Island:** Smith & Norland  
Nóatún 4; IS-105 Reykjavík  
Phone +354 520 3000, Fax +354 520 3011  
olaf@sminor.is; www.sminor.is

**Israel:** MIGVAN Technologies & Engineering Ltd.  
13 Hashiloh St., P.O.Box 7022  
IL - Petach Tikva 49170  
Phone +972 3 9240784, Fax +972 3 9240787  
info@mte.co.il, www.mte.co.il

**South-Africa:** HellermannTyton Pty Ltd.  
Private Bag X158 Rivonia 2128  
34 Milky Way Avenue  
Linbro Business Park 2065  
Johannesburg, South Africa  
Phone +27 (0)11 879-6600  
Fax +27 (0)11 879-6606  
E-Mail: sales.jhb@hellermann.co.za

**Turkey:** Gökhan Elektrik San. Tic. Ltd. Sti.  
Perpa Elektrikçiler Is Merkezi A Blok  
Kat:7-8-9 No.694  
TR - 80270 Okmeydanı/Istanbul  
Phone +90 (212) 2 21 32 36 (pbx)  
Fax +90 (212) 2 21 32 40  
E-Mail: gokhan@gokhanelektrik.com

**Ukraine:** Incomtech Ltd.  
4 Lermontovskaya St., UA-04050 Kiev  
Phone +380-44-213-3641, Fax +380-44-213-3814  
E-Mail: eletech@incomtech.com.ua  
Internet: www.incomtech.com.ua

## Global Business Unit Electric



**HARTING Electric GmbH & Co. KG**  
P.O. Box 1473  
D-32328 Espelkamp  
Phone +49 57 72 / 47-97 100  
Fax +49 57 72 / 47-49 5  
E-Mail: electric@HARTING.com  
Internet: www.HARTING.com

## Your Contact Partner

