

DIMENSIONS mm (inches)

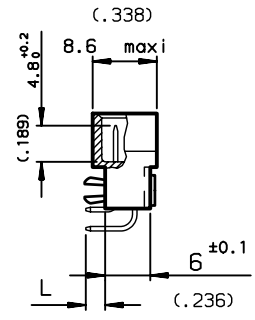
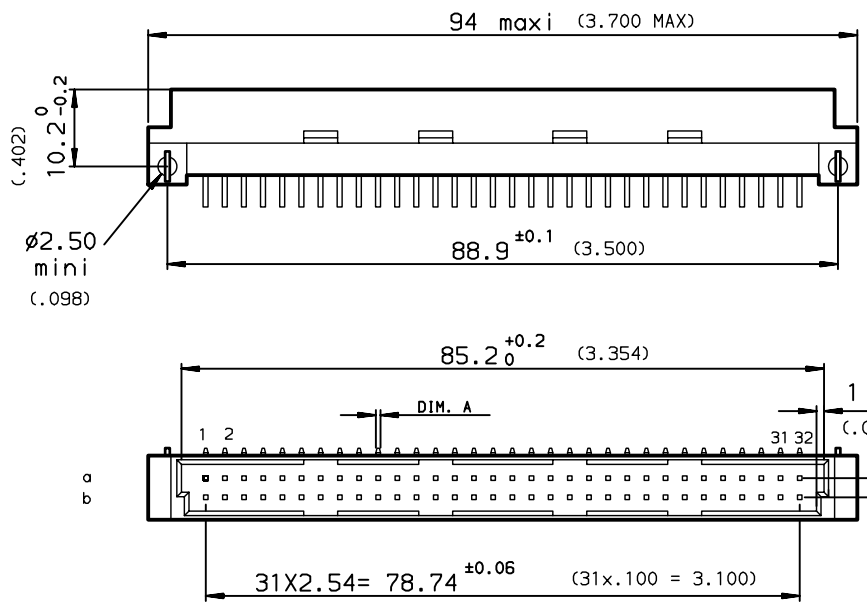

GENERAL CHARACTERISTICS AND ROHS INFORMATIONS:
SEE DRAWING C-8609-0000A

TIN LEAD	LEAD FREE	
8609 264 51 13 755 000 E1	8609 264 51 13 755 E1 LF	Style B header, 64 Position, solder to board, class 2
8609 264 51 13 765 000 E1	8609 264 51 13 765 E1 LF	Style B header, 64 Position, solder to board, class 1
8609 264 51 13 H55 000 E1	8609 264 51 13 H55 E1 LF	Style B header, 64 Position, solder to board, class 2, fixing clips
TIN LEAD	LEAD FREE	
8609 264 51 13 745 000 E1	8609 264 51 13 745 E1 LF	Style B header, 64 Position, solder to board, class 3
8609 264 51 13 H65 000 E1	8609 264 51 13 H65 E1 LF	Style B header, 64 Position, solder to board, class 1 fixing clips

Application specific part-numbers: See sheet 2

European Views

www.fciconnect.com		surface ISO 1302 ✓	tolerance std ISO 406 ISO 1101	projection A3	mm
TOLERANCES UNLESS OTHERWISE SPECIFIED					
ANGULAR	LINEAR	0.X	±0.1	size	Scale
0.XX' ±2'		0.XX	±0.1	A3	1.5
0.XXX		0.XXX	±0.1	ECN	LS07-0033
Product family		DIN 8609		Spec ref -	
RIGHT ANGLE HEADER - STYLE B SOLDER TO BOARD				dwg no	C-8609-0288-1
catalog no				CUSTOMER	sheet 1 of 2

rev	ecn no	dr	date
C	-	ROU	2002/08/30
D	LS05-001	JTA	2005/03/04
E	LS06-0097	LGO	2006/07/11
F	LS07-0033	HLG	2007/02/07
-	-	-	-
-	-	-	-
-	-	-	-

Copyright FCJ. FCJ

PART NUMBER	8609			51				5	
PIN OUT	rows a	-----	-----	-----	-----	-----	-----	-----	-----
	rows a-b	-----	-----	-----	-----	-----	-----	-----	-----
NUMBER OF CONTACTS		1	32					2	64
TERMINATION	L = 2.75 ±0.15 (.108)	A =	B = $\phi 0.8^{+0.3}_0$					13	
	L = 4.15 ±0.15 (.163)	A = 0.6X0.6	B = $\phi 1 \pm 0.1$					23	
OPTIONS	no option	-----	-----	-----	-----	-----	-----	7	
	with harpoons	-----	-----	-----	-----	-----	-----	H	
PERFORMANCE CLASS	DIN 41612 class 3	-----	-----	-----	-----	-----	-----	4	
	DIN 41612 class 2	-----	-----	-----	-----	-----	-----	5	
	DIN 41612 class 1	-----	-----	-----	-----	-----	-----	6	
TERMINATION TYPE	TIN LEAD	-----	-----	-----	-----	-----	-----	000E1	
	LEAD FREE	-----	-----	-----	-----	-----	-----	E1LF	

PCB DRILLING

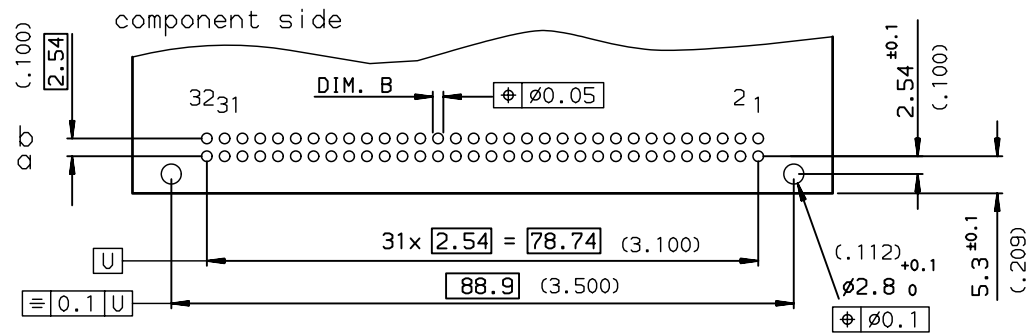

GENERAL CHARACTERISTICS AND ROHS INFORMATIONS:
SEE DRAWING C-8609-0000A

European Views

www.fciconnect.com		surface ISO 1302 <input checked="" type="checkbox"/>	tolerance std ISO 406 ISO 1101	projection 	mm
TOLERANCES UNLESS OTHERWISE SPECIFIED					
Dr	ROUILLARD	1997/07/07	ANGULAR	0.X	±0.1
Eng	TARON	1997/07/07	LINEAR	0.XX	±0.1
Chr	LEGARE	1997/07/07	0.XX' ±2'	0.XXX	±0.1
Appr	LEGARE	1997/07/07	Product family	DIN 8609	Spec ref -
title RIGHT ANGLE HEADER - STYLE B			dwg no C-8609-0288-2		Rev. F
SOLDER TO BOARD			CUSTOMER		sheet 2 of 2

rev	ecn no	dr	date
C	-	ROU	2002/08/30
D	LS05-001	JTA	2005/03/01
E	LS06-0097	LGO	2006/07/11
F	LS07-0033	HLG	2007/02/07
-	-	-	-
-	-	-	-
-	-	-	-

REV F - 2006-04-17

Copyright FCJ.