

# EAO – Your Expert Partner for Human Machine Interfaces

K14-271.122120 - Pushbutton

## K14-271.122120 - Pushbutton



*Attention: The preview is based on a sample product. This can differ from your current configuration.*

### Mounting

Design raised  
Mounting cut-out Ø 22.3 mm

### Front

Front dimension Ø 29 mm  
Front shape round

### Other Attributes

Weight 0.019 kg

### Operating-/Indication part

Lens colour black anodized  
Lens material Aluminium  
Lens optics opaque  
Lens profile flush

### IP-Rating

Front protection IP67

### Connection Method

Terminal Soldering terminal

### Actuator

Switching action Maintained  
Housing colour black  
Housing material Plastic

### Switching element

Switching system Snap-action switching element  
Switching current 5 A  
Contacts 1 NC + 1 NO  
Contact material  
Switching voltage 250 V AC

### Function

Pushbutton

# EAO – Your Expert Partner for Human Machine Interfaces

K14-271.122120 - Pushbutton

## Dimensions

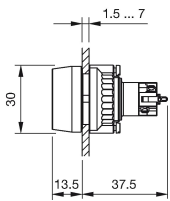

## Mounting cut-outs

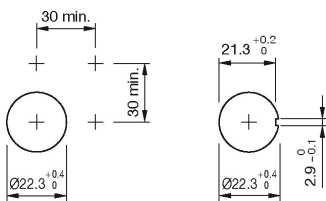

## Wiring diagram

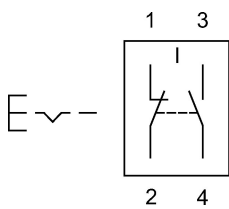

## Legend

Contacts: NC = Normally closed, NO = Normally open