

EAO – Your Expert Partner for Human Machine Interfaces

K14-131.221101 - Illuminated pushbutton

K14-131.221101 - Illuminated pushbutton



Attention: The preview is based on a sample product. This can differ from your current configuration.

Mounting

Design	flush
Mounting cut-out	Ø 30,5 mm

Front

Front dimension	Ø 35 mm
Front shape	round

Other Attributes

Weight	0.031 kg
Operation current	2.5/5 mA ±15 %
Operating voltage	24 V AC/DC

Operating-/Indication part

Lens illumination	illuminative
Lens colour	red
Lens material	Plastic
Lens optics	transparent
Lens profile	flush

IP-Rating

Front protection	IP67
------------------	------

Connection Method

Terminal	Soldering terminal
----------	--------------------

Actuator

Switching action	Momentary
Housing colour	black
Housing material	Plastic

Switching element

Switching system	Snap-action switching element
Switching current	5 A
Contacts	1 NC + 1 NO
Contact material	
Switching voltage	250 V AC

Illumination

LED colour	red
------------	-----

Function

Illuminated pushbutton	
------------------------	--

EAO – Your Expert Partner for Human Machine Interfaces

K14-131.221101 - Illuminated pushbutton

Dimensions

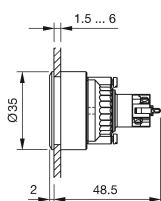

Mounting cut-outs

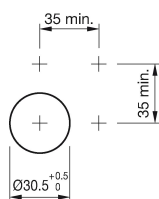

Wiring diagram

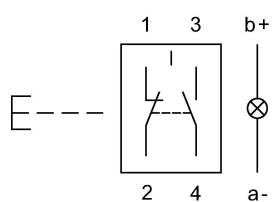

Legend

Contacts: NC = Normally closed, NO = Normally open