

KEA AC Inlet with 5 x 20mm Fuseholder



- Power entry module with 1-pole or 2-pole fuseholder
- For "cold" connections 65° C, Protection Class I.
- Screw mount from front or rear, or snap-in mount from front
- Single or double pole shocksafe fuseholder according to IEC 65/VDE 0860 for 5 x 20mm fuses (plug removal necessary for fuse replacement)
- Optional voltage selector with 2-4 step switch positions
- Quick-connect terminals .187 x .032" (4.8 x 0.8mm) or pcb terminals
- 0.5 Nm torque required for M3 screws for screw-on type
- Max. power dissipation 3.5 watts (2 pole fusing) according to IEC 127-6. For additional values P_v in function of T_{amb} , see page 5.
- For materials, options and accessories please see page 30
- For KEA with line filter, please see KFA on page 58
- For inlet with piggy-back fuse clips see GSF, pg. 13-14

UL	recognition	10A/250V	File #E93617
CSA	certification	10A/250V	File #LR38456
VDE	approval	10A/250V	File #1996, expert report
SEMKO	approval	10A/250V	File numbers on request
SEV	approval	10A/250V	

Standards: UL 498; CSA C22.2/182.3; DIN/VDE 0625; SEMKO 9320; IEC 320/C14; EN 60320. Medical fusedrawers meet tool-only accessibility requirements of medical standards IEC 601-1, BS5724 part 1, DIN/VDE 0750 part 1. U.S. Patented.

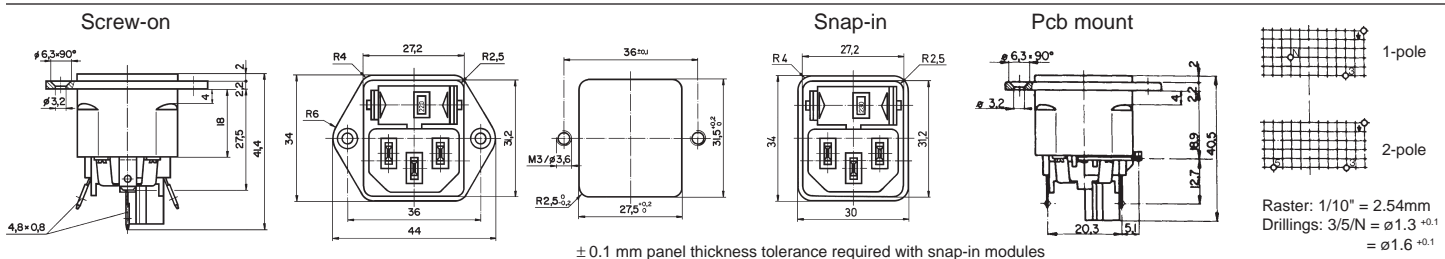
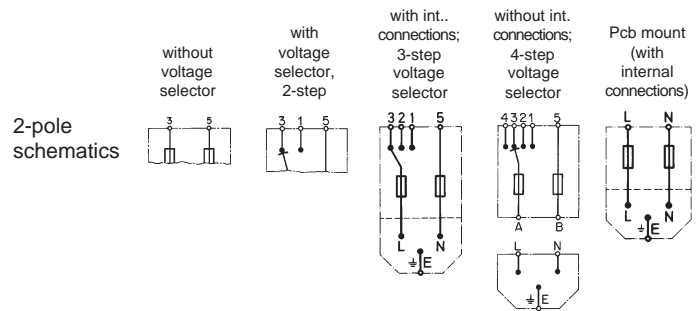
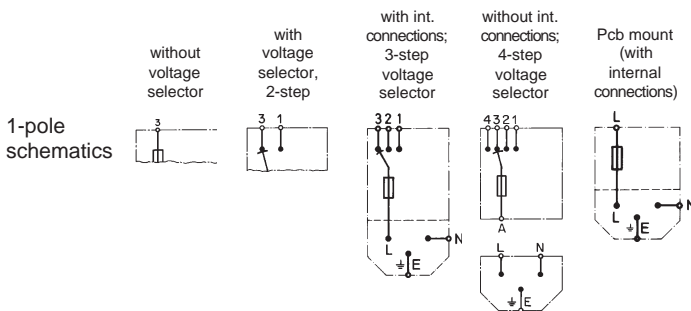

Order Numbers

Note: Casing and fusedrawer must be ordered separately. To order fuses, please see page 102

Casing		KEA with voltage selector		KEA pcb mnt., w/o volt. selector		Voltage Selector	Internal Connections	Mounting
1-pole fusing	2-pole fusing	1-pole fusing	2-pole fusing	1-pole fusing	2-pole fusing			
4301.0521	4301.0501	4301.0021	4301.0001	4301.3211	4301.3201	2-3 pos., (n/a pcb type)	with	Screw-on
4301.0522	4301.0502	4301.0022	4301.0002	4301.3212	4301.3202			Snap-in, 1.5mm panel thickness
4301.0523	4301.0503	4301.0023	4301.0003	4301.3213	4301.3203			Snap-in, 2.0mm panel thickness
4301.0524	4301.0504	4301.0024	4301.0004	4301.3214	4301.3204			Snap-in, 2.5mm panel thickness
Part numbers without internal connections on request		4301.2061	4301.2041	Part numbers without internal connections on request		3-4 pos., (n/a pcb type)	without	Screw-on
		4301.2062	4301.2042					Snap-in, 1.5mm panel thickness
		4301.2063	4301.2043					Snap-in, 2.0mm panel thickness
		4301.2064	4301.2044					Snap-in, 2.5mm panel thickness

Fusedrawer					
Voltage markings / terminal markings: 1 2 3 4		5 x 20mm 1-pole black	2-pole black	1-pole + spare fuse-case	2-pole black, with shorting bar in the neutral side
With voltage selector: see selector chart on page 30 for .XX	Standard	4301.1214.XX	4301.1014.XX	4301.2814.XX	4301.3536.XX
	Medical *	4301.1224.XX	4301.1024.XX	4301.2824.XX	4301.3537.XX
Without voltage selector	Standard	4301.1405	4301.1401	4301.1409	4301.1413
	Medical *	4301.1407	4301.1403	4301.1411	4301.1415

* Meets tool-only accessibility requirements of medical standards IEC 601-1, BS 5724 part 1, DIN/VDE 0750 part 1

0040 AC Inlet with 5 x 20mm Fuseholder



Note: Not recommended for new designs. Refer to KEA (pg. 36), GSF (pg. 13/14) or 6220 (pg. 35)



Standards: UL 498; CSA C22.2/182.3; DIN/VDE 0625; SEMKO 9320; IEC 320/C14/C18; EN 60320

- Power entry module with 1-pole or 2-pole fuseholder
- For "cold" connections 65° C, Protection Class I or II
- Screw mount from front
- Single or double pole shocksafe fuseholder according to IEC 65/VDE 0860 for 5 x 20mm fuses
- Quick-connect terminals .187 x .032" (4.8 x 0.8mm)
- 0.5 Nm torque required for M3 screws
- Max. power dissipation 2.4 watts (2-pole fusing) according to IEC 127-6. For additional values P_v in function of T_{amb} , see page 5
- For materials, options and accessories please see page 30
- For inlet with piggy-back fuse clips see GSF, page 13-14

UL recognition	10A/250V	File #E93617
CSA certification	10A/250V	File #LR38456
VDE approval	6A/250V	File #19397
SEMKO approval	10A/250V	File numbers on request
SEV approval	10A/250V	

Order Numbers (type)

Note: Casing and fuseholder combined. To order fuses, please see page 102.

Series 0040			
Class I	Class II	Color/Fusing	Terminal Type
0040.5000.2	0040.5015	black/2-pole	solder
8843-2.SP.FL.4/3.60	8842-2.SP.FL.4/3.60		.138" x .032" (3.5 x 0.8mm)
0040.5001.2		grey/2-pole	quick-connect
8843-2.SP.FL.4/3.64			.187" x .032" (4.8 x 0.8mm)
0040.5012		black/1-pole	quick-connect
8843-2.SP.U.FL.4/3.60			.250" x .032" (6.3 x 0.8mm)

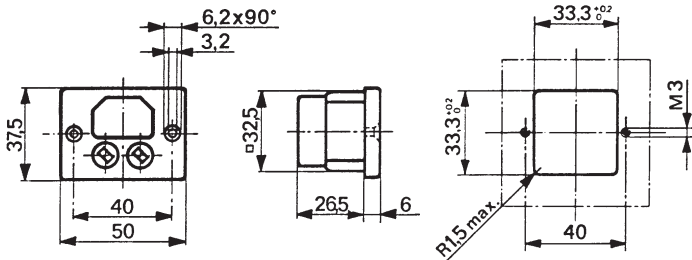

8843 AC Inlet • Interchangeable Fuseholders for 1/4 x 1 1/4" or 5 x 20mm Fuses



Standards: UL 498; CSA C22.2/182.3; DIN/VDE 0625; SEMKO 9320; IEC 320/C14; EN 60320. U.S. Patented.

- Power entry module with 1-pole or 2-pole fuseholder
- For "cold" connections 65° C, Protection Class I.
- Screw mount from front or rear, or snap-in mount from front (0.8-3.0mm panel thickness)
- Single or double pole shocksafe fuseholder according to IEC 65/VDE 0860 for 1/4 x 1 1/4" or 5 x 20mm fuses
- Quick-connect terminals .187 x .032" (4.8 x 0.8mm) or solder .138 x .032" (3.0 x 0.8mm).
- 0.5 Nm torque required for M3 screws for screw-on type
- Max. power dissipation 5.5 watts (2 pole fusing, unfiltered) according to IEC 127-6. For additional values P_v in function of T_{amb} , see page 6
- For materials, options and accessories please see page 30
- For 8843 with line filter, please see 8843 on page 59
- For inlet with piggy-back fuse clips see GSF, page 13-14

UL recognition	10A/250V	File #E96317
CSA certification	10A/250V	File #LR38456
VDE approval	10A/250V	File #3157, expert report
SEMKO approval	10A/250V	File numbers on request
SEV approval	10A/250V	

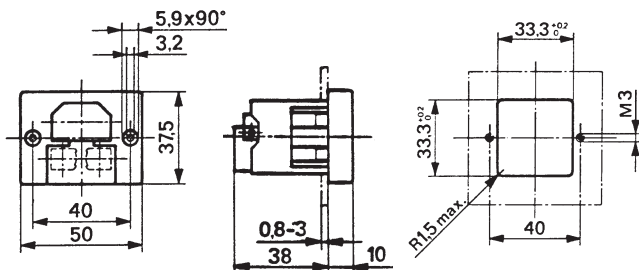

Order Numbers (type) Note: Casing and fuseholders must be ordered separately. To order fuses, please see page 102.

Casing					
8843		Terminals		Fuseholder inserts* (2 inserts must be ordered for 2-pole fusing)	
1-pole fusing	2-pole fusing			Mounting	
8843.0351 (8843-351.60)	8843.0361 (8843-361.60)	Solder .138" X .032" (3.0 x 0.8mm)		Screw-on	8843.0901 1/4 x 1 1/4"
8843.0353 (8843-353.60)	8843.0363 (8843-363.60)	Quick-connect .187" x .032" (4.8 x 0.8mm)		Screw-on	8843-901.60 (6.3x32mm)
8843.0451 (8843-451.60)	8843.0461 (8843-461.60)	Solder .138" X .032" (3.0 x 0.8mm)		Snap-in, 0.8-3.0mm panel thickness	8843.0902 for 5 x 20mm
8843.0453 (8843-453.60)	8843.0463 (8843-463.60)	Quick-connect .187" x .032" (4.8 x 0.8mm)		Snap-in, 0.8-3.0mm panel thickness	8843-902.60