



GP series

GP 12650 12V 65AH

Valve Regulated Lead Acid Battery

Maintenance-Free Sealed Lead Acid Battery.

Absorbent Glass Mat (AGM) technology for efficient gas recombination of up to 99%.

Design for Standby Power Applications

【Design Life】

Up to 5 Years in Standby Service at 25°C
Eurobat (20°C) : 3-5 years, Standard Commercial

【Operating Temperature Range】

Nominal Operating Temperature : 25°C (77°F)
Discharge : -15°C ~ 50°C (5°F~122°F)
Charge: -15°C ~ 40°C (5°F~104°F)
Storage: -15°C ~ 40°C (5°F~104°F)

【Float Charging Voltage】

13.5 ~ 13.8 VDC/Unit at 25°C (77°F)

【Equalization Charging Voltage】

14.4 ~ 15.0 VDC/Unit at 25°C (77°F)

【Self Discharge】

Less than 10% after 90 days, can be stored up to 6 months at 25°C (77°F); Fully recharging is required before usage, and charged sooner if stored at higher temperature than 25°C (77°F).

Specification

Design according with IEC 60896-21/22: 2004

Nominal Voltage	12V (6 cells per unit)		
Nominal Capacity	65 Ah @20hr-rate to 1.75V per cell @25°C (77°F)		
Weight	Approx. 20.00 Kg (44.08 lbs)		
Maximum Discharge Current	500A (5sec)		
Internal Resistance	Approx. 5.8mΩ		
Short Circuit Current	1663A		
Maximum Charge Current	19.50A		
Terminal types	B4 terminal to accept M6 bolt		
Terminal hardware Torque	138.6 Kgf-cm / 120.3 Lbf-in / 13.58 N-m		
Container Material	PP (UL 94-HB) & Flame Retardant (94-V0) available upon request		
Dimensions	Length (L)	349.4±2.5 mm	13.76±0.10 inch
	Width (W)	166.0±2.0 mm	6.54±0.08 inch
	Container Height (h)	174.9±2.0 mm	6.89±0.08 inch
	Overall Height (H)	174.9±2.0 mm	6.89±0.08 inch

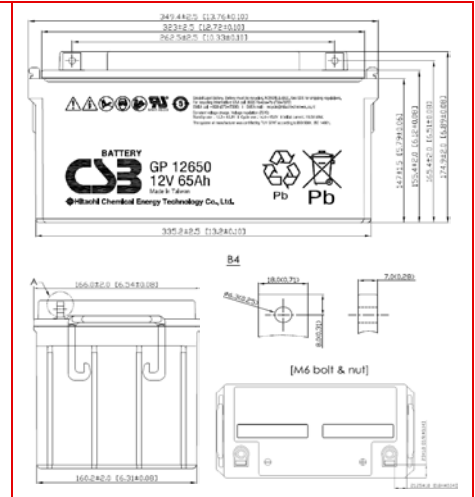

Constant Current Discharge Characteristics Unit: A (25°C, 77°F)

F.V/Time	5 MIN	10MIN	15MIN	30MIN	60MIN	90MIN	2HR	3HR	5HR	8HR	10HR	20HR
1.60V	271	173	132	79.9	47.2	34.2	27.3	19.4	12.4	8.08	6.58	3.57
1.67V	242	162	124	78.3	46.9	34.1	27.2	19.3	12.3	7.97	6.47	3.42
1.70V	229	157	121	77.3	46.7	34.0	27.1	19.2	12.2	7.93	6.43	3.36
1.75V	208	147	117	75.4	46.4	33.8	27.0	19.1	12.1	7.86	6.32	3.25
1.80V	186	137	111	73.4	45.9	33.6	26.9	19.0	12.0	7.76	6.21	3.14
1.85V	164	127	105	71.3	45.4	33.3	26.8	18.9	11.9	7.66	6.10	3.03

Constant Power Discharge Characteristics Unit: W (25°C, 77°F)

F.V/Time	5MIN	10MIN	15MIN	30MIN	60MIN	90MIN	2HR	3HR	5HR	8HR	10HR	20HR
1.60V	3250	2080	1580	959	566	411	327	232	148	97.0	79.0	40.9
1.67V	2900	1940	1503	935	562	409	326	231	147	96.0	77.7	39.2
1.70V	2750	1871	1460	924	560	407	325	230	146	95.5	77.1	38.4
1.75V	2490	1760	1400	903	555	405	324	229	145	94.3	75.8	37.1
1.80V	2230	1640	1330	881	550	403	323	228	144	93.1	74.5	35.7
1.85V	1970	1520	1260	856	545	400	322	227	143	91.9	73.2	34.4

Please refer to the official site for the latest rating confirmation. URL: www.csb-battery.com

Issued: 161101

Sales Offices

日立化成能源科技股份有限公司
Hitachi Chemical Energy Technology Co., Ltd.

BUSINESS HEADQUARTERS

Tel: +886-2-2880-5600
Fax: +866-2-2888-3300

USA OFFICE

Tel: +1-817-244-7777 / 1-(800)3-CSB-USA (272872)
Fax: +1-817-244-4445

SHENZHEN OFFICE (CHINA)

Tel: +86-755-8831-6488, 8831-6775
Fax: +86-755-8831-6075

EUROPE (EMEA) OFFICE

Tel: +31(0)180-418-140
Fax: +31(0)180-418-327

SHANGHAI OFFICE (CHINA)

Tel: +86-21-5046-1622, 5046-0833
Fax: +86-21-5046-1046

TAIPEI OFFICE

Tel: +886-2-2880-5600
Fax: +866-2-2888-3300

BEIJING OFFICE (CHINA)

Tel: +86-10-5820-5336, 5820-5338
Fax: +86-10-5820-3053

Recognized under UL 1989,
and certified by ISO 9001, 14001.

