

KEMET, FLLE2-PV, EMI Filters, Single Phase, 1.2 kV, 250 A, 300x130x100mm

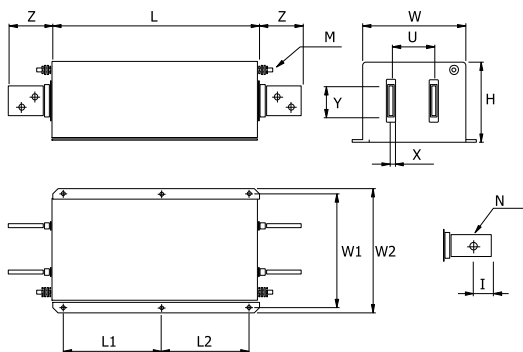

Dimensions

L	300mm NOM
W	130mm NOM
H	100mm NOM
L1	130mm NOM
L2	110mm NOM
W1	155mm NOM
W2	180mm NOM
U	70mm NOM
X	5mm NOM
Y	20mm NOM
Z	58mm NOM
I	15mm NOM
N	9mm NOM
M (Earth)	Threaded Studs M10

Packaging Specifications

Packaging:	Bulk
Packaging Quantity:	1
Weight:	8 kg

General Information

Series:	FLLE2-PV
Style:	Chassis Mount
Description:	EMI Filter, Without Y Capacitor
Features:	Photovoltaic Applications
RoHS:	Yes
Qualifications:	IEC/EN 60939, UL 1283

Specifications

Voltage DC:	1200 VDC
Current:	250 A (50C)
Rated Temperature:	55C
Temperature Range:	-40/+100C
Climate Category:	40/100/21
Test Voltage DC (P to P):	3000 VDC
Test Voltage DC (P to E):	3600 VDC
Power Loss:	10 W (25C 50 Hz)

Statements of suitability for certain applications are based on our knowledge of typical operating conditions for such applications, but are not intended to constitute - and we specifically disclaim - any warranty concerning suitability for a specific customer application or use. This Information is intended for use only by customers who have the requisite experience and capability to determine the correct products for their application. Any technical advice inferred from this Information or otherwise provided by us with reference to the use of our products is given gratis, and we assume no obligation or liability for the advice given or results obtained.