

## RE - 140 (3 POLE) & RE - 140/1

PT.NO. 457 RE 140 (WITH BRACKET).  
 PT.NO. 719 RE 140 (WITHOUT BRACKET)  
 PT.NO. 457 RE 140/1 (WITH BRACKET)  
 PT.NO. 719 RE 140/1 (WITHOUT BRACKET)  
 PT.NO. 724 MOTOR BRACKET (90o ONLY)

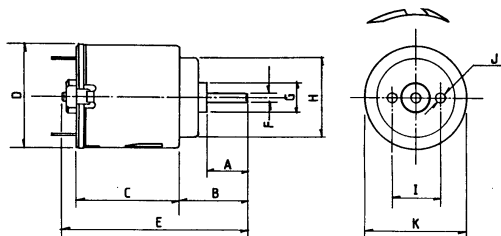
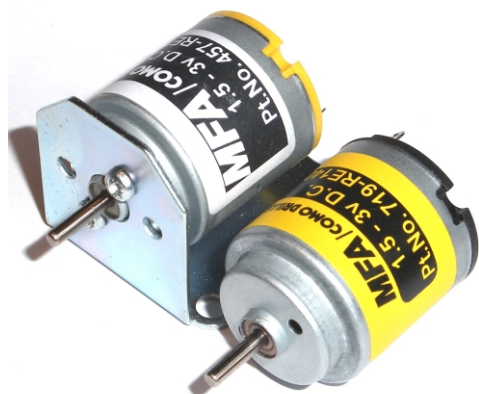

Weight 20g (approx)

DIMENSIONS	A	B	C	D	E	F	G	H	I	J	K
MILLIMETER	8.3	14.0	21.0	21.0	38.0	2.0	6.15	16.0	10.0	2.0	20.15
DECIMAL INCHES	0.33	0.55	0.827	0.827	1.496	0.079	0.242	0.63	0.394	0.079	0.793

MODEL	VOLTAGE		NO LOAD		AT MAXIMUM EFFICIENCY						STALL TORQUE	
	OPERATING RANGE	NOMINAL	SPEED	CURRENT	SPEED	CURRENT	TORQUE		OUTPUT	EFF	STALL TORQUE	
			R.P.M.	A	R.P.M.	A	oz - in	g - cm	W	%	oz - in	g - cm
RE - 140	1.5 - 3.0	1.5v CONSTANT	8200	0.190	6250	0.62	0.089	6.4	0.400	44.2	0.375	27.0
RE - 140	1.5 - 3.0	3.0v CONSTANT	15300	0.26	12200	1.04	1.444	13	2.51	52.3	0.750	64.0
RE - 140/1	3.0 - 9.0	6v CONSTANT	9200	0.066	7071	0.219	0.11	8.1	0.589	44.79	0.48	35.1

Stall Current RE140 at 1.5v = 1.6A RE140 at 3v 3.0A, RE140/1 at 6v 0.7A

## RE - 170 (3 POLE)

PT.NO. 457 RE 170 (WITH BRACKET).  
 PT.NO. 719 RE 170 (WITHOUT BRACKET)  
 PT.NO. 724. MOTOR BRACKET (90o ONLY)

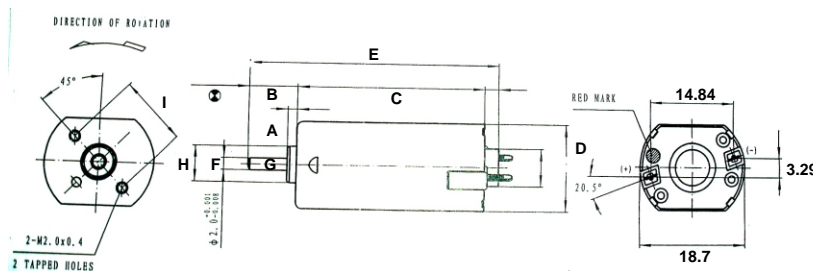
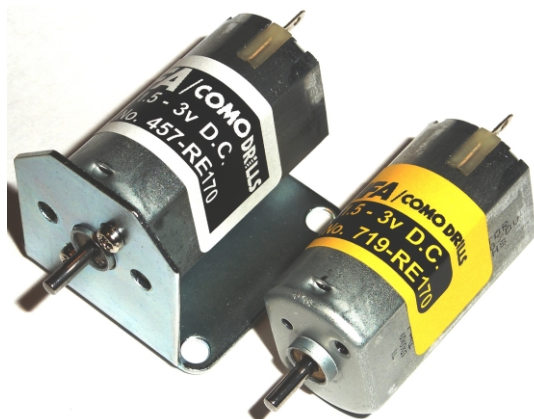

Weight 29g (approx)

DIMENSIONS	A	B	C	D	E	F	G	H	I	J	K
MILLIMETER	6.7	8.3	32.0	18.7	42.7	2.0	6.5	14.5	M2	12.0	45o
DECIMAL INCHES	0.26	0.33	1.26	0.74	1.68	0.08	0.24	0.57		0.47	

MODEL	VOLTAGE		NO LOAD		AT MAXIMUM EFFICIENCY						STALL TORQUE	
	OPERATING RANGE	NOMINAL	SPEED	CURRENT	SPEED	CURRENT	TORQUE		OUTPUT	EFF	STALL TORQUE	
			R.P.M.	A	R.P.M.	A	oz - in	g - cm	W	%	oz - in	g - cm
RE - 170	1.5 - 3.0	3.0v CONSTANT	10400	0.17	8870	1.03		27	2.47	79.9		184

Stall Current RE170 at 1.5 - 3.0v = 6.0A

## RE - 260 (3 POLE)



PT.NO. 457 RE 260 (WITH BRACKET).  
 PT.NO. 719 RE 260 (WITHOUT BRACKET)  
 PT.NO. 724 MOTOR BRACKET (90° ONLY)

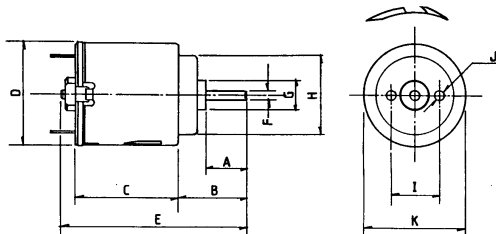

Weight 29g (approx)

DIMENSIONS	A	B	C	D	E	F	G	H	I	J	K
MILLIMETER	8.2	11.3	23.5	23.7	42.0	2.0	6.1	19.1	11.5	2.3	23.7
DECIMAL INCHES	0.32	0.44	0.93	0.93	1.65	0.079	0.24	0.75	0.45	0.09	0.93

MODEL	VOLTAGE		NO LOAD		AT MAXIMUM EFFICIENCY					STALL TORQUE			
	OPERATING RANGE	NOMINAL	SPEED	CURRENT	SPEED	CURRENT	TORQUE		OUTPUT	EFF	STALL TORQUE		
			R.P.M.	A	R.P.M.	A	oz - in	g - cm	W	%	oz - in	g - cm	
RE - 260	3.0 - 6.0	3.0v CONSTANT	4242	0.042	3296	0.151			6.8	0.345	33.91		30.61
RE - 260	3.0 - 6.0	4.5v CONSTANT	6722	0.065	5256	0.227			9.9	0.53	50.4		45.9
RE - 260	3.0 - 6.0	6.0v CONSTANT	8478	0.087	6587	0.302			13.6	0.92	31.5		61.84

Stall Current RE260 at 3v = 0.58A, At 4.5v = 0.84A, at 6v = 1.10A

## RE - 280 (3 POLE) & RE - 280/1 & RE-280/5



PT.NO. 457 RE 280 (WITH BRACKET)  
 PT.NO. 457 RE 280/1 (WITH BRACKET)  
 PT. NO. 457 RE 280/5 (WITH BRACKET)  
 PT.NO. 719 RE 280 (WITHOUT BRACKET)  
 PT.NO. 719 RE 280/1 (WITHOUT BRACKET)  
 PT. NO. 719 RE 280/5 (WITHOUT BRACKET)  
 PT.NO. 724 MOTOR BRACKET (90° ONLY)

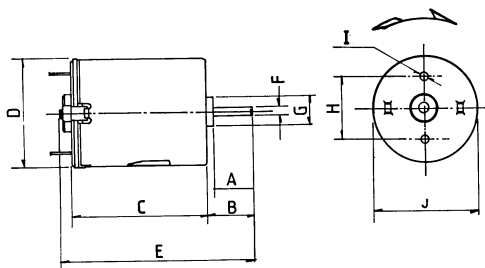

Weight 44g (approx)

	DIMENSIONS	A	B	C	D	E	F	G	H	I	J	K
RE 280, RE 280/1	MILLIMETER	7.40	12.0	30.5	23.8	42.0	2.0	6.35	14.0	2.3	24.2	
RE 280/5	DECIMAL INCHES	0.41	0.472	1.201	0.937	1.65	0.078	0.250	0.551	0.090	0.953	

MODEL	VOLTAGE		NO LOAD		AT MAXIMUM EFFICIENCY					STALL TORQUE		
	OPERATING RANGE	NOMINAL	SPEED	CURRENT	SPEED	CURRENT	TORQUE		OUTPUT	EFF	STALL TORQUE	
			R.P.M.	A	R.P.M.	A	oz - in	g - cm	W	%	oz - in	g - cm
RE - 280	1.5 - 3.0	3.0v CONSTANT	8800	0.24	7200	1.06	0.32	23.2	1.71	53.8	1.75	126.0
RE - 280/1	12 - 24	12v CONSTANT	8224	0.046	6636	0.194	0.27	19.2	1.31	56.1	1.38	99.3
RE - 280/5	3 - 6	6v CONSTANT	9256	0.108	7703	0.534	0.35	23.7	1.99	58.4	2.648	141.2

Stall Current RE280 at 3v = 4.8A, RE280/1 at 12v = 0.81A. RE280/5 at 6v = 2.65A

## RE - 360 (3 POLE) & RE - 360/1

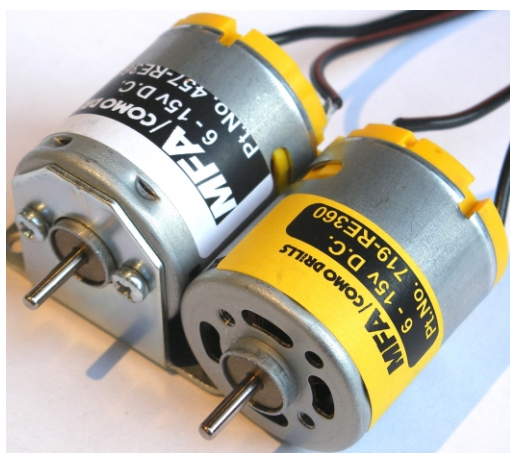

Pt. No. 457 RE 360 (with Bracket)  
 Pt. No. 719 RE 360 (without Bracket)  
 Pt. No. 457 RE 360/1 (with bracket)  
 Pt. No. 719 RE 360/1 (without bracket)  
 Pt. No. 725 Motor Bracket (90o only)

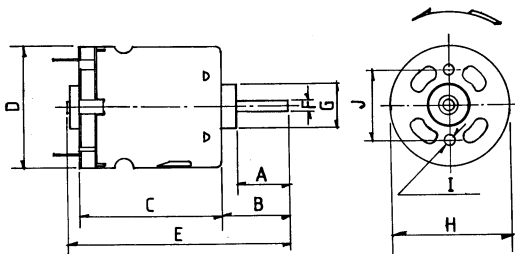

Weight 51g (approx)

DIMENSIONS	A	B	C	D	E	F	G	H	I	J	K
MILLIMETER	8.2	11.5	32.5	27.63	47.0	2.305	10.0	27.5	M2.6	16.0	
DECIMAL INCHES	0.323	0.453	1.28	1.088	1.85	0.091	0.394	1.083		0.63	

MODEL	VOLTAGE		NO LOAD		AT MAXIMUM EFFICIENCY					STALL TORQUE		
	OPERATING RANGE	NOMINAL	SPEED	CURRENT	SPEED	CURRENT	TORQUE	OUTPUT	EFF	oz - in	g - cm	
			R.P.M.	A	R.P.M.	A	g - cm	W	%			
RE - 360	6 - 15	12v CONSTANT	10420	0.143	8768	0.758		64.2	58	63.5		405.0
RE - 360/1	3 - 6v	6v CONSTANT	10450	0.31	8706	1.55		63.4	56.6	60.9		379.8

Stall Current RE360 at 12v = 4.02A. RE360/1 at 6v = 7.73A

## RE - 380 (3 POLE)

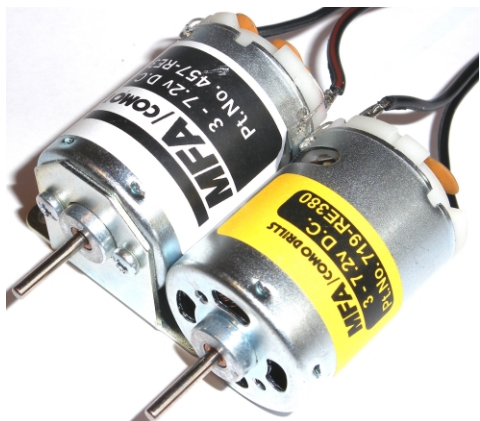

Pt. No. 457 RE 380 (with Bracket)  
 Pt. No. 719 RE 380 (without Bracket)  
 Pt. No. 725 Motor Bracket (90o only)

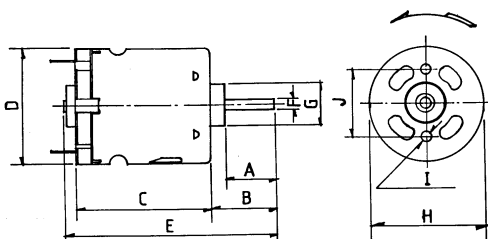

Weight 69g (approx)

DIMENSIONS	A	B	C	D	E	F	G	H	I	J	K
MILLIMETER	14.55	17.15	37.8	27.7	57.15	2.30	10.0	27.7	M2.5x5 Taptite. PH	16.0	
DECIMAL INCHES	0.57	0.68	1.496	1.091	2.244	0.091	0.394	1.083		0.630	

MODEL	VOLTAGE		NO LOAD		AT MAXIMUM EFFICIENCY					STALL TORQUE		
	OPERATING RANGE	NOMINAL	SPEED	CURRENT	SPEED	CURRENT	TORQUE	OUTPUT	EFF	oz - in	g - cm	
			R.P.M.	A	R.P.M.	A	oz - in	g - cm	W			%
RE - 380	3.0 - 7.2	7.2v CONSTANT	26990	1.09	22356	5.25	1.49	107.3	24.6	60	8.68	625.2

Stall Current RE380 at 7.2v = 11.2A

## RE - 385 (5 POLE)



Pt. No. 457 RE 385 (with Bracket)  
 Pt. No. 719 RE 385 (without Bracket)  
 Pt. No. 725 Motor Bracket (90o only)

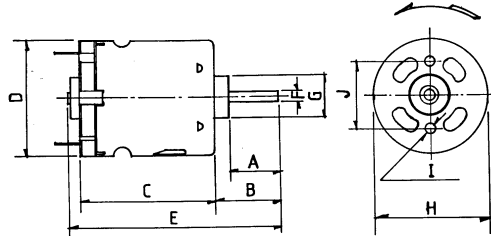

Weight 66g (approx)

DIMENSIONS	A	B	C	D	E	F	G	H	I	J	K
MILLIMETER	9.4	12.0	38.0	27.7	52.5	2.305	10.0	27.5	M2.6	16.0	
DECIMAL INCHES	0.453	0.591	1.496	1.091	2.205	0.091	0.394	1.083		0.630	

MODEL	VOLTAGE		NO LOAD		AT MAXIMUM EFFICIENCY						STALL TORQUE	
	OPERATING RANGE	NOMINAL	SPEED	CURRENT	SPEED	CURRENT	TORQUE		OUTPUT	EFF	STALL TORQUE	
			R.P.M.	A	R.P.M.	A	oz - in	g - cm	W	%	oz - in	g - cm
RE - 385	4.5 - 15.0	12v CONSTANT	11646	0.18	9869	0.99		78.4	7.98	66.1		513.5
RE - 385/24V	24V	24V CONSTANT	11748	0.09	9946	0.499		76.9	8.1	68		501.4

Stall Current RE385 at 12v = 5.55A. RE385/24v at 24v = 2,75A

## RE - 385LN (5 POLE). NOISE ATTENUATED



Pt. No. 457 RE 385LN (with Bracket)  
 Pt. No. 719 RE 385LN (without Bracket)  
 Pt. No. 725 Motor Bracket (90o only)

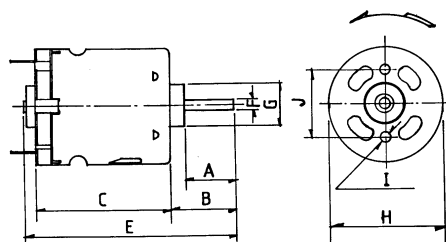

Weight 110g (approx)

DIMENSIONS	A	B	C	D	E	F	G	H	I	J	K
MILLIMETER	6	8.5	46.5		57.3	2.3	10.0	29	M 3	16.0	

MODEL	VOLTAGE		NO LOAD		AT MAXIMUM EFFICIENCY						STALL TORQUE	
	OPERATING RANGE	NOMINAL	SPEED	CURRENT	SPEED	CURRENT	TORQUE		OUTPUT	EFF	STALL TORQUE	
			R.P.M.	A	R.P.M.	A	oz - in	g - cm	W	%	oz - in	g - cm
RE - 385LN	6.0 - 12.0	12v CONSTANT	7300	0.15	5950	0.9		110	6.72	62		660

Stall Current RE385LN at 12v = 5.0A

## RE - 500LN (suitable for solar applications)

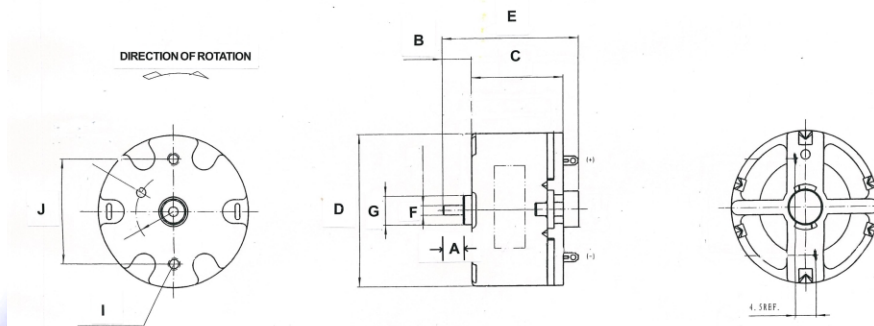

Weight 41g (approx)

DIMENSIONS	A	B	C	D	E	F	G	H	I	J	K
MILLIMETER	4.4	6.3	19.5	32	29.1	2	6.1		M2 6x0.45	22.0	
DECIMAL INCHES											

MODEL	VOLTAGE		NO LOAD		AT MAXIMUM EFFICIENCY						STALL TORQUE	
	OPERATING RANGE	NOMINAL	SPEED R.P.M.	CURRENT A	SPEED R.P.M.	CURRENT A	TORQUE		OUTPUT W	EFF %	oz - in	g - cm
RE - 500LN	3.0 - 6.0	6v CONSTANT	2690	0.017	2197	0.074		12.2	0.28	62.1		66.9

Stall Current RE500LN at 6v = 0.38A

## RE - 540 (3 POLE)

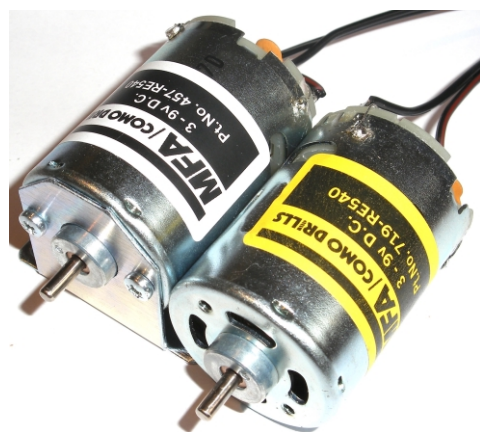

Pt. No. 457 RE 540 (with Bracket)  
 Pt. No. 719 RE 540 (without Bracket)  
 Pt. No. 726 Motor Bracket (90o only)

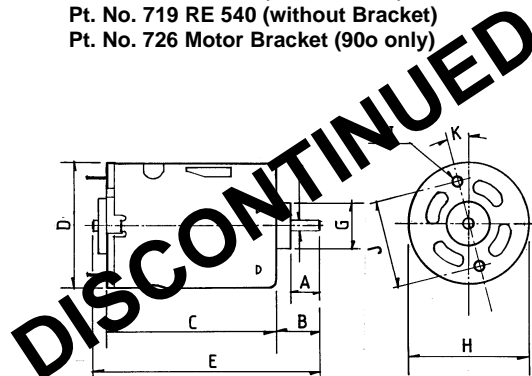

Weight 148g (approx)

DIMENSIONS	A	B	C	D	E	F	G	H	I	J	K
MILLIMETER	8.5	13.0	50.0	35.8	67.0	3.175	13.0	35.7	M3	25.0	
DECIMAL INCHES	0.335	0.512	1.969	1.409	2.638	0.125	0.512	1.406		0.984	

MODEL	VOLTAGE		NO LOAD		AT MAXIMUM EFFICIENCY						STALL TORQUE	
	OPERATING RANGE	NOMINAL	SPEED R.P.M.	CURRENT A	SPEED R.P.M.	CURRENT A	TORQUE		OUTPUT W	EFF %	oz - in	g - cm
RE - 540	3.0 - 9.0	3.6v CONSTANT	8400	0.80	8350	5.71	1.87	135	11.6	56.4	10.8	780
RE - 540	3.0 - 9.0	6.0v CONSTANT	14000	1.00	10800	7.10	3.5	254	28.1	66.0	26.4	1900

Stall Current RE540 at 6v = 28.87A

## RE - 540LN (5 POLE). NOISE ATTENUATED



Pt. No. 457 RE 540LN (with Bracket)  
 Pt. No. 719 RE 540LN (without Bracket)  
 Pt. No. 726 Motor Bracket (90o only)

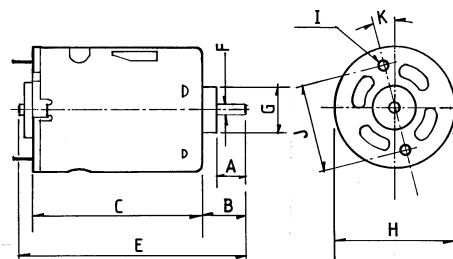

Weight 212g (approx)

DIMENSIONS	A	B	C	D	E	F	G	H	I	J	K
MILLIMETER	5.5	9.75	57.1		69.2	3.175	14.0	37	M3	25.0	

MODEL	VOLTAGE		NO LOAD		AT MAXIMUM EFFICIENCY						STALL TORQUE	
	OPERATING RANGE	NOMINAL	SPEED	CURRENT	SPEED	CURRENT	TORQUE		OUTPUT	EFF	STALL TORQUE	
			R.P.M.	A	R.P.M.	A	oz - in	g - cm	W	%	oz - in	g - cm
RE - 540LN	6.0 - 12.0	12v CONSTANT	6000	0.17	4930	1.6		250	12.8	67		1375

Stall Current RE 540LN at 6v = 10.0 A

## RE - 540/1 (3 POLE)



Pt. No. 457 RE 540/1 (with Bracket)  
 Pt. No. 719 RE 540/1 (without Bracket)  
 Pt. No. 726 Motor Bracket (90o only)

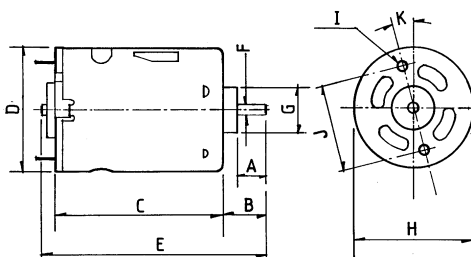

24 volt versions are available for this range of motors. Performance data is similar to 12 volt versions. This version also has an extended 10mm rear shaft to accommodate motor encoders.

Pt. No's  
 457RE540124V  
 719RE540124V

Weight 146g (approx)

DIMENSIONS	A	B	C	D	E	F	G	H	I	J	K
MILLIMETER	9.0	13.5	50.0	35.8	68.0	3.175	13.0	35.7	M3	25.0	
DECIMAL INCHES	0.354	0.531	1.969	1.409	2.67	0.125	0.512	1.406		0.984	

MODEL	VOLTAGE		NO LOAD		AT MAXIMUM EFFICIENCY						STALL TORQUE	
	OPERATING RANGE	NOMINAL	SPEED	CURRENT	SPEED	CURRENT	TORQUE		OUTPUT	EFF	STALL TORQUE	
			R.P.M.	A	R.P.M.	A	oz - in	g - cm	W	%	oz - in	g - cm
RE - 540/1	4.5 - 15.0v	6.0v CONSTANT	7500	0.45	6180	2.1	1.64	118.2	7.49	59.4	9.31	670
		12.0v CONSTANT	14724	0.52	12380	2.75	2.11	152.2	19.35	58.6	13.28	955.87

Stall Current RE540/1 at 6.0v =9.0A. at 12v = 14.09A

## RE - 700 (3 POLE) Ball raced motor



Pt. No. 457 RE 700 (with Bracket)  
 Pt. No. 719 RE 700 (without Bracket)  
 Pt. No. 726 Motor Bracket (90o only)

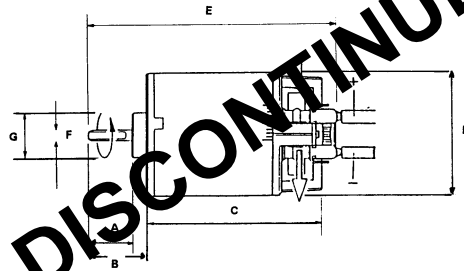

Weight 178g (approx)

DIMENSIONS	A	B	C	D	E	F	G	H	I	J	K
MILLIMETER	12.45	16.45	50.0	36.6	70.0	3.165	13.0	36.6	M2.5x5	24.0	
DECIMAL INCHES											

MODEL	VOLTAGE		NO LOAD		AT MAXIMUM EFFICIENCY						STALL TORQUE	
	OPERATING RANGE	NOMINAL	SPEED	CURRENT	SPEED	CURRENT	TORQUE		OUTPUT	EFF	STALL TORQUE	
			R.P.M.	A	R.P.M.	A	oz - in	g - cm	W	%	oz - in	g - cm
RE700	6.0 - 8.4v	7.2v constant	22500	2.4	15600	10.3	3.5	250	40	54	21	1500 est

## RE - 800 (3 POLE)



Pt. No. 457 RE 800 (with Bracket)  
 Pt. No. 719 RE 800 (without Bracket)  
 Pt. No. 1114/2 Motor Bracket (90o only)

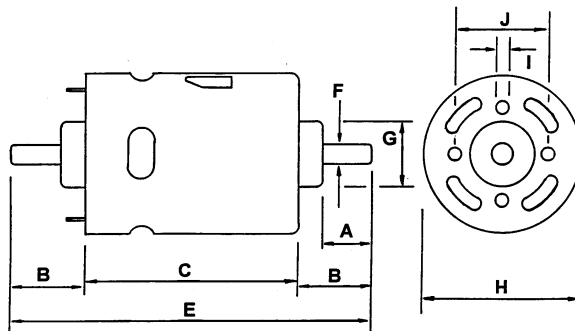

Weight 595g (approx)

DIMENSIONS	A	B	C	D	E	F	G	H	I	J	K
MILLIMETER	13.2	20.5	69.0		110.0	6.35	21.75	51.8	M5	32.0	
DECIMAL INCHES	0.520	0.810	2.720		4.330	0.250	0.860	2.040		1.260	

MODEL	VOLTAGE		NO LOAD		AT MAXIMUM EFFICIENCY						STALL TORQUE	
	OPERATING RANGE	NOMINAL	SPEED	CURRENT	SPEED	CURRENT	TORQUE		OUTPUT	EFF	STALL TORQUE	
			R.P.M.	A	R.P.M.	A	oz - in	mN-m	W	%	oz - in	g - cm
RE - 800	12.0v	12.0v CONSTANT	5167	1.058	4289	5.28		82.08	36.88	58.2		4604

Stall Current RE 800 at 12v = 25.9A

## RE - 850 (3 POLE)

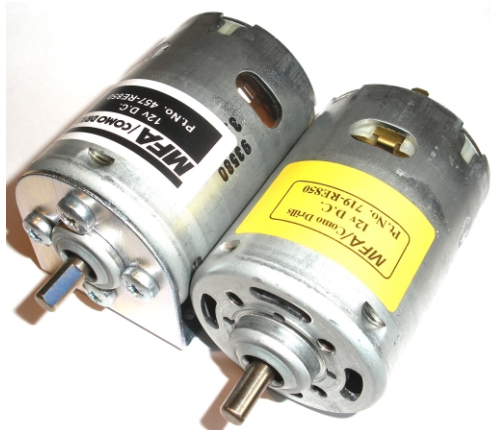

Pt. No. 457 RE 850 (with Bracket)  
 Pt. No. 719 RE 850 (without Bracket)  
 Pt. No. 1114/2 Motor Bracket (90o only)

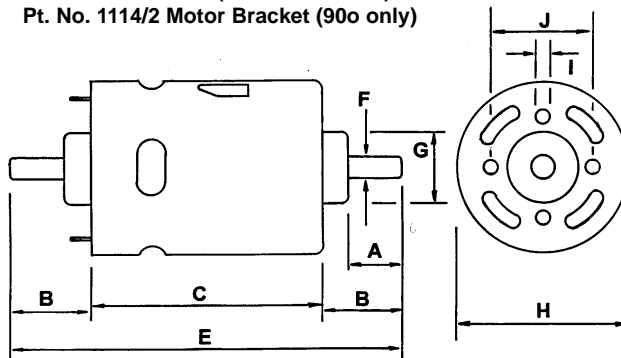

Weight 595g (approx)

DIMENSIONS	A	B	C	D	E	F	G	H	I	J	K
MILLIMETER	13.2	20.5	69.0		110.0	6.350	21.75	51.8	M5	32.0	
DECIMAL INCHES	0.520	0.810	2.720		4.330	0.250	0.860	2.040		1.260	

MODEL	VOLTAGE		NO LOAD		AT MAXIMUM EFFICIENCY						STALL TORQUE	
	OPERATING RANGE	NOMINAL	SPEED	CURRENT	SPEED	CURRENT	TORQUE		OUTPUT	EFF	STALL TORQUE	
			R.P.M.	A	R.P.M.	A	oz - in	mN-m	W	%	oz - in	mN-m
RE - 850	12.0v	12.0v CONSTANT	9778	1.90	8311	10.82		92.13	80.16	61.74		614

Stall Current RE 850 at 12v = 61.34A