

**Crimping contact  
HDC-C-HE-BM0.75-1.00AG**

**Weidmüller Interface GmbH & Co. KG**  
Klingenbergstraße 16  
D-32758 Detmold  
Germany  
Fon: +49 5231 14-0  
Fax: +49 5231 14-292083  
www.weidmueller.com



Crimps provide a electrical and mechanical connection between wire and contact that is both secure and reliable. The optimal crimp connection is gas-tight and corrosion-resistant.

**General ordering data**

Type	HDC-C-HE-BM0.75-1.00AG
Order No.	<a href="#">1201200000</a>
Version	Heavy Duty Connectors, Crimp contact, HE, HEE, HQ, MixMate, Female, Conductor cross-section, max.: 1, turned, Copper alloy
GTIN (EAN)	4008190044480
Qty.	100 pc(s).

**Crimping contact  
HDC-C-HE-BM0.75-1.00AG**

**Weidmüller Interface GmbH & Co. KG**  
 Klingenbergstraße 16  
 D-32758 Detmold  
 Germany  
 Fon: +49 5231 14-0  
 Fax: +49 5231 14-292083  
 www.weidmueller.com

**Technical data**
**Dimensions and weights**

Net weight	1.45 g	Diameter	4.5 mm
------------	--------	----------	--------

**General data**

Contact diameter, male Ø	2.5 mm	Cross-section for connected wire	0.75 - 1 mm <sup>2</sup>
Material	Copper alloy	Plugging cycles	≥ 500
Production methods	turned	Series	HE
Stripping length, rated connection	7.5 mm	Surface finish	silver
Surface layer thickness, max.	3 µm	Surface layer thickness, min.	2 µm
Type	Female	Type of connection	Crimp connection
Version insert	HE, HEE, HQ, MixMate	Volume resistance	≤ 2mΩ

**Classifications**

ETIM 3.0	EC000796	ETIM 4.0	EC000796
ETIM 5.0	EC000796	ETIM 6.0	EC000796
UNSPSC	30-21-18-01	eClass 5.1	27-14-34-19
eClass 6.2	27-26-12-02	eClass 7.1	27-44-02-04
eClass 8.1	27-44-02-04	eClass 9.0	27-44-02-04
eClass 9.1	27-44-02-04		

**Approvals**

Approvals



ROHS Conform

**Downloads**

Brochure/Catalogue	<a href="#">CAT 3 HDC 17/18 EN</a> <a href="#">FL FIELDWIRING EN</a>
Engineering Data	<a href="#">EPLAN_WSCAD</a>

**Data sheet**

**Crimping contact  
HDC-C-HE-BM0.75-1.00AG**

**Weidmüller Interface GmbH & Co. KG**  
 Klingenbergstraße 16  
 D-32758 Detmold  
 Germany  
 Fon: +49 5231 14-0  
 Fax: +49 5231 14-292083  
 www.weidmueller.com

**Drawings**

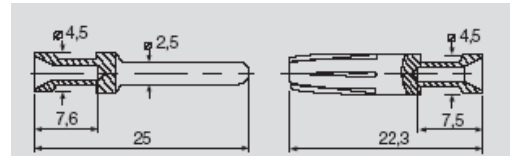

Leiterquerschnitt	Abisolierlänge	
0,50 mm <sup>2</sup>	AWG 20	7,5 mm
0,75 - 1,00 mm <sup>2</sup>	AWG 18	7,5 mm
1,50 mm <sup>2</sup>	AWG 16	7,5 mm
2,50 mm <sup>2</sup>	AWG 14	7,5 mm
4,00 mm <sup>2</sup>	AWG 12	7,5 mm

