

The supplier acknowledges that, with the acceptance of the drawing, he is in a position to manufacture the illustrated part in accordance with the drawing in reproducible form and series production. Through the selected manufacturing processes no impairments will arise in the material and structure which could subsequently lead to an impairment of the component. Verbal agreements over and above that are not valid. Deviations from this rule must be written and must be signed by the purchaser.

This drawing may not be copied, reproduced or made available to third parties in any way whatsoever without or prior written approval.

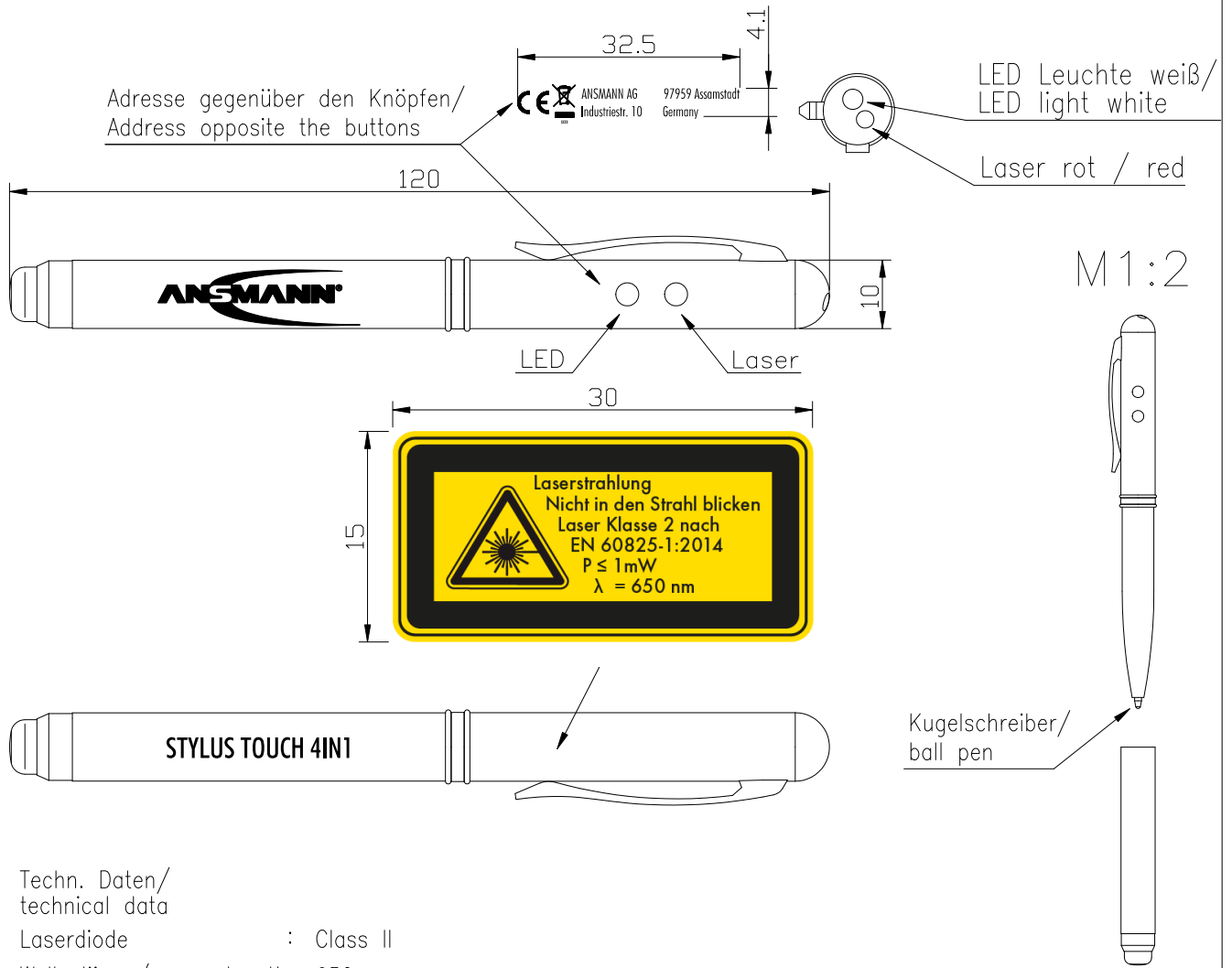

Techn. Daten/
technical data

- Laserdiode : Class II
- Wellenlänge/ wave length: 650nm
- Laser-Ausgangsleistung/ : weniger als/ 1mW, class II Product
laser output power less than
- Standard : EN60825-1: 2014
- Batterien/
batteries : 3x LR41 / SR41 Knopfzellen / coin cells
- Leuchtweite/
range : 100m
- Stifte/
pens : Stylus Stift – Kugelschreiber/
stylus pen – ball pen
- Gewicht/
weight : 24.5g inkl. Batterien/
24.5g incl. batteries
- Verpackung/
package : Blisterverpackt/
blister package
- Approbation/
approval : CE

Verwendungsbereich/Application range für Anfrage/for inquiry ANP201258				Zul. Abweichung/ Allowable deviation		Oberfläche/ Surface		Maßstab/Scale (DIN A4): 1:1(1:2)		Gewicht/Weight	
								Werkstoff/Work material, Modell-Nr.			
				2012		Datum/Date		Name		Zeichnungsname/Drawing name	
				Erstellt/ Drawn by		15.06.		SP		Touchscreen Stylus 4 in 1	
V3		laser sticker updated		12.03.18		SIT		<div style="display: flex; justify-content: space-between;"> <div style="text-align: center;">  </div> <div> Zeichnungsnummer/Drawing number Artikelnummer/Part number 1600-0028 </div> <div style="text-align: right;"> Blatt/ Sheet 1 </div> </div>			
V2		printing changed		16.01.15		SIT					
V1		date code changed and address added		24.01.14		CF					
V0		---		20.06.12		ML					
Version		Änderung/Change		Datum/Date		Name		Ursprung/Origin Proj. 053/19/12		Ersatz für/Replaced by	
										Ersatz durch/Replacement through:	