

# flat cylinder DZF-50-50-P-A

Part number: 164070

FESTO

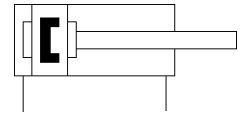
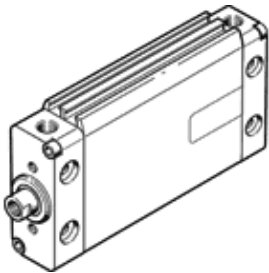

## Data sheet

| Feature                                     | Value   |
|---|---|
| Stroke                                      | 50 mm   |
| Piston diameter                             | 50 mm   |
| Max. angular deflection of piston rod +/-   | Equivalent diameter<br>0.5 deg  |
| Cushioning                                  | P: Flexible cushioning rings/plates at both ends                            |
| Assembly position                           | Any   |
| Mode of operation                           | double-acting   |
| Design structure                            | Piston<br>Piston rod  |
| Position detection                          | For proximity sensor  |
| Protection against torque/guide             | Oval piston   |
| Operating pressure                          | 1 ... 10 bar  |
| Operating medium                            | Compressed air in accordance with ISO8573-1:2010 [7:4:4]                    |
| Note on operating and pilot medium          | Lubricated operation possible (subsequently required for further operation) |
| Corrosion resistance classification CRC     | 2 - Moderate corrosion stress   |
| Ambient temperature                         | -20 ... 80 °C   |
| Max. torque for protection against rotation | 1.2 Nm  |
| Theoretical force at 6 bar, return stroke   | 990 N   |
| Theoretical force at 6 bar, advance stroke  | 1,178 N   |
| Moving mass with 0 mm stroke                | 219 g   |
| Additional weight per 10 mm stroke          | 64 g  |
| Basic weight for 0 mm stroke                | 854 g   |
| Additional mass factor per 10 mm of stroke  | 25 g  |
| Mounting type                               | Optional<br>with internal (female) thread<br>with accessories               |
| Pneumatic connection                        | G1/4  |
| Material cover                              | Wrought Aluminium alloy   |
| Material seals                              | NBR<br>TPE-U(PU)  |
| Material housing                            | Aluminium<br>Smooth anodised  |
| Material piston rod                         | High alloy steel  |