

DO NOT SCALE DRAWING

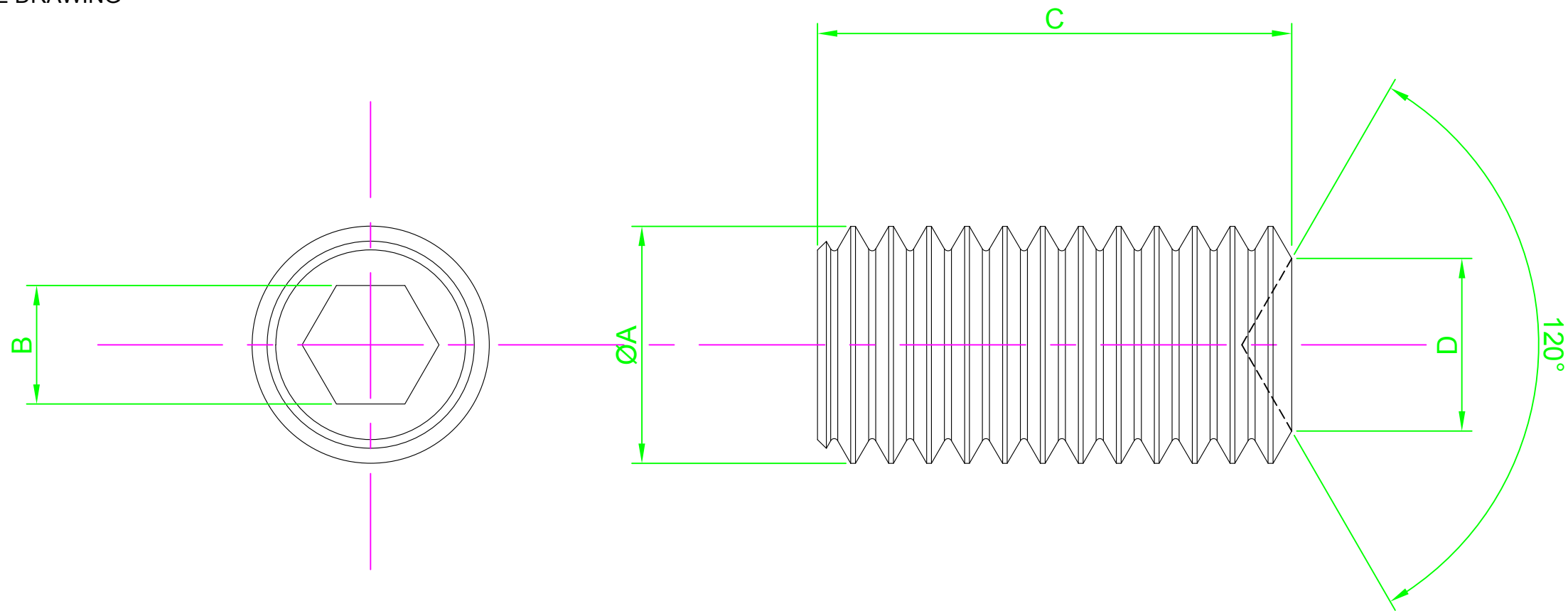

REVISION

A INITIAL DRAWING 12.01.16

Part Number	ØA	B Nom	C Length	D Max
M3 3 HSA2PC S50	M3-0.5	1.5	3.0	1.4
M3 6 HSA2PC S50			6.0	
M3 12 HSA2PC S50			12.0	
M4 4 HSA2PC S50	M4-0.7	2.0	4.0	2.0
M4 6 HSA2PC S50			6.0	
M4 12 HSA2PC S50			12.0	
M5 5 HSA2PC S50	M5-0.8	2.5	5.0	2.5
M5 8 HSA2PC S50			8.0	
M5 10 HSA2PC S50			10.0	
M5 12 HSA2PC S50			12.0	
M6 6 HSA2PC S25	M6-1.0	3.0	6.0	3.0
M6 8 HSA2PC S25			8.0	
M6 12 HSA2PC S25			12.0	
M6 16 HSA2PC S25			16.0	
M8 8 HSA2PC S25	M8-1.25	4.0	8.0	5.0
M8 12 HSA2PC S25			12.0	
M8 16 HSA2PC S25			16.0	

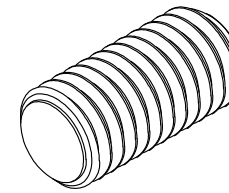

NOTES:



UNLESS OTHERWISE SPECIFIED:  
DIMENSIONS ARE IN MM (MILLIMETERS).  
SURFACE FINISH:  
TOLERANCES: DIN 916

MATERIAL:  
Stainless Steel A2

TITLE:  
Hex Socket Set Screw with Cup Point DIN916

	NAME	DATE
DRAWN	Darryl Wilson	12.01.16
CHK'D		
APPV'D		

HEAT TREATMENT:

DESIGN RIGHT. TR FASTENINGS LTD, 2003  
UNDER NO CIRCUMSTANCES MUST THIS  
DRAWING BE COPIED OR DISCLOSED  
WITHOUT FIRST OBTAINING WRITTEN  
AUTHORITY.

CUSTOMER PART NUMBER:  
N/A

FINISH:  
Self Finish

DRAWING NUMBER:  
TR32HSA2PC-S

A4

PROJECTION

