

TECHNICAL SPECIFICATIONS
D-Sub Hood:

Material: Zinc, Nickel Plated
 Operating Temperature: -40°C to +120°C
 Cable Entry: Side Entry
 Thumbscrews: UNC 4-40 (Standard)
 Cable O.D: Up to 11,5mm

Standard D-Sub Solder Cup:

Insulator: Glass filled TP, UL94 V-0
 Shell: Steel, Tin Plated
 Contact pins: Copper Alloy
 Gold Flash over Ni.
 Stamped & Formed Pins: Class 3, 100 inserts min.
 Contact Plating: Gold flash over Nickel
 Operating Temperature: -55°C to +85°C
 Withstanding voltage: >1000V Rms to 50 Hz for 1 minute
 Current Rating: 5A
 Insulator resistance: >5000MΩ min.

Features:

- Available in sizes 9-15-25-37
- 360° EMI Shielding
- Re-openable

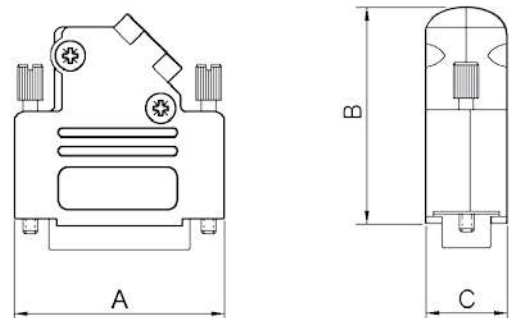

Grommet Sizes DTZK:

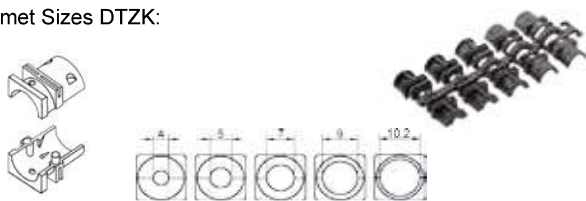

Size D45ZK	Dim A	Dim B	Dim C
9-way	31,0	36,3	14,5
15-way	39,5	40,3	14,5
25-way	53,2	40,3	14,5
37-way	69,7	40,3	14,5

Ordering information:
Standard D-Sub Connector Kits

Size:	P/N - Kitted:	Description:
9-way	L17D45ZK09+L717SDE09P	Solder Cup, 9-Male
15-way	L17D45ZK15+L717SDA15P	Solder Cup, 15-Male
25-way	L17D45ZK25+L717SDB25P	Solder Cup, 25-Male
37-way	L17D45ZK37+L717SDC37P	Solder Cup, 37-Male

Size:	P/N - Kitted:	Description:
9-way	L17D45ZK09+L77SDE09S	Solder Cup, 9-Female
15-way	L17D45ZK15+L77SDA15S	Solder Cup, 15-Female
25-way	L17D45ZK25+L77SDB25S	Solder Cup, 25-Female
37-way	L17D45ZK37+L77SDC37S	Solder Cup, 37-Female