



# Owner Instructions

Original Instructions  
Warning! Read instructions before using the machine



**HVB 160 Henry / HEB 160 Hetty**  
Numatic Lithium-Ion Battery Powered



[www.numatic.com](http://www.numatic.com)



## Kit - AS29E



### NOTE\*

Located in the bottom of your box is your Lithium-Ion Battery and charger

## Assembly



## Operating your machine for the first time

Your Battery will arrive in transportation mode. It is not possible to operate your Henry, until the battery is first placed on the charger.

It is recommended that a battery is fully charged before first use.



## Using your machine



Operating times  
 High Speed Setting = >20 mins  
 Low Speed Settings = >30 mins  
 @ room temperature

### Battery Vacuum State of Charge Indicator

Normal operation	Indicator show battery state of charge (SOC)
Recharging required	Indicator does not illuminate
Error Condition	Indicator flashes on / off

## Using your machine

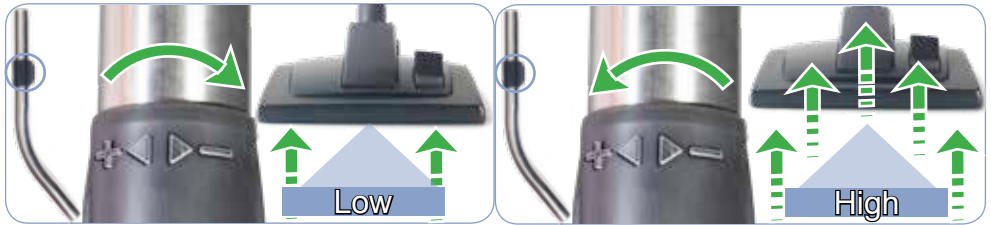

## Wand docking

## Tool Tidy



# Cleaning

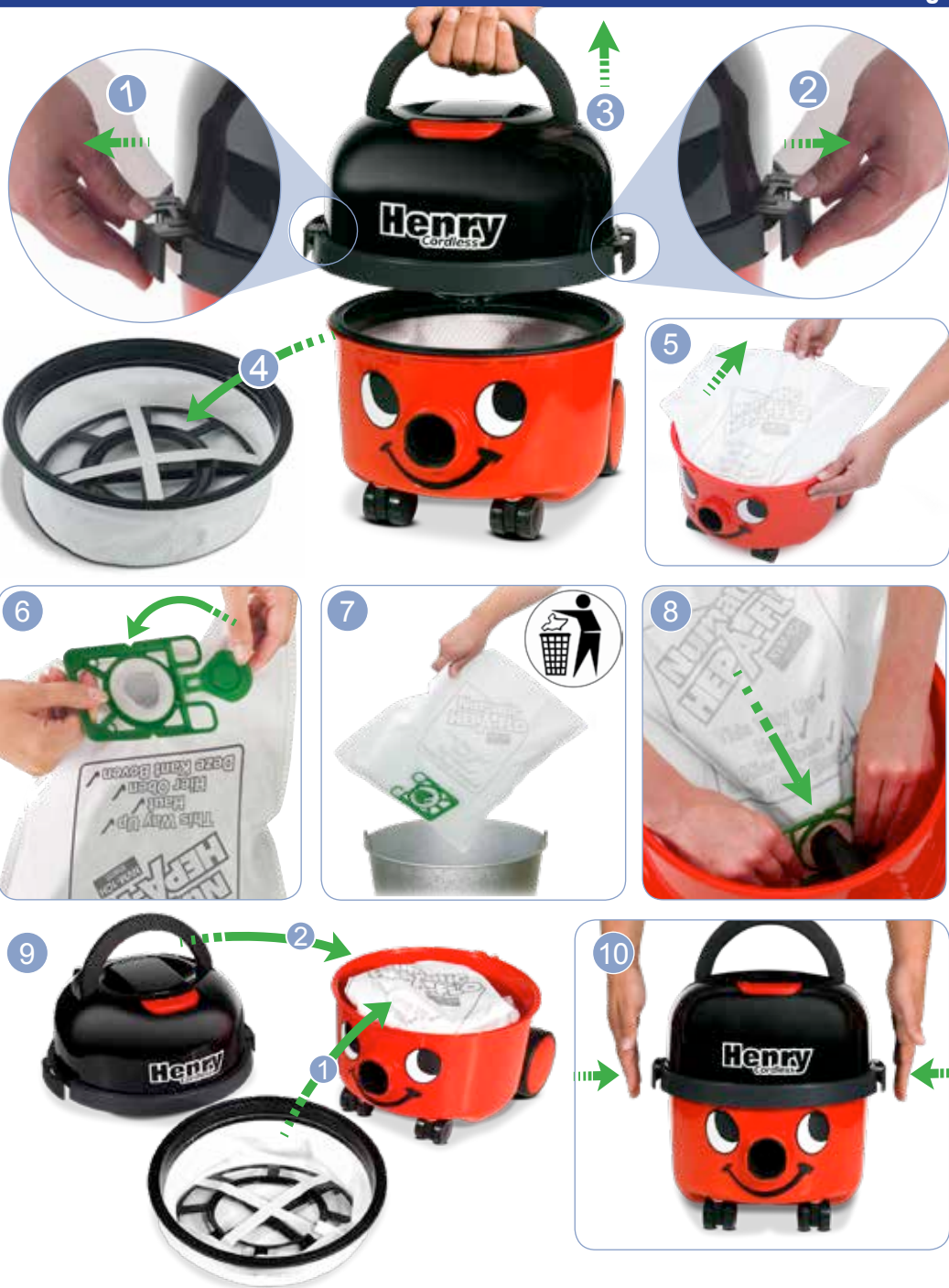

## Fitting the Face on

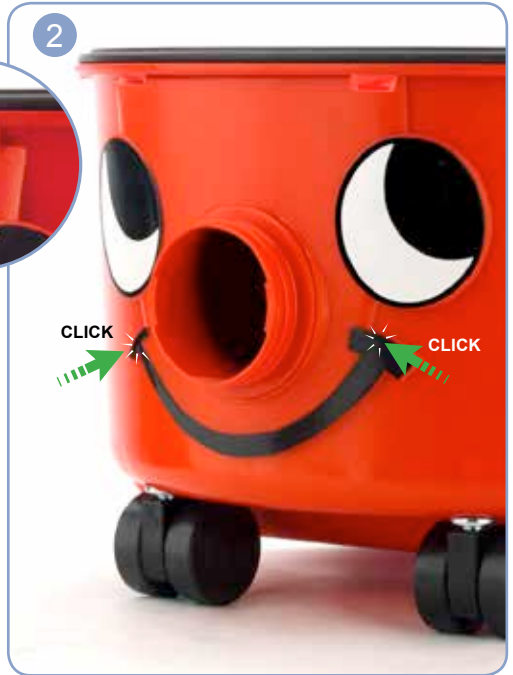

## Removing the Face



## Rating Label

- 1 Voltage
- 2 Power rating
- 3 Weight (ready to use)
- 4 Company Name & Address
- 5 Machine Description
- 6 Machine yr/wk Serial number
- 7 WEEE Logo
- 8 CE Mark



**PPE** (personal protective equipment) That may be required for certain operations.



Ear Protection



Safety Footwear



Head Protection



Safety Gloves



Eye Protection



Protective Clothing



Dust / Allergens Protection



Hi Viz Jacket



Caution Floor Sign

**NOTE:** A risk assessment should be conducted to determine which PPE should be worn.

## Safety Critical Components

Multi-Regional Charger (100-240V ~ 50/60Hz)

Lithium-Ion Battery 2.9Ah @ 4.2V/cell

## WEEE Legislation

**(Waste, Electrical and Electronic Equipment)**

Vacuum cleaner, accessories, Charger and packaging should be sorted for environmental-friendly recycling.

*(Only for EU Countries)*

Do not dispose of vacuum cleaner into household waste! According to the European Directive 2012/19/EU on waste electrical and electronic equipment and its incorporation into national law.

Vacuum cleaners that are no longer suitable for use must be separately collected and sent for recovery in an environmental-friendly manner.



### Daily:-

Keep the machine clean, including hoses and tubes. Ensure the dust bag and filter are fitted. Regularly examine the charger. Check dust bag frequently. Check the filter is clean.

### Weekly - as daily and:-

Check for any worn or damaged parts and replace immediately. Do not steam clean or pressure wash.

### Batteries:-

Always recharge the batteries after use.

## Information for DRY USE Vacuum cleaners



### WARNING

#### Ensure you read the instruction manual before using the appliance.

Operators shall be adequately instructed on the use of these appliances, as with all electrical equipment, care and attention must be exercised at all times during use, you must also make certain that routine and preventative maintenance is carried out periodically to ensure safe operation.

Failure to carry out maintenance as necessary, including the replacement of parts to the correct standard could render this equipment unsafe and the manufacturer can accept no responsibility in this respect.

#### This appliance is for DRY USE only.

You must remove the battery from the machine BEFORE cleaning or maintenance and when replacing parts.

This appliance is intended to be assembled, cleaned and maintained by an adult.

This appliance is not suitable for the collection of biological hazards, hazardous or explosive dusts.

Contact your local distributor if you require an appliance capable of performing these tasks.

This device may be used by children of 8 years of age and over, as well as by persons with reduced physical, sensory or mental abilities, or lack of experience and knowledge when supervised or instructed regarding the safe use of the device and the resulting dangers.

Children must not play with the appliance. Cleaning and user maintenance must not be carried out by children without supervision.



### CAUTION

This appliance must not be stored outside, or used in wet environments, or to collect wet materials.

The vacuum cleaner should be stored in a dry place and is for indoor use only.

You must ensure that the filtration system fitted to the appliance is suitable for the material being collected.

### NOTES

This appliance complies with the requirements of IEC/EN 60335-2-69, IEC 60335-2-2

This appliance is suitable for commercial use, for example in hotels, schools, hospitals, factories, shops and offices.

If the vacuum cleaner stops working, remove the battery from the appliance before investigating where the fault lies.

Failure to rectify the problem or in the event of a breakdown contact your Numatic dealer or the Numatic Technical helpline +44 (0)1460 269268.

World Wide Lithium-Ion Battery Technical Helpline +1-703-741-5970

If the vacuum cleaner has a blockage, switch off, remove the battery from the appliance, and inspect the floor tool, wands and hose for debris. If the floor tool, wands and hose are clear, replace the dust bag and clean the filter.

This appliance is equipped with a thermal cut-out to protect the motor and other vital appliance parts from overheating.

The vacuum cleaner should be inspected after use for damage.

The size and quality of the dust bag and filters affect the machine efficiency.

Use of non-original dust bags or non-original filters can cause restricted air flow which may lead to appliance overload.



### DO

- Keep your appliance clean.
- Fully charge battery before first use.
- Keep the filter clean.
- Use dust bags, they will enhance performance and help keep appliance clean.
- Use a Numatic Original dust bags under fine dust conditions.
- Keep hoses and tubes clear.
- Replace any worn or damaged parts immediately.
- Change dust bag frequently.
- Keep diffuser filter (where fitted) clean.
- **Remove battery from appliance when not in use.**







- Use to suck up hot ashes, lighted cigarette ends or flammable gases.
- Use steam cleaners, pressure washers or immerse in water to clean the appliance.
- Attempt appliance maintenance or cleaning unless the battery has been removed from the appliance.
- Use or store in a wet environment or to collect wet materials.

**DO NOT**

## Important Warnings – Batteries

***Read all the warnings before using the battery.***

This cleaner uses Numatic Lithium-Ion batteries. Used batteries should be disposed of safely and placed in a sealed plastic bag and then handled according to all locally approved precautions and environmental regulations.

- a) Do not dismantle, open or shred secondary cells or batteries. 
- b) Do not expose cells or batteries to heat or fire. Avoid storage in direct sunlight
- c) Do not short-circuit a cell or battery. Do not store cells or batteries haphazardly in a box or drawer where they may short-circuit each other or be short circuited by other metal objects.
- d) Do not remove a cell or battery from its original packaging until required for use.
- e) Do not subject cells or batteries to mechanical shock.
- f) In the event of cell leaking, do not allow the liquid to come in contact with the skin or eyes. If contact has been made, wash the affected area with copious amounts of water and seek medical advice.
- g) Do not use any charger other than that specifically provided for use with the appliance.
- h) Observe the plus (+) and minus (-) marks on the cell, battery and appliance and ensure correct use.
- i) Do not use any cell or battery which is not designed for use with the appliance.
- j) Seek medical advice immediately if a cell or battery has been swallowed.
- k) Use only original NUMATIC batteries, when replacement batteries are required.
- l) Keep cells and batteries clean and dry.
- m) Secondary cells and batteries need to be charged before use.
- n) Do not leave a battery on prolonged charge when not in use.
- o) After extended periods of storage, it may be necessary to charge and discharge the cells or batteries several times to obtain maximum performance.
- p) Retain the original appliance literature for future reference.
- q) When possible, remove the battery from the equipment when not in use. 
- r) Do not immerse in any liquid.
- s) Do not charge damaged batteries.
- t) If the batteries or cells are leaking, return batteries to a disposal plant or a similar local facility.
- u) The batteries must be removed from the appliance before the appliance is scrapped.

The battery is equipped with electronic thermal protection, refer to the **Temperature Range Table** below for recommended operating conditions.

### Temperature Range Table

Storing	+5 ... +35 °C
Discharge	+5 ... +35 °C
Charge	+5 ... +35 °C
Shipment	-40 ... +80 °C
Humidity	10 ... 90% RH no condensation

In case battery is subject to environmental conditions outside the above parameters user must allow at least 3 hours for battery to acclimatise at room temperature before attempting to operate.

If the battery is found to be faulty at any time, contact Numatic International, or World Wide Lithium-Ion Battery Technical Helpline +1-703-741-5970

## Care and Disposal of Li Ion Batteries

### DEFECTIVE BATTERIES



#### ATTENTION

Please follow all safety guidelines set out.

**A defective battery should not be stored inside buildings on any account.**



- If a customer wishes to return a battery to a supplier, then collection of the battery must be arranged by the supplier, however, **Faulty batteries must not be returned through the postal system or by courier.**
- If on return to a supplier, OR at a customer base, a suspected defective battery shows any signs of impact damage, distortion, blistering, loose parts or leakage then on no account should it be offered for condition checking. It must be considered defective and the procedures described followed.
- If, on return to a supplier, OR at a customer base, a suspected defective battery, that shows No signs of impact damage, distortion, blistering, loose parts or leakage, may be offered for condition checking with an appropriate battery condition checking device operated by a competent person.
- If on checking the battery is found to be operational then a single recharge cycle under observation can be attempted with the appropriate Numatic charger.
- If the battery recharges correctly on this single recharge cycle then it can be deemed a good battery.
- If the battery fails to recharge correctly on this single recharge cycle then it must be deemed a defective battery and the procedures followed.
- **On no account must any further attempt to recharge be made.**
- **A defective battery should not be stored inside buildings on any account.**
- The defective discharged battery can then be stored in a locked battery waste container which should be plastic or plastic lined and placed away from buildings and clearly signed as a defective battery container with appropriate warnings.

The battery is to be disposed of safely and in accordance with all locally approved precautions and environmental regulations.

## Charging the battery



Brand Name: Numatic  
Type: Charger 903227

### Charger Status Indications

The charger is equipped with a double colour LED's to indicate the status of the charger and battery.

CHARGE INDICATOR	STATUS
Green Continuously On	Charge Complete
Green Flashing Without Pause	Charger in Standby
Red Continuously On	Charging
Red Flashing Without Pause	Preparing to Charge
ERROR INDICATOR	STATUS
1 Red Flash With Pause	Battery Fault
2 Red Flashes With Pause	Charger Over Temperature
3 Red Flashes With Pause	Charger Fault

#### NOTE\*

Your Battery will arrive in transportaion mode, to preserve shelf life.  
It is not possible to operate (discharge) the battery until the battery is placed on the charger.  
It is recommended that a battery is fully charged before first use.

## Important Warnings – Charger

### Read all these warnings before using the charger.

- **CAUTION!** Charge only Numatic Lithium-Ion batteries, other types of batteries may burst causing personal injury and damage.
- Check the mains cord regularly for any sign of damage. If the mains cord of the charger is damaged, it must be replaced by an original NUMATIC INTERNATIONAL cord available from the manufacturer or service agent.
- Do not use damaged devices.
- Protect the charger against moisture and store it in a dry place.
- Do not use the charger if it is wet.
- The mains voltage available must correspond to the voltage stated on the rating plate of the charger.
- Do not operate charger in explosive environment.
- Do not carry the charger by holding the mains cord.
- Do not handle the electrical cord or plug, with wet hands.
- Do not unplug by pulling on cord. To unplug, grasp the plug, not the cord.
- Do not cover the charger.
- Do not open the charger. Repairs shall be done only by authorised personnel.
- Do not charge damaged batteries.
- Do only charge dry batteries.
- Do not charge non-rechargeable batteries in this charger.

#### Warning:

The battery included in this product must only be charged by the Numatic Charger supplied with the product under NO circumstances should an alternative non Numatic charger be used as there is risk severe damage and fire could result. Only use genuine Numatic parts.

## Instructions for Use – Charging Batteries

The charger is intended for use only on flat surfaces, place horizontally on floor or work surface. The charger is intended for use with the power cord supplied, the power unit is capable of operating at different voltages without user adjustment.

If your charger is fitted with a non detachable cable this can only be changed by an authorized service partner.

Make sure cable replacements are a genuine Numatic service part.

If the charger is damaged or does not charge anymore, do not use and contact your supplier.

#### **Charging Procedure:**

1. Ensure the battery is fully inserted into the charger.
2. Fit the mains power cord to charger and suitable power supply.
3. Charger Status Lights table, (see page 11).

## Hazards

### **Health Hazards (Acute & Chronic).**

The chemicals used in the battery are in a sealed container.

Risk of exposure only occurs if the battery is abused or damaged.

Contact of electrolyte and lithium with skin and eyes should be avoided.

### **Signs & Symptoms of Exposure.**

A damaged or leaking battery can cause chemical burns upon contact.

## First Aid Measures

If exposed to any of the Chemicals mentioned in the Hazards section please follow the procedures below:

**Eyes.**

Flush eyes with plenty of water for at least 15 minutes, occasionally lifting the upper and lower eyelid.

Seek medical attention.

**Skin.**

Remove contaminated clothing and rinse skin with plenty of water or shower for 15 minutes.

Seek medical attention.

**Inhalation.**

Vacate from site of exposure to fresh air immediately. Use oxygen if available.

**Ingestion.**

Give at least two glasses of milk or water. Induce vomiting unless patient is unconscious.

Seek medical attention.

**Note:**

Inhalation, skin contact and eye contact are possible if the battery is damaged.

Exposure to internal contents, the corrosive fumes will be very irritating to skin, eyes and mucous membranes.

Overexposure can cause symptoms of non-fibroid lung injury and membrane irritation.

## Spare Parts

902928	Lithium-Ion Battery
903245	Charger UK (Hard Wired)
604015	NVM - 1CH HepaFlo Dust bags x 10
901607	11" TriTex Filter

## Data

Drum Size	Operating Times	Weight (Ready to work)	Protection Class
6 L	Hi = >20 mins Lo = >30 mins	6.88 kg	Class III
Sound Pressure		Size	
Hi = 64.5 dB (A) Lo = 62.6 dB (A) Uncertainty 0.5 dB		315 x 340 x 345 mm	



**For best performance make  
sure you use  
genuine Numatic bags**

**604015 NVM-1CH (pack of 10)**

## Schematic Diagram

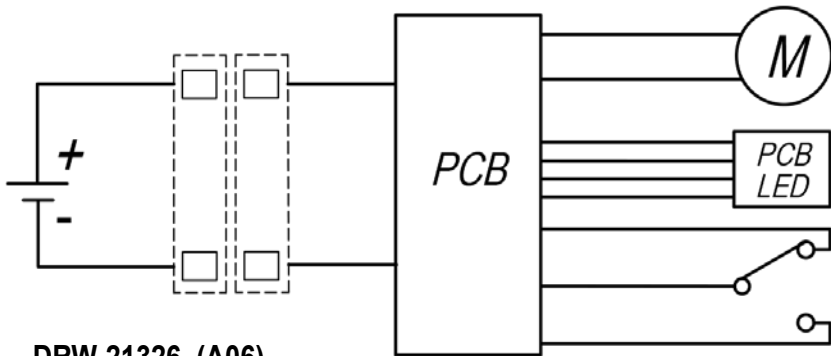

DRW-21326 (A06)

## Declaration of conformity

**CE** 16

**EU DECLARATION OF CONFORMITY**

We hereby declare under our sole responsibility that the following equipment fulfils all the relevant provisions of the following EU Directives

---

Machinery Directive 2006/42/EC  
EMC Directive 2014/30/EU  
RoHS Directive 2011/65/EU

---

Machine Description: Vacuum Cleaner  
Machine Type: HVB, HEB Series.

Relevant standards upon which conformity is declared include:

---

EN 60335-1: 2012 + A11:2014  
EN 60335-2-69: 2012  
EN 55014-1: 2006 + A1:2009 + A2:2011  
EN 55014-2: 1997 +A1:2001 + A2:2008  
EN 62233: 2008

---

A technical construction file for this equipment is retained at the manufacturer's address under the authorisation of the following signatory:

Name: Aliyn Boyes Position: Development Manager

Signed  Date 21/11/16

 Numatic International Ltd  
Chard Somerset  
TA20 2GB  
www.numatic.co.uk

**GB**

# Numatic International Warranty

Numatic International Limited warrant to the original purchaser that its products are free of defects in both material or workmanship for the period shown below:-

Homecare and Cleancare Vacuum cleaners.....	2 Years
Rotary Floor Machines.....	2 Years
Twintec Auto Scrubber Dryer.....	1 Year
Vario Ride-On Scrubber Dryer.....	1 Year / 1500 hours
Mopping, Compacts, Combi and Servocare Products.....	1 Year
Individual Accessories and Spare Parts.....	6 Months

*Note: This warranty expressly excludes consumable parts such as carbon brushes, floor brushes, ropes, batteries etc. that are considered replaceable from time to time during the normal working life of the machine.*

*Using non Numatic dustbags can be detrimental to both machine performance and life and may invalidate the Warranty.*

- A. The warranty period commences from the date the goods are purchased.*
- B. All warranty claims must be processed through the Dealer from whom the equipment was purchased. The Dealer will co-operate with the purchaser throughout the warranty claims procedure and will arrange any necessary repairs using genuine Numatic parts.*
- C. If the original Dealer is no longer able to fulfil his obligations please contact Numatic International Limited with full details of the claim and proof of purchase so that this may be processed without delay.*
- D. Any warranty claim can only relate to the specific part that is proven to be at fault and for which a replacement will be supplied but cannot be extended to constitute a claim against the complete machine.*
- E. Numatic International will supply the Dealer with any warranty parts required, subject to the claim being validated, after return of the faulty items in accordance with Numatic International Limited's General Conditions of Sale.*
- F. Claims will not be accepted if they are the result of fair wear and tear, misuse or abuse of any kind.*
- G. No replacement will be given unless the appropriate evidence of the validity of the claim has been provided to the satisfaction of Numatic International Limited.*
- H. Numatic International Limited reserve the right to charge for any unnecessary work carried out as a result of an invalid claim.*
- I. No variation to this warranty may be made or implied by any member of Numatic International Limited or its Dealers unless such variation is in writing and authorised by the Company*



Numatic International Limited, Chard, Somerset, TA20 2GB

Telephone: 01460 68600 Fax: 01460 68458

© Numatic International Limited

## Lithium - Ion Battery Warranty.

Numatic International will guarantee your Numatic Lithium - Ion battery for 500 recharging cycles, providing the cycles have been carried out to the manufacturer's specifications and requirements.

Failure to use the correct Numatic charger will void your warranty.

# HVB 160 / HEB 160



Distributed by:-



Numatic International Limited,  
Chard, Somerset, TA20 2GB

Telephone: 01460 68600  
Fax: 01460 68458

Subject to change without prior notice.

UNITED KINGDOM: [www.numatic.co.uk](http://www.numatic.co.uk) GERMANY: [www.numatic.de](http://www.numatic.de)

SWITZERLAND: [www.numatic.ch](http://www.numatic.ch) FRANCE: [www.numatic.fr](http://www.numatic.fr)

NETHERLANDS: [www.numatic.nl](http://www.numatic.nl) PORTUGAL: [www.numatic.pt](http://www.numatic.pt)

SOUTH AFRICA: [www.numatic.co.za](http://www.numatic.co.za)

[www.numatic.co.uk](http://www.numatic.co.uk) © Numatic International Limited  
905666 03/18 (A05)