

# TWO-SHOT PLASTIC COMPONENTS

Manufactured with a Thermoplastic Substrate and a Thermoplastic Elastomer Rubber



## FEATURES

- ▶ Non-slip, comfortable grip
- ▶ Modern design that is durable and resistant to scratches
- ▶ Molded with a soft thermoplastic overmolded "rubber" top with a tough thermoplastic substrate
- ▶ Female insert, plain molded hole, and spring mounting options are available
- ▶ Variety of sizes, styles, and color combinations
- ▶ Custom finishes, including logo printing, available
- ▶ [View full product offerings at www.daviesmolding.com](http://www.daviesmolding.com)

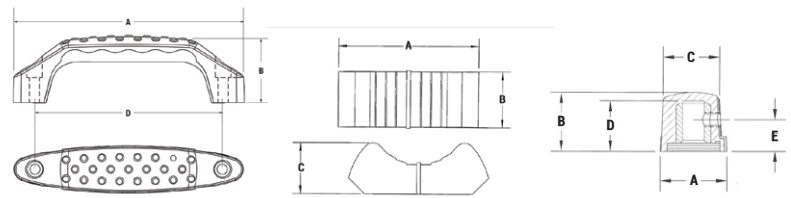

Category	Size Range	Styles
Clamping Knob	1.38"-3.42" 44.5mm	Four Arm, Five Arm (Star)
Control Knob	.45"-1.89" 11mm-41mm	Instrument, Skirted, Slide
Pull Handle	5.75"-6.71"	Two-Point