



Power connector for device supply

Features

- HARTING PushPull technology
- Compact design
- Finger safe contact design
- Cable side: female
 - Crimp termination
 - Han-Quick Lock® termination technology
 - Field assembly without special tools
- Device side: male
 - Solder variant, angled

Technical characteristics

Locking system	PushPull technology
Protection degree	IP 65 / IP 67
Number of contacts	4 + PE
Electrical data	16 A 230/400 V 4 kV 3
accd. to DIN EN 61 984	
Cable diameter	9 - 13 mm
Termination	Crimp (Han® P contacts)
Wire gauge	0.5 - 2.5 mm ²
Termination	Han-Quick Lock®
Wire gauge	0.5 - 2.5 mm ²
Material of housing	Plastic, black
Flammability according to UL 94	V 0

Identification	Part-Number	Drawing	Dimensions in mm
----------------	-------------	---------	------------------

Components device side
Han® PushPull Power 4/0
bulkhead mounted
housing

09 35 002 0323

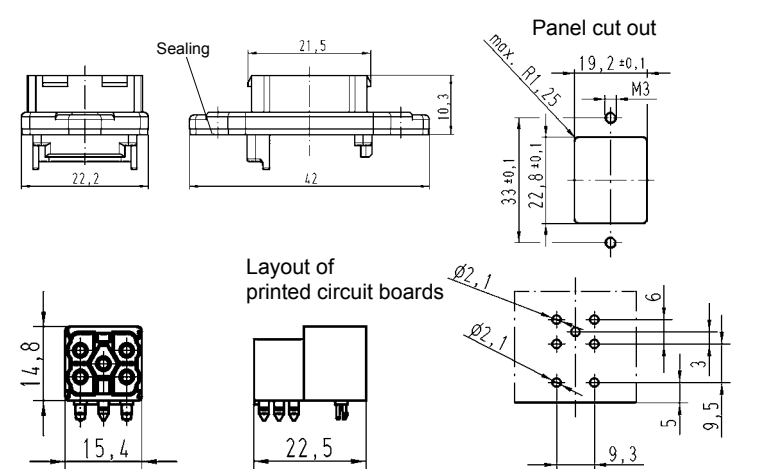

Male insert

solder variant,
90° angled

09 35 002 3003

Crimp contacts Han® P

female, silver plated

- for 0.5 mm²
- for 0.75 mm²
- for 1.0 mm²
- for 1.5 mm²
- for 2.5 mm²

09 35 000 6203
09 35 000 6204
09 35 000 6205
09 35 000 6206
09 35 000 6207

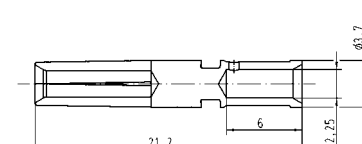

Locator Han® P

for crimping tool 09 99 000 0001

09 99 000 0329

Removal tool for Han® P

09 99 000 0319





Connector set

Identification	Part-Number	Drawing	Dimensions in mm
Cable side including hood and female insert with crimp termination order Han® P crimp contacts separately	09 35 231 0423		
Cable side including hood and female insert with Han-Quick Lock® termination 	09 35 232 0423		
Device side including hood and male insert with solder termination, angled	09 35 233 0323		

Assembly manual

Han-Quick Lock®

Assembly

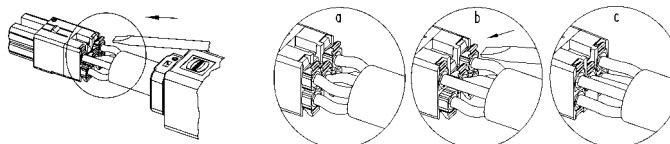

Attention: While pushing the slide, please continue to push wire into the contact chamber.

Removal

