

Electrical / Environmental

HM36

High Current Low Profile Low Loss Ferrite
Surface Mount Inductors

- Operating Temperature Range -40°C to +130°C



Schematic

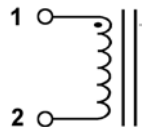

Specifications @ 25°C / Packaging

Part Number	Inductance 100 kHz, 0.1 V		$I_{sat}^{(1)}$ (A _{dc})	DC Resistance		Height 'C' mm Max.	13" Reel Qty Units
	@ 0 A $\mu H \pm 10\%$	@ I_{sat} μH Typ.		m Ω Typ.	m Ω Max.		
HM36-1211R95LF	0.95	0.80	12.0	1.06	1.40	5.65	600
HM36-12111R0LF	1.00	0.92	25.0	1.40	1.70	6.50	600
HM36-12111R4LF	1.40	1.30	20.0	1.40	1.70	6.50	600
HM36-12111R5LF	1.50	1.40	18.0	1.80	2.20	5.60	600
HM36-12113R6LF	3.60	3.42	12.0	3.00	3.50	7.50	500
HM36-1311R95LF	0.95	0.80	25.0	1.20	1.40	5.65	600
HM36-13111R4LF	1.40	1.25	22.0	1.60	1.80	5.95	600
HM36-13112R4LF	2.40	2.10	16.5	2.40	3.20	5.95	600
HM36-13116R0LF	6.00	5.20	10.0	4.60	4.92	8.00	400

Notes: (1) The saturation current (I_{sat}) is the approximate current at which inductance will be decreased by 20 % from its initial (zero DC) value.

Outline Dimensions (mm)

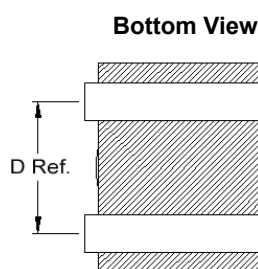
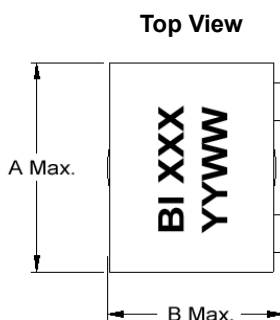

Recommended Solder Pad Layout

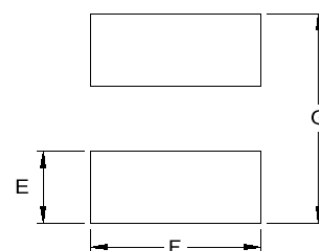

Side View

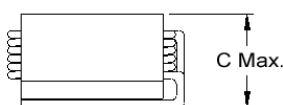

Case Size	A	B	D	E	F	G
1211	12.5	10.5	7.3	2.9	10.5	10.2
1311	13.1	11.2	8.1	4.0	10.4	12.8

Refer to Specifications table for 'C' dimension of each model.

Electrical Characteristics @ 25°C

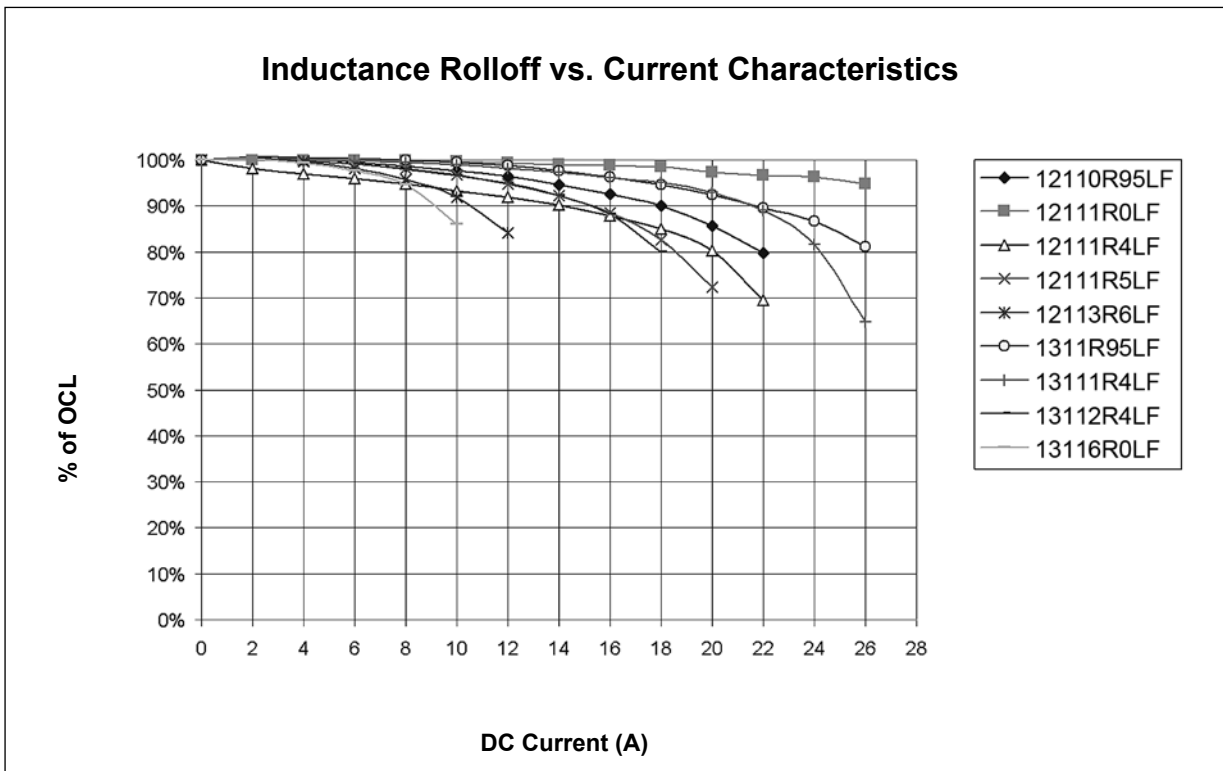
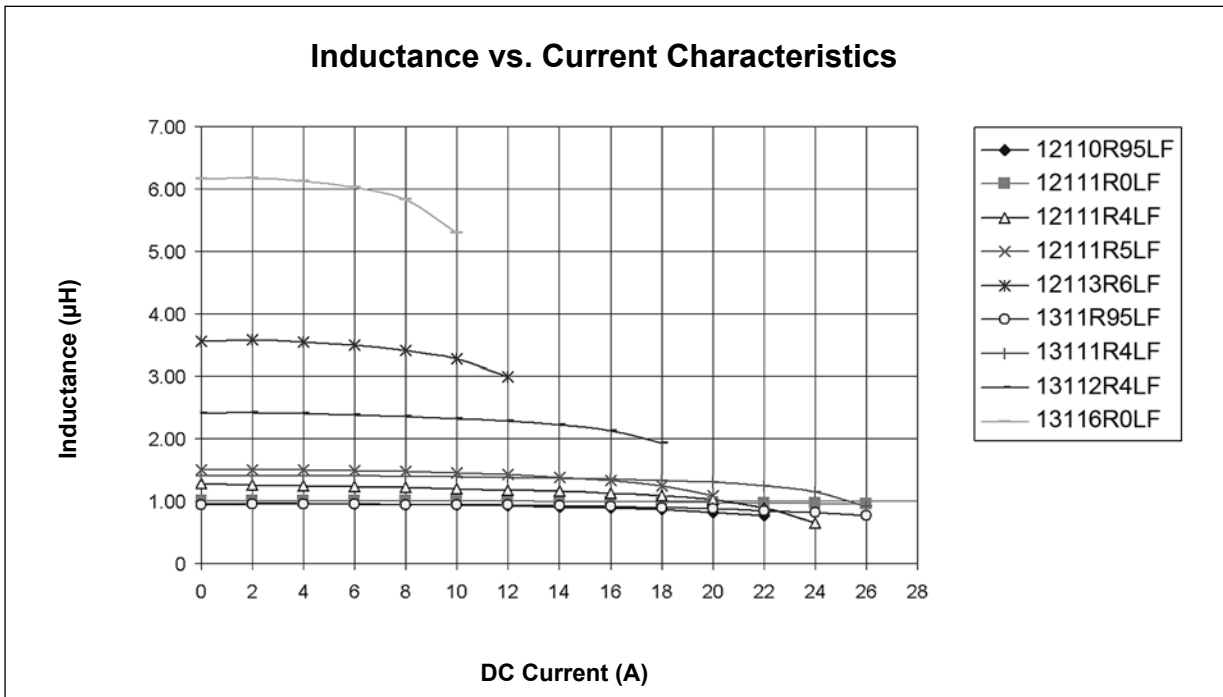

Ordering Information

