

# DC Tubular Solenoid



## Model T8x16

### Features:

- High performance construction
- Available return spring kit
- DC solenoid applications only
- See TP8x16 for push application
- UL recognized



### Electrical:

- Coil Voltages: 6, 12, 24, 48, 110 VDC standard
- Coil Termination: 6.5" Wire leads  
22 AWG (standard)
- Duty Cycle: 100% Continuous, 25% Intermittent,  
10% Intermittent, 1% Pulse
- Coil treatment: Tape Wrapped
- Insulation Class: Class A Rating - 105°C (221°F)
- Dielectric Strength: 1500V 60 Hz

### Mechanical:

- Size: 2" (L) x 1" (D)
- Plunger Diameter: 0.437
- Plunger Guide Material: Plastic
- Mounting: Hex Nut
- Weight: Plunger 1.6 oz, Total 5.8 oz
- Life Expectancy: 1 Million Cycles<sup>1</sup>

<sup>1</sup> - Dependent on load conditions

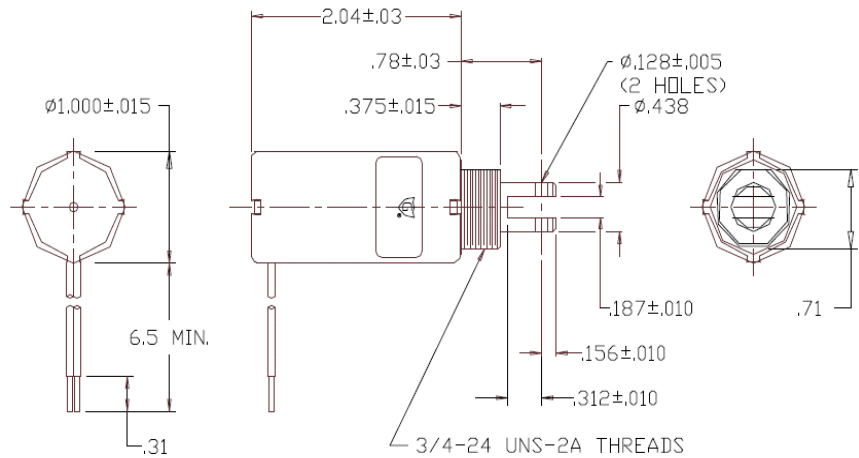

Solenoid shown energized with plunger fully seated  
Supplied with mounting bracket, hex nut and lock washer shipped loose

### Standard Part Numbers

Model	Part Number	Duty Cycle	Voltage	Resistance <sup>2</sup> (Ω)	Power (W)	Current
T8X16-C-12D	A420-066642-00	Cont.	12VDC	28.3	5.3	424 mA
T8X16-L-12D	A420-066643-00	Inter.	12VDC	9.3	16.3	1.29 A
T8X16-C-24D	A420-066644-00	Cont.	24VDC	110	5.5	218 mA
T8X16-L-24D	A420-066645-00	Inter.	24VDC	36.1	16.8	665 mA

<sup>2</sup> - Coil resistance tolerance +/- 5%

Contact us for custom voltages or duty cycles

### Available Customization:

- Plunger
  - Lead and Connector
  - DC Voltage
  - Duty Cycle
  - Insulation systems up to class H 180° C (356° F)
- \* Minimum quantities apply

Stroke (in.)	Typical Pull Force Ounces [N] @ 20°C (68°F) (Distance from fully seated position)									HOLDING FORCE Ounces [N]	Power (W)
	0.050	0.125	0.250	0.375	0.500	0.625	0.750	1.000			
Continuous 100%	30 [8.3]	18 [5]	11 [3.1]	5 [1.4]	4 [1.1]	3 [0.8]	2 [0.6]	N/A	103 [28.6]	5.4	
Intermittent 25%	60 [16.7]	40 [11.1]	25 [7]	19 [5.3]	15 [4.2]	10 [2.8]	8 [2.2]	N/A	125 [34.8]	16.5	
Intermittent 10% <sup>3</sup>	93 [25.9]	68.5 [19]	50 [13.9]	41.5 [11.5]	31.5 [8.8]	28.5 [7.9]	25 [7]	17 [4.7]	261 [72.6]	83	
Pulse 1% <sup>3</sup>	118 [32.8]	95 [26.4]	75 [20.9]	63 [17.5]	55 [15.3]	50 [13.9]	43 [12]	32 [8.9]	N/A	130	

Continuous Duty 100% = 100% On Time  
Intermittent Duty 25% = 25% On Time (100 Sec On Max 300 Sec off)  
Intermittent Duty 10% = 90% On Time (10 Sec On Max 90 Sec off)  
Pulse Duty 1% = 99% On Time (1 Sec On Max 99 Sec off)  
<sup>3</sup> - Calculated force values to be verified in application

### Optional Return Spring Kit

A490-367460-02



**GUARDIAN-ELECTRIC.COM**

1425 Lake Ave - Woodstock IL 60098 - Phone: 800-762-0369  
The information is subject to change without notice. © Guardian Electric

