

DC Tubular Solenoid



Model T8x9

Features:

- High performance construction
- Available return spring kit
- DC solenoid applications only
- See TP8x9 for push application
- UL recognized

Electrical:

- Coil Voltages: 6, 12, 24, 48, 110 VDC standard
- Coil Termination: 6.5" Wire leads
26 AWG (standard)
- Duty Cycle: 100% Continuous, 25% Intermittent,
10% Intermittent, 1% Pulse
- Coil treatment: Tape Wrapped
- Insulation Class: Class A Rating - 105°C (221°F)
- Dielectric Strength: 1500V 60 Hz

Mechanical:

- Size: 1.13" (L) x 1" (D)
- Plunger Diameter: 0.937
- Plunger Guide Material: Plastic
- Mounting: Hex Nut
- Weight: Plunger 1 oz, Total 3.5 oz
- Life Expectancy: 1 Million Cycles¹

¹ - Dependent on load conditions

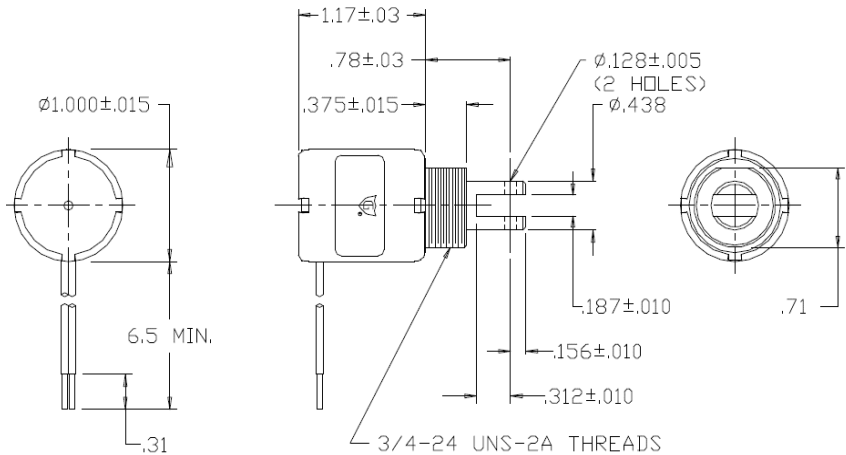

Standard Part Numbers

Model	Part Number	Duty Cycle	Voltage	Resistance ² (Ω)	Power (W)	Current (mA)
T8x9-C-12D	A420-066652-00	Cont.	12VDC	35.5	4.3	228 mA
T8x9-I-12D	A420-066653-00	Inter.	12VDC	10.9	13.9	1.1 A
T8x9-C-24D	A420-066654-00	Cont.	24VDC	135	4.5	178 mA
T8x9-I-24D	A420-066655-00	Inter.	24VDC	44	13.7	545 mA

² - Coil resistance tolerance +/- 5%

Contact us for custom voltages or duty cycles

Solenoid shown energized with plunger fully seated
Supplied with mounting bracket, hex nut and lock washer shipped loose

Available Customization:

- Plunger
 - Lead and Connector
 - DC Voltage
 - Duty Cycle
 - Insulation systems up to class H 180° C (356° F)
- * Minimum quantities apply

Stroke (in.)	Typical Pull Force Ounces [N] @ 20°C (68°F) (Distance from fully seated position)						HOLDING FORCE Ounces [N]	Power (W)
	0.050	0.125	0.250	0.375	0.500			
Continuous 100%	20 [5.6]	10 [2.8]	4 [1.1]	1 [0.3]	0.5 [0.1]	96 [26.7]	4.5	
Intermittent 25%	42 [11.7]	30 [8.3]	15 [4.2]	6 [1.7]	2 [0.6]	128 [35.6]	14	
Intermittent 10% ³	95 [26.4]	70 [19.5]	42 [11.7]	25 [7]	12 [3.3]	241 [67]	40	
Pulse 1% ³	144 [40]	120 [33.4]	80 [22.2]	46 [12.8]	26 [7.2]	N/A	100	

Continuous Duty 100% = 100% On Time
Intermittent Duty 25% = 25% On Time (100 Sec On Max 300 Sec off)
Intermittent Duty 10% = 10% On Time (10 Sec On Max 90 Sec off)
Pulse Duty 1% = 1% On Time (1 Sec On Max 99 Sec Off)
³ - Calculated force values to be verified in application

Optional Return Spring Kit

A490-367460-03



GUARDIAN-ELECTRIC.COM

1425 Lake Ave - Woodstock IL 60098 - Phone: 800-762-0369
The information is subject to change without notice. © Guardian Electric

