

EAO – Your Expert Partner for Human Machine Interfaces

704.064.2 - Stop switch actuator

704.064.2 - Stop switch actuator

Attention: The preview is based on a sample product. This can differ from your current configuration.

Mounting

| | |
|------------------|-----------|
| Mounting cut-out | Ø 22,3 mm |
| Design | raised |

Front

| | |
|-----------------|---------|
| Front shape | round |
| Front dimension | Ø 37 mm |

Other Attributes

| | |
|---------|----------|
| Marking | Arrows |
| Weight | 0,300 kg |

Operating-/Indication part

| | |
|-------------------|------------------|
| Lens material | Plastic |
| Lens optics | opaque |
| Lens profile | Mushroom |
| Lens colour | red |
| Lens illumination | non-illuminative |

IP-Rating

| | |
|------------------|------|
| Front protection | IP65 |
|------------------|------|

Actuator

| | |
|------------------|------------|
| Switching action | Maintained |
| Housing colour | yellow |
| Housing material | Plastic |

Switching element

| | |
|-----------------------------------|---|
| max. number of switching elements | 3 |
|-----------------------------------|---|

Function

| | |
|-------------|--|
| Stop switch | |
|-------------|--|

EAO – Your Expert Partner for Human Machine Interfaces

704.064.2 - Stop switch actuator

Dimensions

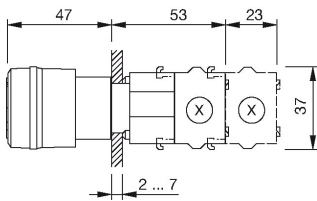

X = Screw terminal

Mounting cut-outs

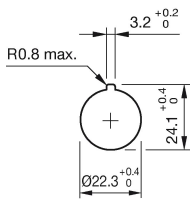

Wiring diagram

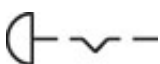

Additional information

Shaft yellow
Twist to unlock anti-clockwise
Max. 3 slow-make elements can be clipped on

Legend

Switching action: C = Maintained