

## IEC Appliance Connector C14 with Fuseholder 1- or 2-pole



C14



70° C

C18



70° C

**Description**

- Panel Mount:
  - Snap-In Version from front side
- 2 Functions:
  - Inlet protection class I or II, Fuseholder for fuse-links 5 x 20 mm on the rear-side 1- or 2-pole
- Quick-connect terminals 4.8 x 0.8 mm

**Characteristics**

- Two "locking" snappers reinforce connector against repeated or excessive pull out force during plug removal
- All single elements are already wired
- Fuseholder on the inside of the equipment prevents accidental use of incorrect fuse-links by the user
- Qualified for use in equipment according IEC/EN 60950

**Other versions on request**

- Ground terminal, solder/quick-connect, 90° to connector axis

**Weblinks**

Approvals: <http://www.schurter.com/approvals>

RoHS: <http://www.schurter.com/rohs>

**Technical Data**

Ratings IEC	10 A / 250 VAC; 50 Hz
Ratings UL/CSA	10 A / 125 VAC; 60 Hz
Dielectric Strength	> 2.2 kVAC between L-N > 3 kVAC between L/N-PE (1 min/50 Hz)
Allowable Operation Temp.	-25 °C to 70 °C
Degree of Protection	from front side IP 40 acc. to IEC 60529
Protection Class	Suitable for appliances with protection class I or II acc. to IEC 61140
Terminal	Quick-connect terminals 4.8 x 0.8 mm , Ground terminal: Solder terminals or quick connect terminals tin-plated Solder terminal on request
Panel Thickness s	Snap-in: 1/1.2/1.5/2/2.5/3 mm (other on request) (all steps with one variant)
Material: Housing	Thermoplastic, black, UL 94V-0

Appliance-Inlet /-Outlet	C14/C18 acc. to IEC/EN 60320-1, UL 498, CSA C22.2 no. 42 (for cold condition) pin-temperature 70 °C, 10 A, Protection class I or II
Fuseholder	1 or 2 pole, Shocksafe category PC2 acc. to IEC 60127-6, for fuse-links 5 x 20 mm
Rated Power Acceptance @ Ta 23 °C	5 x 20: 3.15 W (1 pole)/ 2.5 W (2-pole) per pole
Power Acceptance @ Ta > 23°C	Admissible power acceptance at higher ambient temperature see derating curves

Dimensions

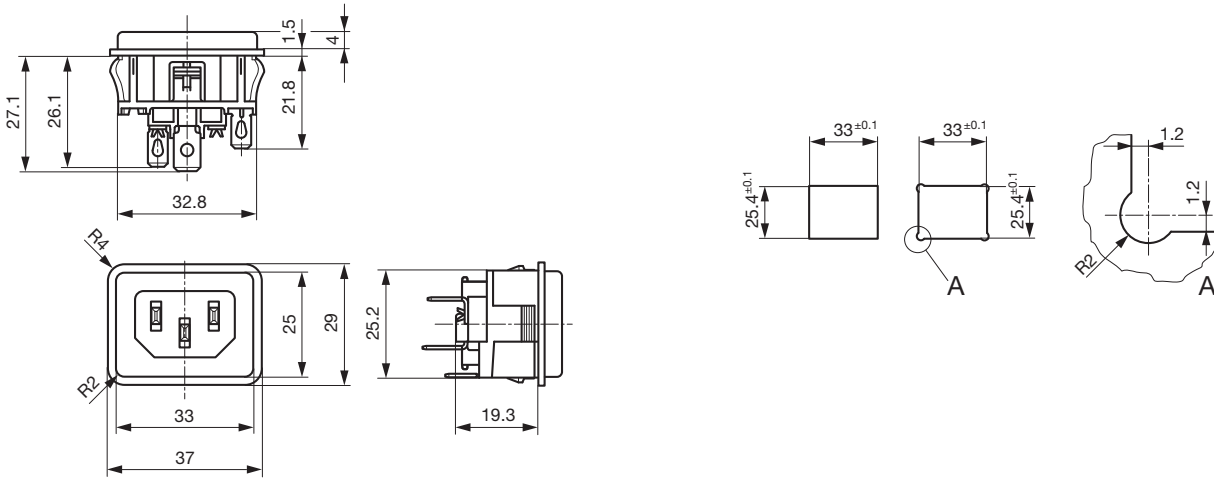
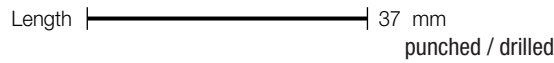

Line and neutral: Quick-connect terminal 4.8x0.8mm

Ground terminal: Quick connect terminal 4.8x0.8mm

Ground terminal: Quick-connect terminal 6.3x0.8mm

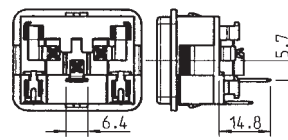
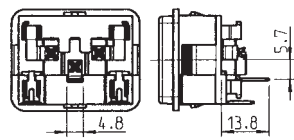
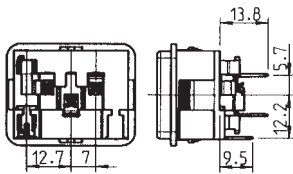

Mounting instructions

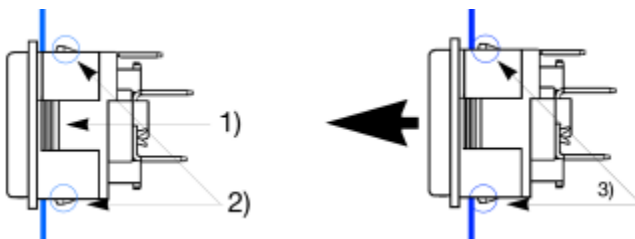

1) Main snappers for snap-in mounting  
2) Additional safety snappers not in use

3) Additional safety snappers in use against excessive pull out force

Derating curves

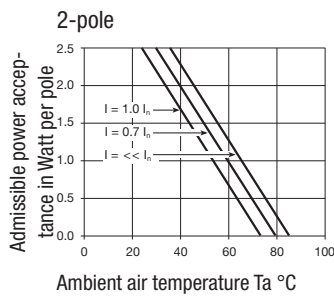
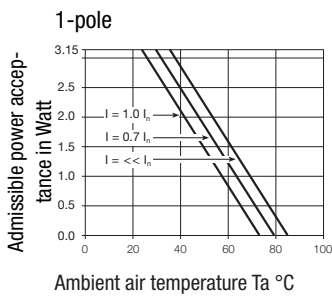

## Variants

Protection Class	Fuseholder	Ground terminal	Order Number
I	1 pole	Quick connect terminals 4.8 x 0.8 mm	GSF2.1011.01
I	1 pole	Quick connect terminals 6.3 x 0.8 mm	GSF2.1013.01
I	2-pole	Quick connect terminals 4.8 x 0.8 mm	GSF2.2011.01
I	2-pole	Quick connect terminals 6.3 x 0.8 mm	GSF2.2013.01
II	1 pole	-	GSF2.1010.01
II	2-pole	-	GSF2.2010.01

Packaging unit 50 Pcs