

# EPIC® H-B 16 Housings

Housing style H-B. The industry standard.



## H-B 16 TSH-RO

### Suitable inserts:

- EPIC® H-BS 6 see page 452
- EPIC® H-BVE 6 see page 454
- EPIC® H-DD 72 see page 441
- EPIC® H-EE 32 see page 450
- EPIC® MCR 16 see page 462
- EPIC® H-D 40 see page 439
- EPIC® H-BE 16 Screw termination see page 445
- EPIC® H-BE 16 Crimp termination see page 445
- EPIC® H-BE 16 Cage clamp see page 445



## H-B 16 TG



## H-B 16 TG 2X



Part number	Part	PG	M	ZW	L	L1	I2	B	B1	B4	H
<b>H-B housing: Hood (side cable entry, bolts for single lever, high version)</b>											
70104200	H-B 16 TSH-RO 21	21		yes	93,3			110	43	45	76
70104400	H-B 16 TSH-RO 29	29		yes	93,3			110	43	45	76
79104200	H-B 16 TSH-RO M25		25		93,3			110	43	45	76
79104400	H-B 16 TSH-RO M32		32		93,3			110	43	45	76
79104800	H-B 16 TSH-RO M40		40		93,3			110	43	45	76
<b>H-B housing: Hood (straight cable entry, bolts for double lever)</b>											
10080000	H-B 16 TG 21	21		yes	93,3	47,5		43	57,8	45	61
10090000	H-B 16 TG 29	29		yes	93,3	47,5		43	57,8	45	61
19080000	H-B 16 TG M25		25		93,3	47,5		43	57,8	45	61
19090000	H-B 16 TG M32		32		93,3	47,5		43	57,8	45	61
<b>H-B housing: Hood (2 straight cable entries, bolts for double lever)</b>											
19080500	H-B 16 TG 2xM25		2x25	yes	93,3	47,5		43	57,8	45	61

# EPIC® H-B 16 Housings

Housing standard H-B T e in ustr stan ar



## H-B 16 G- B

### Suitable inserts:

- EPIC® H-BS 6 see page 452
- EPIC® H-BVE 6 see page 454
- EPIC® H-DD 72 see page 441
- EPIC® H-EE 32 see page 450
- EPIC® MCR 16 see page 462
- EPIC® H-D 40 see page 439
- EPIC® H-BE 16 Screw termination see page 445
- EPIC® H-BE 16 Crimp termination see page 445
- EPIC® H-BE 16 Cage clamp see page 445

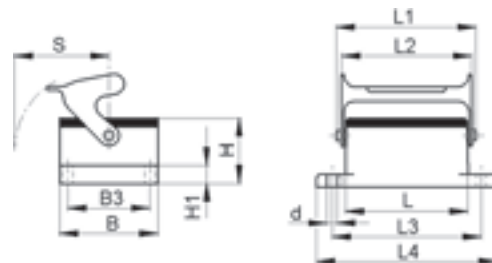

## H-B 16 D- B

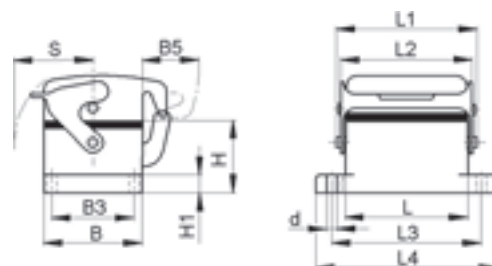

## H-B 16 G

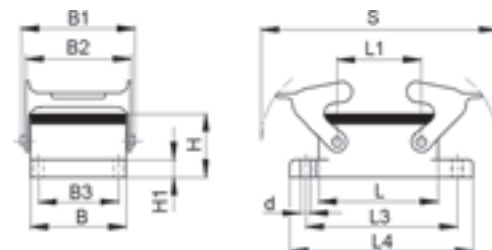

Part number	Part	L	L1	L2	L3	L4	B	B1	B2	B3	B5	H	H1	s	d
	<b>H-B housing: Panel mount base (single lever)</b>														
10072900	H-B 16 G- B	93,3	111	109,5	103	113	43			32		27,8	4	50	4,3
	<b>H-B housing: Panel mount base (cover, single lever)</b>														
10073900	H-B 16 D- B	93,3	111	109,5	103	113	43			32	25	27,8	4	50	4,3
	<b>H-B housing: Panel mount base (double lever)</b>														
10072000	H-B 16 G	93,3	47,5		103	113	43	57,8	53	32		27,8	4	136,5	4,3



## 5.1 EPIC® CERTOSA M & PG

Kabelverschraubungen PG / Cable glands PG thread / Presse-étoupes pas PG

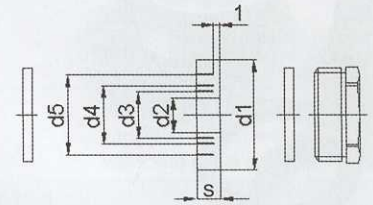

### EPIC® SP

Art.Nr. part No. N° art.	PG	d1	d2	Kabel Ø cable Ø câble Ø	d3	Kabel Ø cable Ø câble Ø	d4	Kabel Ø cable Ø câble Ø	d5	Kabel Ø cable Ø câble Ø	s	SW mm opening of the spanner ouverture de clef	VPE packing unit conditionnement
12957100	11	16,5	7,5	6,5-8,5	10	9-11	12,5	11,5-12			6	19	10
12957200	13,5	18,3	7,5	6,5-8,5	10	9-11	12,5	11,5-13,5			6	21	10
12957300	16	20,4	7,5	6,5-8,5	10	9-11	12,5	11,5-13,5	15	14,9-16	7	23	10
12957400	21	25,9	10	9-11	13	12-14	16	15-17	19	18-20	8	30	10

Material / material / matière: Polystyrol

Schutzart / protection class / degré de protection: IP 54 (DIN 46320)

Temperaturbereich / temperature range / gamme de température: -20 °C bis +55 °C

5

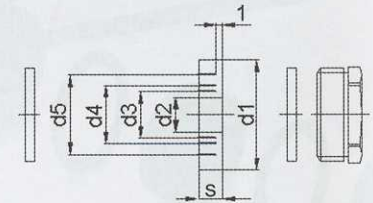

### EPIC® SM

Art.Nr. part No. N° art.	PG	d1	d2	Kabel Ø cable Ø câble Ø	d3	Kabel Ø cable Ø câble Ø	d4	Kabel Ø cable Ø câble Ø	d5	Kabel Ø cable Ø câble Ø	s	SW mm opening of the spanner ouverture de clef	VPE packing unit conditionnement
12954100	9	13,3	5	4-6	7,5	6,5-8,5	10	9-10			5,5	15	25
12954200	11	16,5	7,5	6,5-8,5	10	9-11	12,5	11,5-12			6	18	5
12954300	13,5	18,3	7,5	6,5-8,5	10	9-11	12,5	11,5-13,5			6	20	5
12954400	16	20,4	7,5	6,5-8,5	10	9-11	12,5	11,5-13,5	15	14-16	7	22	5
12954500	21	25,9	10	9-11	13	12-14	16	15-17	19	18-20	8	28	5
12954600	29	34,7	18	17-19	21	20-22	24	23-25	27	26-28	9,5	37	5
12954700	36	44,7	24	23-25	27	26-28	30	29-31	33	32-34	12	47	5
12954800	42	51,7	30	29-31	33	32-34	36	35-37	39	38-40	14	54	5

Material / material / matière: Metall, Messing vernickelt / metal, brass, nickel plated / métallique, laiton nickelage

Schutzart / protection class / degré de protection: IP 54 (DIN 46320)

Temperaturbereich / temperature range / gamme de température: -40 °C bis +80 °C