

## K1G043RZ2

cam start selector switch - 2-pole - 60 °-12 A - front mounting - red handle



### Main

|                                             |                                                              |
|---------------------------------------------|--------------------------------------------------------------|
| Range of product                            | Harmony K                                                    |
| Product or component type                   | Complete cam switch                                          |
| Component name                              | K1                                                           |
| [lth] conventional free air thermal current | 12 A                                                         |
| Product mounting                            | Front mounting                                               |
| Fixing mode                                 | 6 screws Ø 5.2 mm                                            |
| Cam switch head type                        | With front plate 55 x 100 mm                                 |
| Type of operator                            | Red handle                                                   |
| Rotary handle padlocking                    | With                                                         |
| Presentation of legend                      | With metallic legend, 0 - 1 - 2 - 3 black marking            |
| Cam switch function                         | Start selector switch                                        |
| Return                                      | Without                                                      |
| Off position                                | With Off position                                            |
| Poles description                           | 2P                                                           |
| Switching positions                         | Right: 0° - 60° - 120° - 180°                                |
| IP degree of protection                     | IP40 conforming to IEC 529<br>IP40 conforming to NF C 20-010 |

### Complementary

|                                              |                                                                                                                                                                                                                                                                                                                                                                                                                                                                                                                                                                                                                                                                                                                                                                                               |
|----------------------------------------------|-----------------------------------------------------------------------------------------------------------------------------------------------------------------------------------------------------------------------------------------------------------------------------------------------------------------------------------------------------------------------------------------------------------------------------------------------------------------------------------------------------------------------------------------------------------------------------------------------------------------------------------------------------------------------------------------------------------------------------------------------------------------------------------------------|
| Switching angle                              | 60 °                                                                                                                                                                                                                                                                                                                                                                                                                                                                                                                                                                                                                                                                                                                                                                                          |
| [U <sub>i</sub> ] rated insulation voltage   | 690 V degree of pollution 3 conforming to IEC 60947-1                                                                                                                                                                                                                                                                                                                                                                                                                                                                                                                                                                                                                                                                                                                                         |
| [lthe] conventional enclosed thermal current | 10 A                                                                                                                                                                                                                                                                                                                                                                                                                                                                                                                                                                                                                                                                                                                                                                                          |
| Rated operational power in W                 | 1500 W AC-3 / 500 V 3 phases conforming to IEC 60947-3<br>10500 W AC-21 / 500...660 V 3 phases conforming to IEC 60947-3<br>1500 W AC-3 / 400 V 1 phase conforming to IEC 60947-3<br>2200 W AC-23A / 690 V 3 phases conforming to IEC 60947-3<br>1500 W AC-23A / 230 V 3 phases conforming to IEC 60947-3<br>2200 W AC-23A / 500 V 3 phases conforming to IEC 60947-3<br>2200 W AC-23A / 400 V 3 phases conforming to IEC 60947-3<br>4800 W AC-21 / 230 V 3 phases conforming to IEC 60947-3<br>1100 W AC-3 / 230 V 3 phases conforming to IEC 60947-3<br>600 W AC-3 / 230 V 1 phase conforming to IEC 60947-3<br>1500 W AC-3 / 400 V 3 phases conforming to IEC 60947-3<br>8300 W AC-21 / 400 V 3 phases conforming to IEC 60947-3<br>1500 W AC-3 / 690 V 3 phases conforming to IEC 60947-3 |
| [le] rated operational current AC            | 1 A at 500 V AC-15 conforming to IEC 60947-5-1<br>2 A at 400 V AC-15 conforming to IEC 60947-5-1<br>3 A at 230 V AC-15 conforming to IEC 60947-5-1<br>1.8 A at 690 V AC-3 3 phases conforming to IEC 60947-3<br>2.8 A at 500 V AC-3 3 phases conforming to IEC 60947-3<br>2.8 A at 690 V AC-23A 3 phases conforming to IEC 60947-3<br>3.3 A at 400 V AC-3 3 phases conforming to IEC 60947-3<br>3.8 A at 500 V AC-23A 3 phases conforming to IEC 60947-3<br>4.6 A at 230 V AC-3 3 phases conforming to IEC 60947-3<br>4.8 A at 400 V AC-23A 3 phases conforming to IEC 60947-3<br>5.6 A at 230 V AC-23A 3 phases conforming to IEC 60947-3                                                                                                                                                    |
| Electrical durability                        | 1000000 cycles AC-15<br>1000000 cycles AC-21<br>500000 cycles AC-23<br>500000 cycles AC-3                                                                                                                                                                                                                                                                                                                                                                                                                                                                                                                                                                                                                                                                                                     |
| Operating rate                               | 2.5 cyc/mn AC-21<br>2.5 cyc/mn AC-23<br>2.5 cyc/mn AC-3<br>8.333 cyc/mn AC-15                                                                                                                                                                                                                                                                                                                                                                                                                                                                                                                                                                                                                                                                                                                 |
| Short-circuit current                        | 10000 A                                                                                                                                                                                                                                                                                                                                                                                                                                                                                                                                                                                                                                                                                                                                                                                       |

The information provided in this documentation contains general descriptions and/or technical characteristics of the products contained herein. This documentation is not intended as a substitute for and is not to be used for determining suitability or reliability of these products for specific user applications. It is the duty of any such user or integrator to perform the appropriate and complete risk analysis, evaluation and testing of the products with respect to the relevant specific application or use thereof. Neither Schneider Electric Industries SAS nor any of its affiliates or subsidiaries shall be responsible or liable for misuse of the information contained herein.

|                                        |                                                                                                                                 |
|----------------------------------------|---------------------------------------------------------------------------------------------------------------------------------|
| Short-circuit protection               | 16 A by cartridge fuse, type gG                                                                                                 |
| [Uimp] rated impulse withstand voltage | 4 kV in isolating function<br>6 kV conforming to IEC 60947-1                                                                    |
| Contact operation                      | Slow-break                                                                                                                      |
| Positive opening                       | With                                                                                                                            |
| Electrical connection                  | Captive screw clamp terminals flexible, 2 x 1.5 mm <sup>2</sup><br>Captive screw clamp terminals solid, 1 x 2.5 mm <sup>2</sup> |
| Mechanical durability                  | 1000000 cycles                                                                                                                  |
| CAD overall width                      | 55 mm                                                                                                                           |
| CAD overall height                     | 100 mm                                                                                                                          |
| CAD overall depth                      | 83 mm                                                                                                                           |
| Product weight                         | 0.17 kg                                                                                                                         |

## Environment

|                                       |                                                                                                                               |
|---------------------------------------|-------------------------------------------------------------------------------------------------------------------------------|
| standards                             | CENELEC EN 50013<br>EN/IEC 60947-3 for power circuit<br>EN/IEC 60947-5-1 for control circuit                                  |
| product certifications                | CSA 240 V 1 hp 1 phase<br>CSA 240 V 3 hp 3 phases 2 -pole(s)<br>UL 240 V 1 hp 3 phases<br>UL 240 V 0.33 hp 1 phase 2 -pole(s) |
| protective treatment                  | TC                                                                                                                            |
| ambient air temperature for operation | -25...55 °C                                                                                                                   |
| ambient air temperature for storage   | -40...70 °C                                                                                                                   |
| shock resistance                      | 30 gn conforming to IEC 68-2-27                                                                                               |
| vibration resistance                  | 5 gn, 10...150 Hz conforming to IEC 68-2-6                                                                                    |
| electrical shock protection class     | Class II conforming to IEC 536<br>Class II conforming to NF C 20-030                                                          |

## Contractual warranty

|                 |           |
|-----------------|-----------|
| Warranty period | 18 months |
|-----------------|-----------|

## Operating Head and Body with Plastic Base and Key Locking

### Front Mounting by 6 Screws

55 mm x 100 mm / 2.17 in. x 3.94 in. front plate

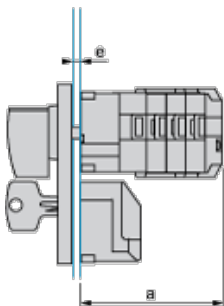

a 83 mm/3.27 in.

e support panel thickness 1 mm to 6 mm./0.039 in. to 0.24 in.

## Operating Head and Body with Plastic Base and Key Locking

### Panel Cut-out

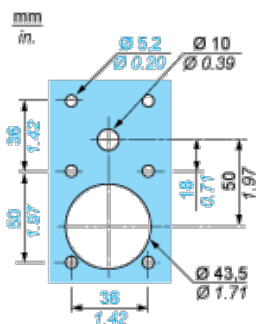

## Marking

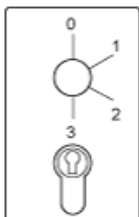

## Angular Position of Switch

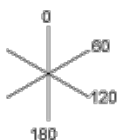

## Switching Program

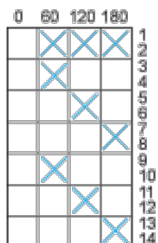

## Convention Used for Switching Program Representation

- Contact closed
- Contact closed in 2 positions and maintained between the 2 positions
- Sealed assembly for auto-maintain control
- Overlapping contacts
- Spring return position: for a switching angle of 90°, spring return is over 30° after the last position (for a maximum of 3 simultaneous contacts).

Example:

