

Contact Points

Optional Accessories for Digimatic and Dial Indicators and Linear Gages

60° Conical point

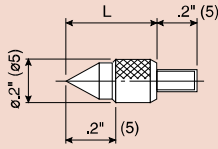

4-48UNF	
L	Order No.
1/2"	101190

M2.5 x 0.45mm	
L	Order No.
10mm	101120

90° Conical point

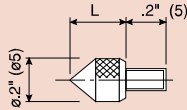

4-48UNF	
L	Order No.
1/4"	101191

M2.5 x 0.45mm	
L	Order No.
5mm	101385

Blade point, Carbide tip

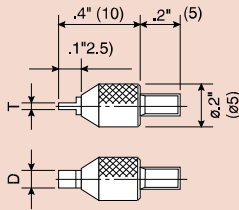

4-48UNF		
D	T	Order No.
.08"	.016"	131276
.08"	.024"	131277
.16"	.04"	131278

M2.5 x 0.45mm		
D	T	Order No.
2mm	0.4mm	120061
2mm	0.6mm	120062
4mm	1mm	120063

90° Conical point, Carbide tipped

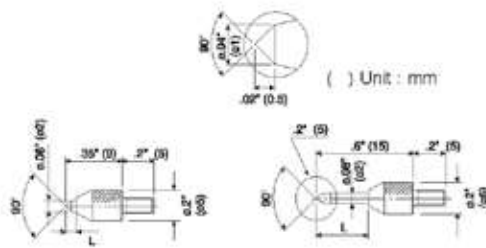

4-48UNF	
L	Order No.
.08"	131272

4-48UNF	
L	Order No.
.3"	131283

M2.5 x 0.45mm	
L	Order No.
2mm	120057

M2.5 x 0.45mm	
L	Order No.
8mm	120068

Roller Point

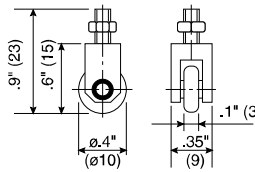

4-48UNF	
Order No.	
901991	

M2.5 x 0.45mm	
Order No.	
901954	

Extension Rod

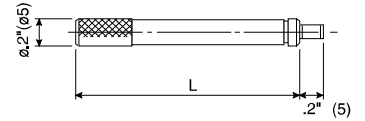

4-48UNF	
L	Order No.
1/2"	139167
1"	301655
2"	301657
4"	301659

M2.5 x 0.45mm	
L	Order No.
10mm	303611
15mm	21AAA259A
20mm	303612
25mm	21AAA259B
30mm	303613
35mm	21AAA259C
40mm	21AAA259D
45mm	21AAA259E
50mm	21AAA259F
55mm	21AAA259G
60mm	304146
65mm	21AAA259H
70mm	21AAA259J
75mm	21AAA259L
80mm	21AAA259M
90mm	304147
100mm	303614

Point Conversion

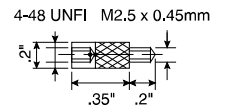
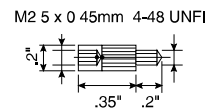

Order No.
21AAA011

Order No.
21AAA012

Lever Point

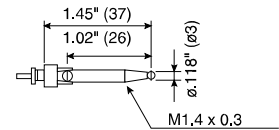

4-48UNF	
Order No.	
900393	

M2.5 x 0.45mm	
Order No.	
900391	

Interchangeable Contact Point Set (M2.5x0.45)

Set Order No. 7822



Individual No.	Description
131365	Flat Point (ø5mm)
101117	Flat Point (ø10mm)
101121	Needle Point
101119	Spherical Point
101118	Shell Type Point
101387	Shell Type Point