



Main

Range of product	Harmony XB4
Product or component type	Complete illuminated push-button
Device short name	XB4
Bezel material	Chromium plated metal
Fixing collar material	Zamak
Mounting diameter	22 mm
Sale per indivisible quantity	1
Dust zone	Zone 21 - 22
Gas zone	Zone 1 - 2
Type of operator	Spring return
Operator profile	Yellow flush
Operator additional information	Booted (clear silicon)
Contacts type and composition	1 NO + 1 NO

Complementary

Width	46.2 mm
Height	30 mm
Depth	72 mm
Product weight	0.127 kg
Device mounting	Fixing hole \varnothing 22.5 mm (+/- 0.2 mm) conforming to EN/IEC 60947-1
Fixing center	\geq 30 x 40 mm on support panel : 1...6 mm
Embedding depth	58 mm
Marking	Ex tb IIIC Db II 2 GD Ex db eb mb IIC Gb
Shape of signaling unit head	Round
Contact operation	Slow-break
Positive opening	Without
Operating travel	1.657 mm (engagement point) 4.622 mm (changing state point) 4.452 mm (total travel)
Operating force	3.962 N

Mechanical durability	5000000 cycles
Connections - terminals	Screw clamp terminals, clamping capacity: 2 x 1.5 mm ² with cable end conforming to EN/IEC 60947-1 Screw clamp terminals, clamping capacity: 1 x 2.5 mm ² without cable end conforming to EN/IEC 60947-1
Tightening torque	0.8...1.2 N.m conforming to EN 60947-1
[I _{th}] conventional free air thermal current	10 A conforming to EN/IEC 60947-5-1
[U _i] rated insulation voltage	415 V
[I _e] rated operational current	1.9 A at 380 V AC, A600 conforming to EN/IEC 60947-5-1 3 A at 240 V AC, A600 conforming to EN/IEC 60947-5-1 6 A at 120 V AC, A600 conforming to EN/IEC 60947-5-1 0.27 A at 250 V DC, Q300 conforming to EN/IEC 60947-5-1 0.55 A at 125 V DC, Q300 conforming to EN/IEC 60947-5-1 2.87 A at 24 V DC, Q300 conforming to EN/IEC 60947-5-1
Signalling type	Steady
Light source	Integral LED
[U _s] rated supply voltage	24...254 V AC/DC
Current consumption	2...10 mA
Service life	100000 h

Environment

Protective treatment	TH
Ambient air temperature for storage	-40...70 °C
Ambient air temperature for operation	-20...75 °C
Overvoltage category	I conforming to IEC 60536
IP degree of protection	IP66 conforming to IEC 60529
Standards	CSA C22.2 No 213 EN/IEC 60079-0 : 2009 EN/IEC 60079-7 : 2009 EN/IEC 60079-31 : 2009 UL 60079-0 UL 60079-31 ANSI/ISA 12.12.01 EN/IEC 60079-18 : 2009 UL 60079-18
Product certifications	INERIS 04ATEX9004U

Dimensions

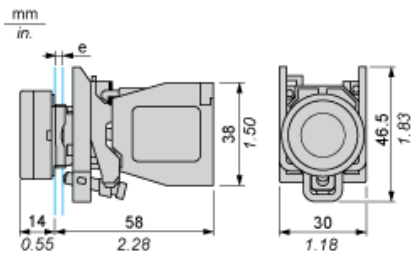

e : support thickness: 1 to 6 mm / 0.04 to 0.24 in.

Panel Cut-out for Pushbuttons, Switches and Pilot Lights (Finished Holes, Ready for Installation)

Connection by Screw Clamp Terminals

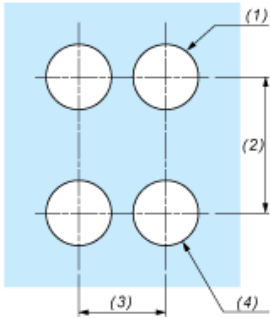

- (1) Diameter on finished panel or support
- (2) 40 mm min. / 1.57 in. min.
- (3) 30 mm min. / 1.18 in. min.
- (4) $\varnothing 22.5 \text{ mm} / 0.89 \text{ in. recommended } (\varnothing 22.3 \text{ mm }_0^{+0.4} / 0.88 \text{ in. }_0^{+0.016})$