

### Main

Range of product	Harmony XB4
Product or component type	Complete emergency stop push-button
Device short name	XB4
Bezel material	Chromium plated metal
Fixing collar material	Zamak
Mounting diameter	22 mm
Sale per indivisible quantity	1
Dust zone	Zone 21 - 22
Gas zone	Zone 1 - 2
Type of operator	Trigger action and mechanical latching
Reset	Turn to release
Operator profile	Red mushroom Ø 40 mm
Contacts type and composition	1 NO + 1 NC

### Complementary

Width	46.2 mm
Height	30 mm
Depth	119.5 mm
Product weight	0.141 kg
Device mounting	Fixing hole Ø 22.5 mm (+/- 0.2 mm) conforming to EN/IEC 60947-1
Fixing center	>= 30 x 40 mm on support panel : 1...6 mm
Embedding depth	58 mm
Marking	Ex tb IIIC Db Ex db eb IIC Gb II 2 GD
Shape of signaling unit head	Round
Contact operation	Slow-break
Contacts usage	Standard
Positive opening	With conforming to EN/IEC 60947-5-1 : appendix K
Mechanical durability	5000000 cycles
Connections - terminals	Screw clamp terminals, clamping capacity: 2 x 1.5 mm <sup>2</sup> with cable end conforming to EN/IEC 60947-1

Disclaimer: This documentation is not intended as a substitute for and is not to be used for determining suitability or reliability of these products for specific user applications

Tightening torque	0.8...1.2 N.m conforming to EN 60947-1
[I <sub>th</sub> ] conventional free air thermal current	10 A conforming to EN/IEC 60947-5-1
[U <sub>i</sub> ] rated insulation voltage	415 V
[I <sub>e</sub> ] rated operational current	1.9 A at 380 V AC, A600 conforming to EN/IEC 60947-5-1
Compatibility code	XB4

## Environment

Protective treatment	TH
Ambient air temperature for storage	-40...70 °C
Ambient air temperature for operation	-20...65 °C
IP degree of protection	IP65 conforming to IEC 60529
Standards	EN/IEC 60079-0 : 2009
Product certifications	INERIS 04ATEX9004U

Dimensions

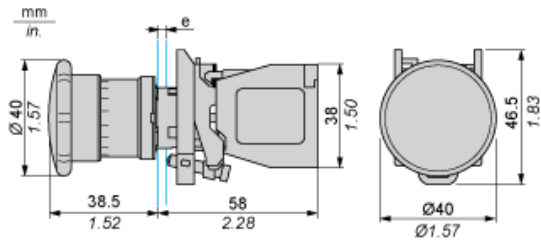

e : support thickness: 1 to 6 mm / 0.04 to 0.24 in.

---

Panel Cut-out for Pushbuttons, Switches and Pilot Lights (Finished Holes, Ready for Installation)

---

Connection by Screw Clamp Terminals

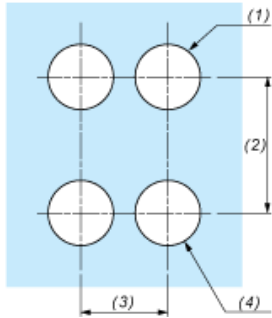

- (1) Diameter on finished panel or support
- (2) 40 mm min. / 1.57 in. min.
- (3) 30 mm min. / 1.18 in. min.
- (4)  $\varnothing 22.5 \text{ mm} / 0.89 \text{ in. recommended } (\varnothing 22.3 \text{ mm }_0^{+0.4} / 0.88 \text{ in. }_0^{+0.016})$