

# EAO – Your Expert Partner for Human Machine Interfaces

HFEGFEFGÄQ { ä æ å Ä ~ • @ ~ α } Å&ç æ !

## 31-121.012 - Illuminated pushbutton actuator

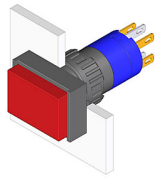

Attention: The preview is based on a sample product. This can differ from your current configuration.

### Mounting

Mounting cut-out Ø 16 mm  
Design raised

### Front

Front shape rectangular  
Front dimension 18 mm x 24 mm  
Front bezel colour black  
Front bezel material Plastic

### Other Attributes

Weight 0,006 kg

### Operating-/Indication part

Lens illumination illuminative

### IP-Rating

Front protection IP40

### Connection Method

Terminal Solder 2.8 x 0.5 mm

### Actuator

Switching action Momentary  
Housing colour black  
Housing material Plastic

### Switching element

Switching system Snap-action switching element  
Contacts 1 NC + 1 NO  
Switching current 5 A  
Contact material - silver  
Switching voltage 250 V AC

### Function

Illuminated pushbutton

# EAO – Your Expert Partner for Human Machine Interfaces

31-121.012 - Illuminated pushbutton actuator

## Dimensions

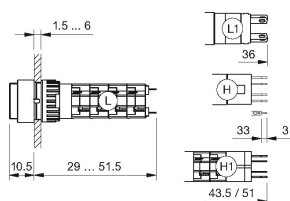

H = Universal terminal 2.0 x 0.5 mm

## Mounting cut-outs

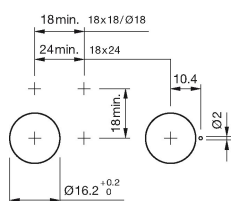

## Wiring diagram

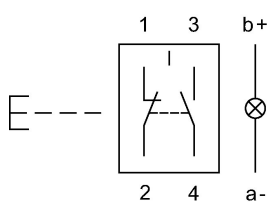

## Legend

Contacts: NC = Normally closed, NO = Normally open  
Switching action: B = Momentary