

# Dual Surface Mount Low Leakage Diode

**multicomp** PRO



## Features:

- Medium Speed Current Applications
- Very Low Leakage Current
- Surface Mount Package Ideally Suited for Automatic Insertion

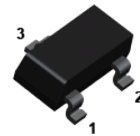
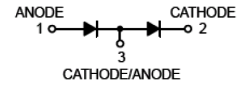

SOT-23

## Applications:

Small signal switching

## Max. Rating @ T<sub>A</sub> = 25°C unless otherwise specified

Parameter	Symbol	Limits	Unit
Repetitive peak reverse voltage Working peak reverse voltage DC reverse voltage	V <sub>RRM</sub> V <sub>RMS</sub> V <sub>R</sub>	85	V
RMS reverse voltage	V <sub>R(RMS)</sub>	60	V
Peak forward surge current @t=1.0µs @t=1.0ms @t=1.0s	I <sub>FSM</sub>	4 1 0.5	A
Forward continuous current Single diode Double diode	I <sub>FM</sub>	160 140	mA
Repetitive peak forward current	I <sub>FRM</sub>	500	mA
Power dissipation	P <sub>D</sub>	250	mW
Thermal resistance junction to ambient air	R <sub>θJA</sub>	500	°C/W
Operating and storage temperature range	T <sub>j</sub> , T <sub>STG</sub>	-65 to +150	°C

## Electrical Characteristics @ T<sub>A</sub> = 25°C unless otherwise specified

Parameter	Symbol	Conditions	Min.	Max.	Unit
Reverse breakdown voltage	V <sub>(BR)</sub>	I <sub>R</sub> = 100µA	85	-	V
Reverse voltage leakage current	I <sub>R</sub>	V <sub>r</sub> = 75V V <sub>r</sub> = 75V, T <sub>j</sub> = 150°C	-	5 80	nA
Forward voltage	V <sub>F</sub>	I <sub>F</sub> = 1mA I <sub>F</sub> = 10mA I <sub>F</sub> = 50mA I <sub>F</sub> = 150mA	-	900 1,000 1,100 1,250	mV
Junction capacitance	C <sub>J</sub>	V <sub>R</sub> = 0V, f = 1MHz	-	5	ns
Reverse recovery time	t <sub>rr</sub>	I <sub>F</sub> = I <sub>R</sub> = 10mA, I <sub>rr</sub> = 0.1 × I <sub>R</sub> , R <sub>L</sub> = 100Ω	-	3	pF

Newark.com/multicomp-pro  
Farnell.com/multicomp-pro  
Element14.com/multicomp-pro

**multicomp** PRO

# Dual Surface Mount Low Leakage Diode

Typical Characteristics @  $T_A = 25^\circ\text{C}$  unless otherwise specified

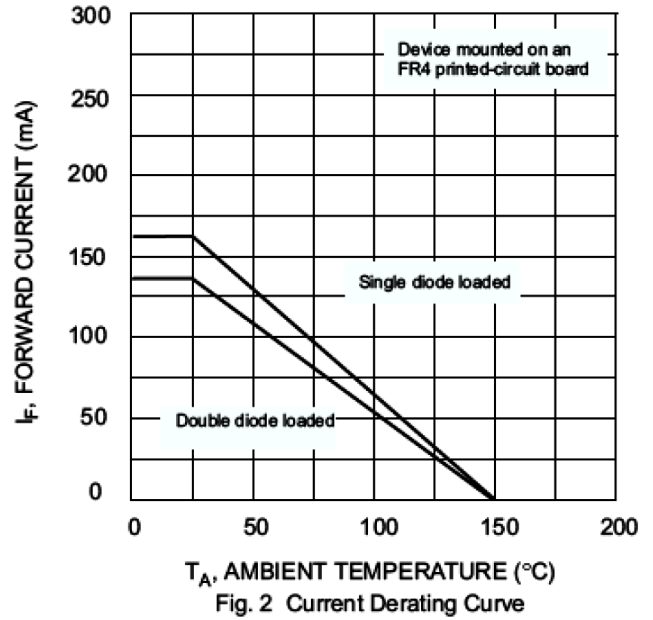
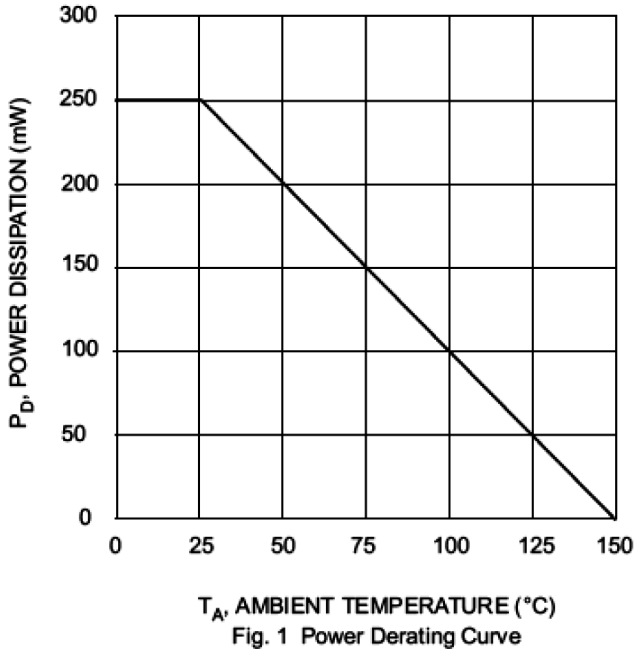

## Plastic surface mounted package

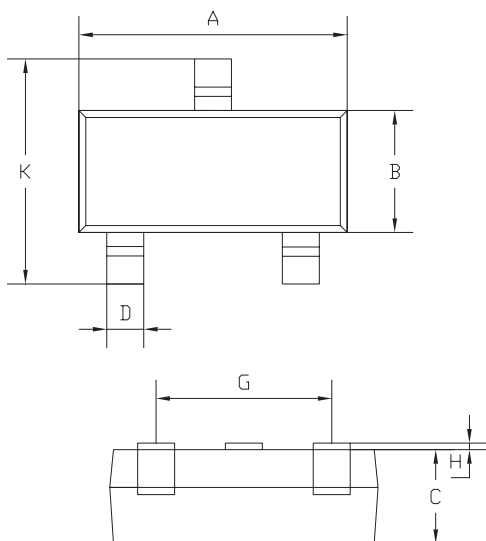

SOT-23		
Dim	Min	Max
A	2.85	2.95
B	1.25	1.35
C	1 Typical	
D	0.37	0.43
E	0.35	0.48
G	1.85	1.95
H	0.02	0.1
J	0.1 Typical	
K	2.35	2.45
All Dimensions in mm		

# Dual Surface Mount Low Leakage Diode

## Soldering Footprint

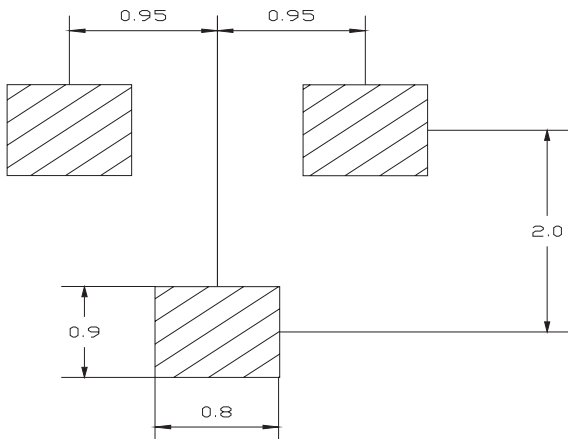

Unit : mm

## Package Information

Device	Package	Shipping
BAV199-7-F	SOT-23	3,000 / Tape & Reel

## Part Number Table

Description	Part Number
Dual surface mount low leakage diode	BAV199-7-F

**Important Notice :** This data sheet and its contents (the "Information") belong to the members of the AVNET group of companies (the "Group") or are licensed to it. No licence is granted for the use of it other than for information purposes in connection with the products to which it relates. No licence of any intellectual property rights is granted. The Information is subject to change without notice and replaces all data sheets previously supplied. The Information supplied is believed to be accurate but the Group assumes no responsibility for its accuracy or completeness, any error in or omission from it or for any use made of it. Users of this data sheet should check for themselves the Information and the suitability of the products for their purpose and not make any assumptions based on information included or omitted. Liability for loss or damage resulting from any reliance on the Information or use of it (including liability resulting from negligence or where the Group was aware of the possibility of such loss or damage arising) is excluded. This will not operate to limit or restrict the Group's liability for death or personal injury resulting from its negligence. Multicomp Pro is the registered trademark of Premier Farnell Limited 2019.