

Lightning/surge arrester type 1/2 - VAL-MS-T1/T2 48/12.5/2+0/1U/ FM - 2907042

Please be informed that the data shown in this PDF Document is generated from our Online Catalog. Please find the complete data in the user's documentation. Our General Terms of Use for Downloads are valid (<http://phoenixcontact.com/download>)

Universal varistor-based plug-in lightning/surge arrester for 48 V DC applications with grounded return conductor (positive pole), without risk assessment for Lightning Protection Levels III and IV, with remote indication contact.



Your advantages

- ✓ Rack-mount 1U panel applications
- ✓ Dual-channel, panel mountable surge protective device
- ✓ Orthogonal mounting orientation to plug
- ✓ Base element with floating remote indication contact



Key Commercial Data

| | |
|--------------------------------------|---------------------------------------------------------------------------------------------------------|
| Packing unit | 1 pc |
| GTIN |  4 055626 248974 |
| GTIN | 4055626248974 |
| Weight per Piece (excluding packing) | 251.160 g |
| Custom tariff number | 85363030 |
| Country of origin | Germany |
| Note | Made to Order (non-returnable) |

Technical data

Dimensions

| | |
|------------------|---------|
| Height | 40.6 mm |
| Width | 70.6 mm |
| Depth | 98.1 mm |
| Height unit | 1 U |
| Horizontal pitch | 4 Div. |

Ambient conditions

Lightning/surge arrester type 1/2 - VAL-MS-T1/T2 48/12.5/2+0/1U/ FM - 2907042

Technical data

Ambient conditions

| | |
|-----------------------------------------|-----------------------------------------------|
| Degree of protection | IP20 (only when all terminal points are used) |
| Ambient temperature (operation) | -40 °C ... 80 °C |
| Ambient temperature (storage/transport) | -40 °C ... 80 °C |
| Altitude | ≤ 2000 m (amsl (above mean sea level)) |
| Permissible humidity (operation) | 5 % ... 95 % |
| Shock (operation) | 30g (Half-sine / 11 ms / 3x ±X, ±Y, ±Z) |
| Vibration (operation) | 7.5g (10 ... 500 Hz / 2.5 h / X, Y, Z) |

General

| | |
|----------------------------------------|-----------------------------------------|
| IEC test classification | I / II |
| | T1 / T2 |
| | I |
| EN type | T1 / T2 |
| IEC power supply system | TN-S |
| Mode of protection | L-PE |
| | N-PE |
| Mounting type | Panel mount |
| Color | gray |
| Housing material | PA 6.6 |
| | PBT |
| Degree of pollution | 2 |
| Flammability rating according to UL 94 | V-0 |
| Type | DIN rail module, two-section, divisible |
| Surge protection fault message | Optical, remote indicator contact |

Additional descriptions

| | |
|------|---------------------------------------------------------------------------------------------------------------------------------------------------------------------------------------------------------------------------------|
| Note | For installation into a touch protected cabinet. For applications with $U_c > 500$ V distances at the side and distances at the connection area must be minimum of 5 mm between different active parts including earthed parts. |
|------|---------------------------------------------------------------------------------------------------------------------------------------------------------------------------------------------------------------------------------|

Protective circuit

| | |
|----------------------------------------------------|----------------------|
| Nominal voltage U_N | 60 V AC ±10 % (TN-S) |
| | -48 V DC ±10 % (RRH) |
| Nominal frequency f_N | 50 Hz (60 Hz) |
| Maximum continuous voltage U_c | 75 V AC |
| | 100 V DC |
| Rated load current I_L | 80 A |
| Residual current I_{PE} | ≤ 0.6 mA |
| Standby power consumption P_c | ≤ 45 mVA |
| Nominal discharge current I_n (8/20) μ s | 12.5 kA |
| Maximum discharge current I_{max} (8/20) μ s | 30 kA |

Lightning/surge arrester type 1/2 - VAL-MS-T1/T2 48/12.5/2+0/1U/ FM - 2907042

Technical data

Protective circuit

| | |
|------------------------------------------------------------------|------------------------------------|
| Impulse discharge current (10/350) μ s, charge | 6.25 As |
| Impulse discharge current (10/350) μ s, specific energy | 39 kJ/ Ω |
| Impulse discharge current (10/350) μ s, peak value I_{imp} | 12.5 kA |
| Total discharge current I_{total} (8/20) μ s | 50 kA |
| Short-circuit current rating I_{SCCR} | 25 kA |
| Voltage protection level U_p | ≤ 0.4 kV |
| Residual voltage U_{res} | ≤ 0.4 kV (at I_n) |
| | ≤ 0.35 kV (at 10 kA) |
| | ≤ 0.3 kV (at 5 kA) |
| | ≤ 0.275 kV (at 4 kA) |
| | ≤ 0.25 kV (at 3 kA) |
| TOV behavior at U_T | 100 V AC (5 s / withstand mode) |
| | 130 V DC (5 s / withstand mode) |
| Response time t_A | ≤ 25 ns |
| Max. backup fuse with V-type through wiring | 80 A AC (gG - 16 mm ²) |
| Max. backup fuse with branch wiring | 160 A AC (gG) |

Indicator/remote signaling

| | |
|---------------------------------------|----------------------------------------------|
| Switching function | PDT contact |
| Operating voltage | 5 V AC ... 250 V AC |
| | 125 V AC (UL) |
| | 125 V DC (200 mA DC) |
| Operating current | 5 mA AC ... 1.5 A |
| | 1 A (UL) |
| | 1 A (30 V DC) |
| Connection method | Push-in spring connection |
| Stripping length | 6 mm |
| Conductor cross section flexible min. | 0.2 mm ² |
| Conductor cross section flexible max. | 0.5 mm ² |
| Conductor cross section flexible | 0.2 mm ² ... 0.5 mm ² |
| Conductor cross section solid min. | 0.14 mm ² |
| Conductor cross section solid max. | 0.5 mm ² |
| Conductor cross section solid | 0.14 mm ² ... 0.5 mm ² |
| Conductor cross section AWG | 24 ... 20 (UL) |

Connection data

| | |
|-------------------|------------------------------------------------------------|
| Connection method | Screw connection |
| Screw thread | M5 |
| Tightening torque | 2.5 Nm ... 3 Nm |
| | 22 lb _F -in. ... 26.5 lb _F -in. (UL) |

Lightning/surge arrester type 1/2 - VAL-MS-T1/T2 48/12.5/2+0/1U/ FM - 2907042

Technical data

Connection data

| | |
|---------------------------------------|--------------------------------------------|
| Stripping length | 16 mm |
| Conductor cross section flexible min. | 1.5 mm ² |
| Conductor cross section flexible max. | 25 mm ² |
| Conductor cross section solid min. | 1.5 mm ² |
| Conductor cross section solid max. | 35 mm ² |
| Conductor cross section flexible | 1.5 mm ² ... 25 mm ² |
| Conductor cross section solid | 1.5 mm ² ... 35 mm ² |
| Conductor cross section AWG | 15 ... 2 |
| | 10 ... 2 (UL) |

UL specifications

| | |
|-------------------------------------------------|-------------|
| SPD Type | 1CA |
| Maximum continuous operating voltage MCOV (L-N) | 75 V AC |
| | 100 V DC |
| Nominal voltage | 60 V DC |
| Mode of protection | N-G |
| | L-G |
| | (L+) - (L-) |
| | (L+) - G |
| | (L-) - G |

UL indicator/remote signaling

| | |
|-----------------------------|-----------|
| Operating voltage | 125 V AC |
| Conductor cross section AWG | 30 ... 14 |

UL connection data

| | |
|-----------------------------|-------------------------------------------------------|
| Conductor cross section AWG | 10 ... 2 |
| Tightening torque | 22 lb _F -in. ... 26.5 lb _F -in. |

Additional technical data

| | |
|----------------------------------------------------|-------|
| Maximum discharge current I_{max} (8/20) μ s | 65 kA |
|----------------------------------------------------|-------|

Environmental Product Compliance

| | |
|------------|-----------------------------------------------------------------------------------------------------|
| REACH SVHC | Lead 7439-92-1 |
| China RoHS | Environmentally Friendly Use Period = 50 |
| | For details about hazardous substances go to tab "Downloads", Category "Manufacturer's declaration" |

Drawings

Lightning/surge arrester type 1/2 - VAL-MS-T1/T2 48/12.5/2+0/1U/ FM - 2907042

Drilling diagram

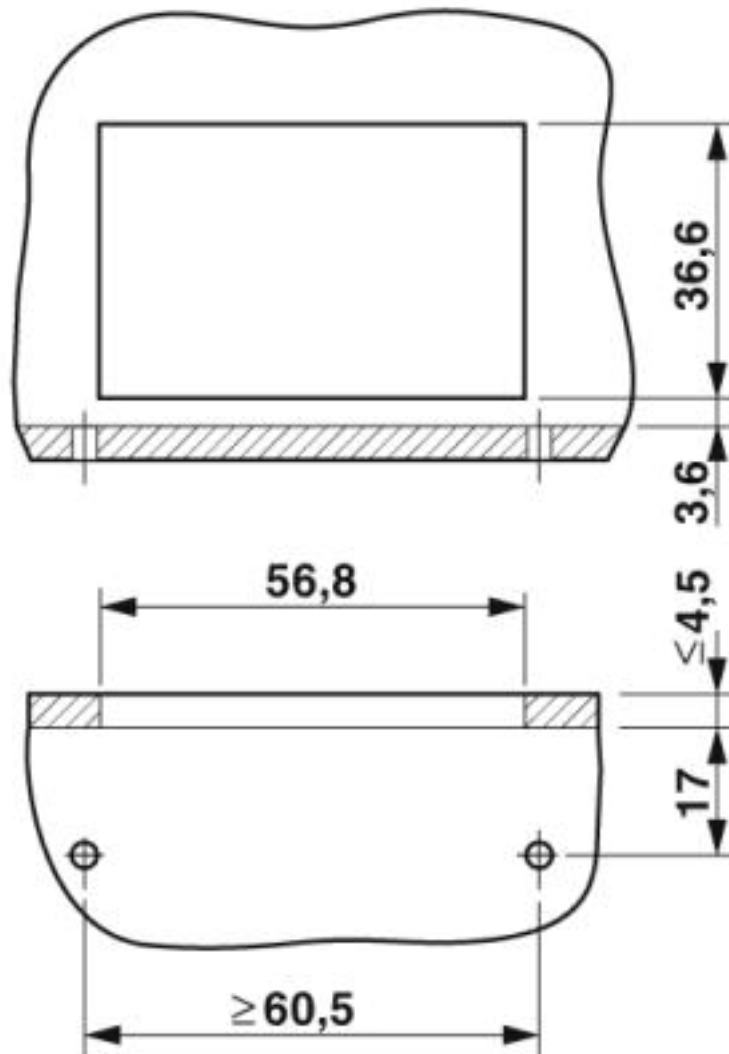

Lightning/surge arrester type 1/2 - VAL-MS-T1/T2 48/12.5/2+0/1U/ FM - 2907042

Circuit diagram

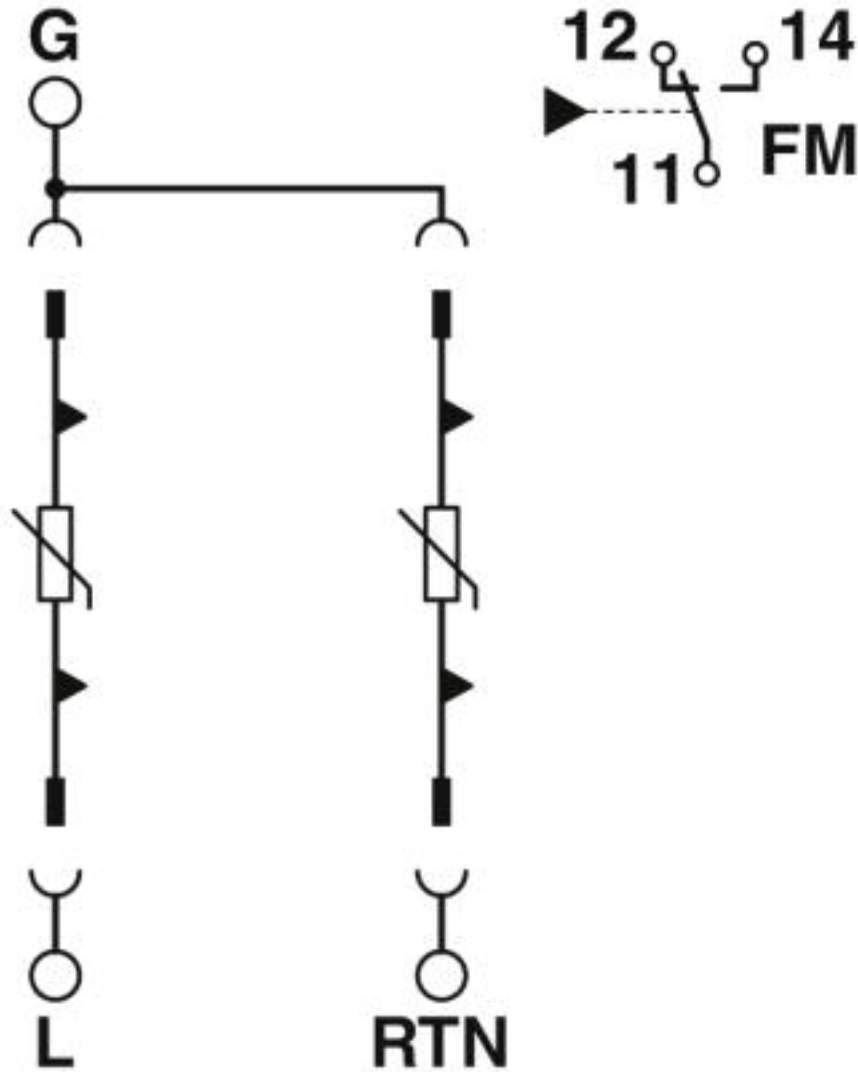

Lightning/surge arrester type 1/2 - VAL-MS-T1/T2 48/12.5/2+0/1U/ FM - 2907042

Dimensional drawing

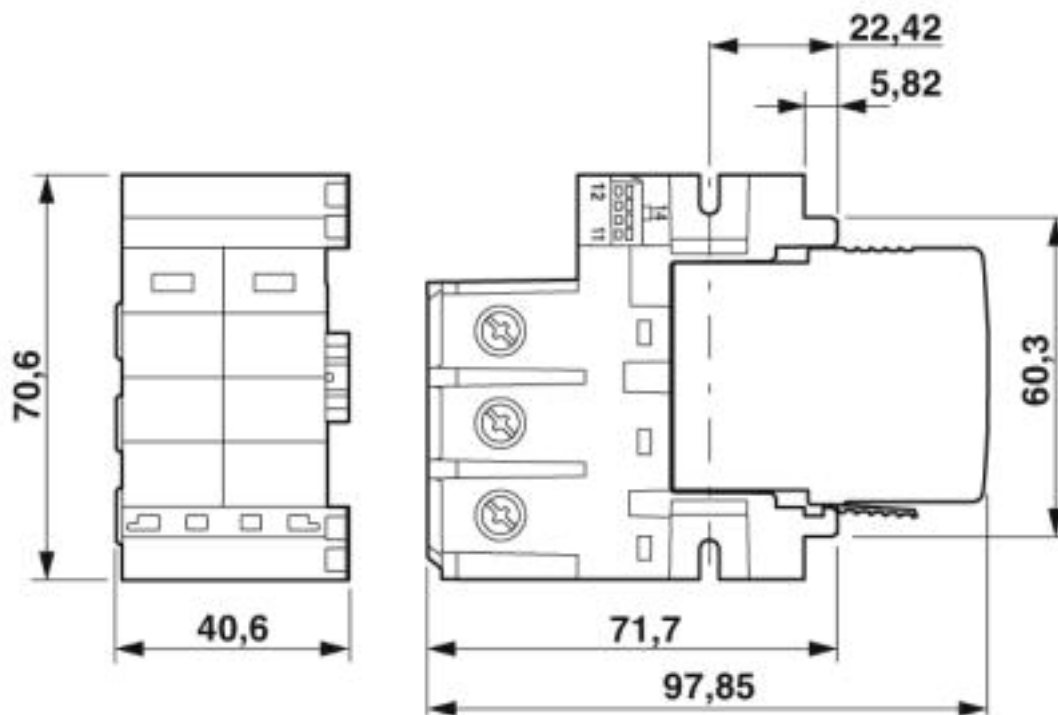

Classifications

eCl@ss

| | |
|------------|----------|
| eCl@ss 4.0 | 27130800 |
| eCl@ss 4.1 | 27130800 |
| eCl@ss 5.0 | 27130800 |
| eCl@ss 5.1 | 27130800 |
| eCl@ss 6.0 | 27130800 |
| eCl@ss 7.0 | 27130802 |
| eCl@ss 8.0 | 27130802 |
| eCl@ss 9.0 | 27130802 |

ETIM

| | |
|----------|----------|
| ETIM 2.0 | EC000941 |
| ETIM 3.0 | EC000941 |
| ETIM 4.0 | EC000381 |
| ETIM 5.0 | EC000381 |
| ETIM 6.0 | EC000381 |
| ETIM 7.0 | EC000381 |

UNSPSC

| | |
|-------------|----------|
| UNSPSC 6.01 | 30212010 |
|-------------|----------|

Lightning/surge arrester type 1/2 - VAL-MS-T1/T2 48/12.5/2+0/1U/ FM - 2907042

Classifications

UNSPSC

| | |
|---------------|----------|
| UNSPSC 7.0901 | 39121610 |
| UNSPSC 11 | 39121610 |
| UNSPSC 12.01 | 39121610 |
| UNSPSC 13.2 | 39121620 |
| UNSPSC 18.0 | 39121620 |
| UNSPSC 19.0 | 39121620 |
| UNSPSC 20.0 | 39121620 |
| UNSPSC 21.0 | 39121620 |

Approvals

Approvals

Approvals

UL Recognized / cUL Recognized / cULus Recognized

Ex Approvals

Approval details

| | | | |
|---------------|--|-------------------------------------------------------------------------------------------------------------------------------------------------------|---------------|
| UL Recognized | | http://database.ul.com/cgi-bin/XYV/template/LISEXT/1FRAME/index.htm | FILE E 330181 |
|---------------|--|-------------------------------------------------------------------------------------------------------------------------------------------------------|---------------|

| | | | |
|----------------|--|-------------------------------------------------------------------------------------------------------------------------------------------------------|---------------|
| cUL Recognized | | http://database.ul.com/cgi-bin/XYV/template/LISEXT/1FRAME/index.htm | FILE E 330181 |
|----------------|--|-------------------------------------------------------------------------------------------------------------------------------------------------------|---------------|

| | | | |
|------------------|--|--|--|
| cULus Recognized | | | |
|------------------|--|--|--|

Accessories

Accessories

Bridge

Lightning/surge arrester type 1/2 - VAL-MS-T1/T2 48/12.5/2+0/1U/ FM - 2907042

Accessories

Wiring bridge - MPB F200X16/ 1GS - 2818339



Wiring bridge flexible, diameter 16 mm², with a fork-type cable lug on one side, length: 200 mm

Wiring bridge - MPB F400X16/ 1GS - 2818342



Wiring bridge flexible, diameter 16 mm², with a fork-type cable lug on one side, length: 400 mm

Wiring bridge - MPB F600X16/ 1GS - 2818355



Wiring bridge flexible, diameter: 16 mm², with a fork-type cable lug on one side, length: 600 mm

Wiring bridge - MPB F600X16/ 1GS - 2818355



Wiring bridge flexible, diameter: 16 mm², with a fork-type cable lug on one side, length: 600 mm

Wiring bridge - MPB F400X16/ 1GS - 2818342



Wiring bridge flexible, diameter 16 mm², with a fork-type cable lug on one side, length: 400 mm

Lightning/surge arrester type 1/2 - VAL-MS-T1/T2 48/12.5/2+0/1U/ FM - 2907042

Accessories

Wiring bridge - MPB F200X16/ 1GS - 2818339



Wiring bridge flexible, diameter 16 mm², with a fork-type cable lug on one side, length: 200 mm

Device marking

Zack marker strip - ZBN 18:UNBEDRUCKT - 2809128



Zack marker strip, Strip, white, unlabeled, can be labeled with: CMS-P1-PLOTTER, PLOTMARK, mounting type: snap into tall marker groove, for terminal block width: 18 mm, lettering field size: 18 x 5 mm, Number of individual labels: 5

Labeled device marker

Marker for terminal blocks - ZBN 18,LGS:ERDE - 2749589



Marker for terminal blocks, Strip, white, labeled, Horizontal: Grounding symbol, mounting type: snap into tall marker groove, for terminal block width: 18 mm, lettering field size: 18 x 5 mm, Number of individual labels: 5

Marker for terminal blocks - ZBN 18,LGS:L1-N,ERDE - 2749576



Marker for terminal blocks, Strip, white, labeled, Horizontal: L1, L2, L3, N, GND, mounting type: snap into tall marker groove, for terminal block width: 18 mm, lettering field size: 18 x 5 mm, Number of individual labels: 5

Marker pen

Marker pen - B-STIFT - 1051993



Marker pen, for manual labeling of unprinted Zack strips, smear-proof and waterproof, line thickness 0.5 mm

Lightning/surge arrester type 1/2 - VAL-MS-T1/T2 48/12.5/2+0/1U/ FM - 2907042

Accessories

Spare parts

Type 1/2 surge protection plug - VAL-MS-T1/T2 48/12.5 ST - 2801242



L-N replacement plug for VAL-MS-T1/T2 48/12.5 plug-in lightning/surge arrester.

Base element - VAL-MS BE/2+0/1U/FM - 2907037



Universal plug-in surge arrester base for up to 240 V applications with two conductors plus ground, with remote indication contact
