



Emergency Jumpstarter & Portable Power Bank

**12V -
300Amp**

A **POWERFUL** but compact **300Amp-(peak)** Emergency Jumpstarter for most 12V vehicles. **PLUS** a Power Bank that also provides **HOURS OF PORTABLE POWER** for smart phones, tablets and much more when out and about!

Please **READ & UNDERSTAND** these instructions carefully before operating this device, and retain for future reference.

It is recommended to charge the unit for at least 3 hours before any use.

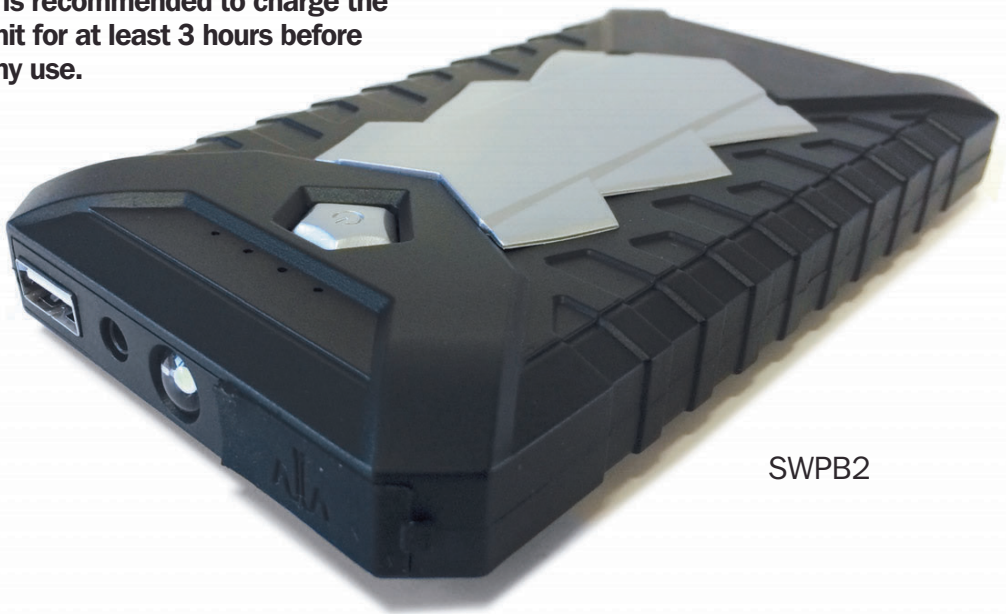

SWPB2

Emergency Jumpstart & Power Bank contents:

- Emergency Jumpstarter & Power Bank
- 12V Smart Jumpstart Cables (protects jumpstarter & vehicle battery).
- USB charge cable with 3 built-in assorted adaptors.
- 240V mains plug.
- 12V in-car charging plug.



General Information

This product is capable of starting most petrol engines up to 2000cc, and deisel engines up to 1600cc.

It can also be an additional power pack for your electronic devices. It has 1 car battery clamp socket (12V), 1 USB output (5V/ 2 A) and a flashlight.

Please note that some Apple® products may not charge if a non-Apple® charging cable is used. Charging products is done entirely at the users own risk.

Technical Specifications

- Output voltage: 12V
- Peak capacity: 8000mAh
- Dimensions: 125(L)x72(W)x18mm(H)
- Input charging ports: 6mm-15V, up to 1A/12V
Auto-12V, up to 1.5A
- Output ports: USB- 5V 2A
Auto jump starter-12V
- Charge mode: Constant Current/Constant Voltage 15V 1A
- Start Current: 150A
- Peak Current: 300A(2S)
- Cycle life: 1000 cycles @ 80 depth of discharge
- Application temperature range : - 10 °C to +50 °C. Cell performance may degrade at low temperature.
- Charging times- Wall charger: 1- 2 hours
Auto charger: 4 hours

Safety Information

Please read & understand this entire manual before attempting to use the product.

Warning

1. Do not damage, drop or crush this item. Do not attempt to use this item or battery charger that has been dropped, punctured, run over or damaged in any way.
2. Do not charge this item in wet conditions (rain, snow, damp). Do not use this product in explosive environments (dust, gaseous fumes, or flammable materials).
3. Do not burn or incinerate this product. It may explode, causing personal injury or damage. Toxic fumes and other potentially harmful materials are created when the battery is burned.
4. Do not disassemble this product. It may result in risk of fire, electric shock or exposure to battery chemicals.
5. Do not insert foreign objects into ANY input or output ports. This item may short circuit. Any metal that comes in contact with the jumper cable port may short circuit. Short circuiting this product will damage the battery and may cause personal injury or fire.
6. This is a Lithium ion battery. In the unlikely event that this product leaks battery chemicals, do not allow contact with skin, eyes or mouth as it may cause personal injury or burns. If skin is exposed to battery chemicals, wash with soap and water and rinse with vinegar. If your eyes come in contact with battery chemicals, immediately flush with water and then see a medical professional.
7. When recharging this item, make sure the area is well ventilated. Please do not smoke or allow open flames near a charging battery.
8. Never jump start a frozen battery.
9. Never reversely connect the red & black clamps when the original car battery has been removed, or the car might be compromised.
10. Please keep the product away from and out of reach of children.
11. Store this unit in a cool dry location. Do not expose the product to temperatures over 80°C or below -25°C.
12. It is recommended if the power bank is left unused for a period of time, to recharge the unit every 3 months.

Product Features

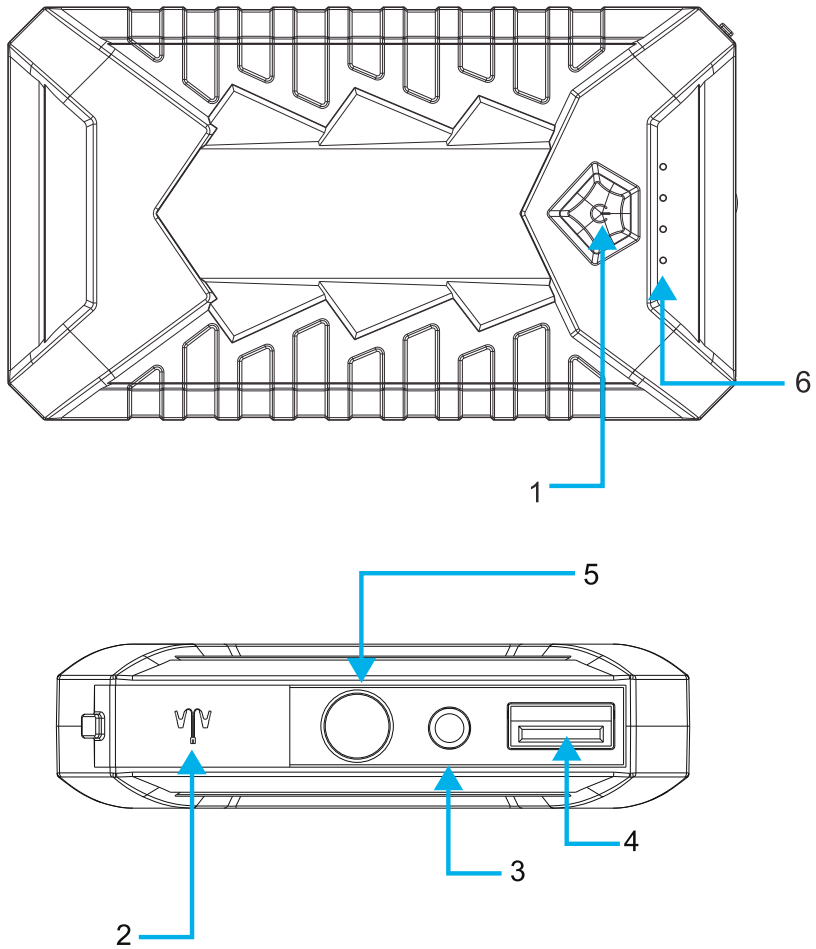

1. Power button
2. Battery terminal socket for the car start
3. 15 V/1A input
4. 5V/2A output
5. Flashlight
6. LED indicator

Package Contents

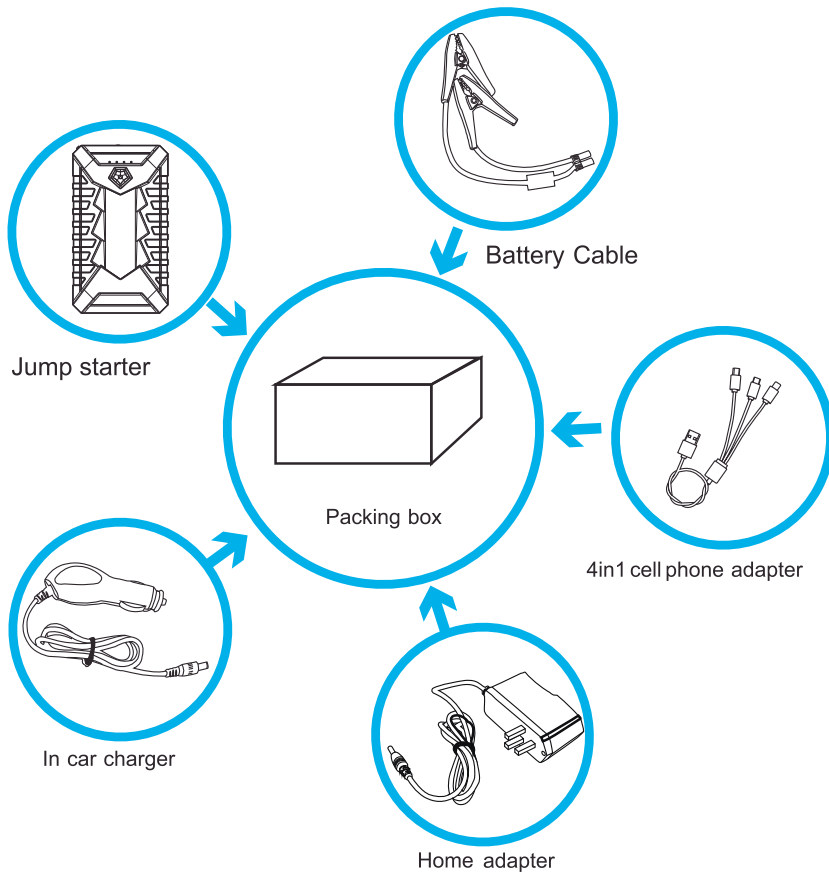

Function on Smart Battery Cable

- 1) Reverse polarity connection: Solid Red LED with fast 2 short beep.
- 2) Short-circuit protection: Solid Red LED with long beep (Beeping as 3.3Hz Frequency).
- 3) Over-heat protection: Solid Red LED with long beep (Beeping as 2Hz Frequency).
- 4) Over-discharging protection: Solid Red LED with 2 short beep.
- 5) Green/Red LED flashing: Searching for status connection.
- 6) Green LED: Correct connection after one beep.

Do not use any charger cable other than those specifically provided with the Jumpstarter/Powerbank for jumpstarting or charging.



Quick Guide

1. Jump Starting Vehicles

Before attempting to jump start your vehicle, please read your vehicle owners manual to insure there are no specific steps needed.

DO NOT crank the engine for more than 4 continuous seconds while the unit is connected to the battery. It is always recommended to jump start a vehicle with a full charge 4 LED's. NEVER try to jumpstart with less than 3 LED's showing. If the engine fails to crank or start, after a number of tries, there may be a problem other than a discharged battery.

1st step:

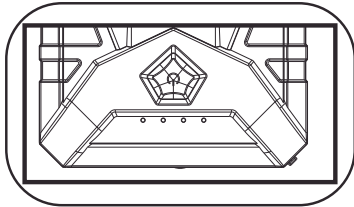

Make sure ≥ 3 indicator lights on

2nd step:

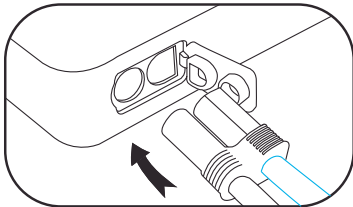

Insert the battery clamp to jump starter

3rd step:

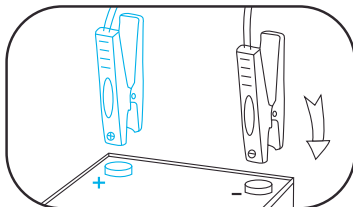

Connect red clamp with "+" of car battery, black clamp with "-"

5th step:

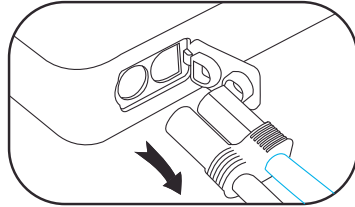

Remove the battery clamp from the jump starter and car battery

4th step:

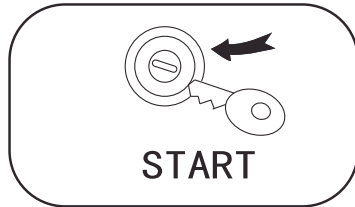

Car Start up

2. Charging Electronic Devices For Cell Phones/Tablets

1st step:

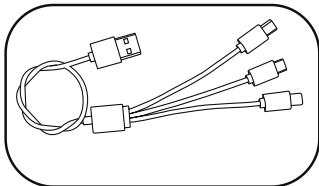

Choose a suitable cell phone connector

2nd step:

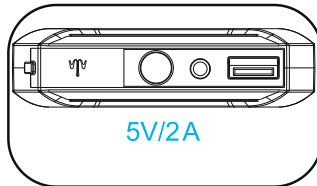

Insert the USB charging cable into 5V/2 A outlet of the jump starter

3rd step:

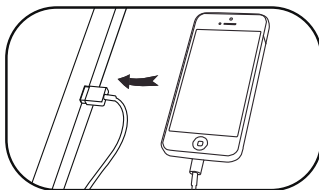

Insert the other side of charging cable into cell phone inlet

4th step:

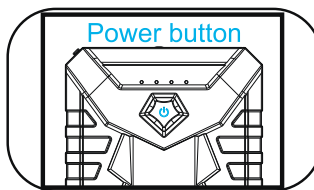

Short press , then your cell phone is under charging

For PSP, Digital Cameras/DVD

See the steps in “ for Cell phones/Tablets”

3. Charging

1st step:

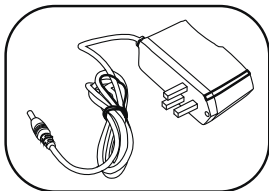

Choose the matched home adapter

2nd step:

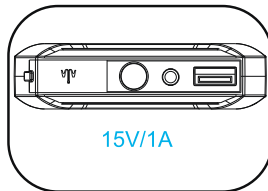

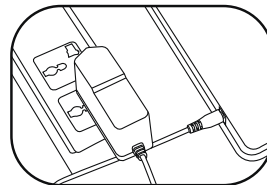

Insert  into 15V/1A input of the jump starter

3rd step:



Plug into household 230/240V socket, then it's charging when indication light flickers

4. Flashlight Operation

Press & hold  for 3 seconds to start flashlight
press  again to shift to SOS, flashing
press  again to turn off the flashlight

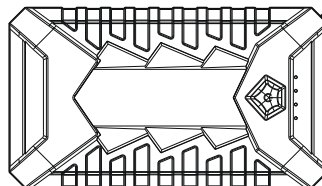



Trouble Shooting

Problem	Cause	Solution
No response when pressing the push button	Low voltage protection of jump start is activated	Charge the unit with home charger or car charger to deactivate the protection
Jump start shuts down automatically when charging multiple electronics devices at the same time	Over current protection of jump start is activated	Please make sure the total output current is within 3.5A

Warnings: The power bank will generate heat when charging. Use it in a well ventilated area when charging. Keep the power bank away from heat sources, direct sunlight, humidity, water or other liquids.

Do not operate the power bank if it is wet or damaged to prevent electrical shock, explosion and/or injury. Improper repairs of this device may place the user at risk. Do not use the power bank with wet hands.

Keep the input ports free from dust, lint, etc. which prevents good connections. Do not use this unit for anything other than its intended use.

The power bank is not a toy. Keep out of reach of children.

Do not charge under pillows, blankets. Do not store in a car during hot weather. Short-circuiting a Li-ion battery can cause it to ignite or explode. Never open a Li-ion battery's casing. Li ion batteries contain safety devices that protect the cells inside from abuse, if damaged these can cause the battery to ignite or explode.

Do not charge the power bank and charge an electronic device at the same time. This will shorten the power bank's battery life.

THE MANUFACTURER AND SUPPLIER HOLDS NO RESPONSIBILITY FOR DAMAGE CAUSED BY INCORRECT OR IMPROPER USE OF THE PRODUCT. PLEASE READ AND RETAIN THE INSTRUCTIONS.

The WEEE symbol  on this product means that this product should be ethically dismantled or recycled to minimise environmental impact. Please check with your local authority for more information.

IMPORTANT: ADDITIONAL SAFETY INFORMATION: This Jumpstarter & Power Bank is **NOT** intended for use by persons (including children) with reduced physical, sensory or mental capabilities, or lack of experience and knowledge, unless they are supervised or have been given instruction concerning use of the Jumpstart & Power Bank by a person responsible for their safety.

WARRANTY: The 12 month warranty on this product will need to be activated within 30 days of purchase, please go to our web site and click on the "Warranty" link and enter your details on the warranty screen. www.streetwizeaccessories.com.

Streetwize Accessories:

Unit 1, Royce Trading Estate, Ashburton Road West,
Trafford Park, Manchester M17 1RY

Sales enquiries: sales@streetwizeaccessories.com

Technical enquiries: support@streetwizeaccessories.com

Telephone: 0161 447 8597

www.streetwizeaccessories.com



M17 1RY