

# LED machine light - PLD M 260 W-85/95 540/D40/SC - 2702935

Please be informed that the data shown in this PDF Document is generated from our Online Catalog. Please find the complete data in the user's documentation. Our General Terms of Use for Downloads are valid (<http://phoenixcontact.com/download>)



LED machine light, 24 V DC, emission angle 85 °/95 °, color temperature 5000 K, length 540 mm, diameter 40 mm, M12 connector, Light housing: Anodized aluminum, Pane: Single-pane safety glass (ESG, thermally toughened float glass), pivoting, resistant to coolants and lubricants, can be switched in series

## Product Description

This LED machine light is designed to provide illumination inside or on machinery. You can use the light in harsh environments.

This is possible thanks to:

- The high degree of protection
- Resistance to common cooling agents and lubricants
- Resistance to vibrations and shock
- The 4 mm thick safety glass

The small diameter of just 40 mm enables mounting even where space is at a premium.

Mounting is by means of holders or brackets (neither of which are supplied as standard) in which the light can swivel and the lighting can therefore be optimally aligned.

To reduce the cabling effort for longer machines, the lights can be switched in series.

## Your advantages

- ✓ Space saving, thanks to the small diameter
- ✓ Plug-in supply line enables free choice of the cable length as well as quick and easy installation
- ✓ Focused illumination, thanks to swivel action
- ✓ IP67 protection and resistance to cooling agents and lubricants enables use in machine tools
- ✓ Can be used at high temperatures and can be subjected to strong vibrations and shocks
- ✓ Safety glass enables use even in environments with potential mechanical strain
- ✓ Minimal wiring effort, thanks to series connection
- ✓ ETL approval permits use on the North American market
- ✓ Particularly economical thanks to energy-efficient LED technology and an LED service life of at least 60,000 h



## Key Commercial Data

Packing unit	1 pc
GTIN	 4 055626 443782
GTIN	4055626443782
Weight per Piece (excluding packing)	1,100.000 g
Custom tariff number	94054099
Country of origin	Germany

# LED machine light - PLD M 260 W-85/95 540/D40/SC - 2702935

Note	Made to Order (non-returnable)
------	--------------------------------

## Technical data

### Dimensions

Width	40 mm
Height	30 mm
Length	540 mm
Note on dimensions	Length without M12 flush-type connector

### Ambient conditions

Ambient temperature (operation)	0 °C ... 50 °C
Ambient temperature (storage/transport)	-20 °C ... 75 °C
Permissible humidity (operation)	95 %
Permissible humidity (storage/transport)	95 % (non-condensing)
Air pressure (operation)	69 kPa ... 102 kPa
Air pressure (storage/transport)	69 kPa ... 102 kPa
Degree of protection	IP67

### General

Note	The PLD M-ME MC/D40 mounting holder (Order No. 2702491) or the PLD M-ME MB/D40 mounting bracket (Order No. 2702527) is required in order to mount the light.
Color	aluminum color
Net weight	1100 g
Mounting type	Screw mounting
Assembly instructions	Mounting with mounting holders or mounting brackets, please observe the notes in the package slip.
Mounting position	any

### Power supply for module electronics

Connection technology	M12 connector
Connection method	M12 connector, (A-coded)
Number of positions	4
Permissible conductor cross section	min. 0.34 mm <sup>2</sup>
Supply voltage	24 V DC
Supply voltage range	20 V DC ... 28 V DC
Current consumption	typ. 0.67 A (at 24 V DC)
Power consumption	approx. 16 W (at 24 V DC)
Type of protection	Surge protection
	Reverse polarity protection

### Connection data

Connection method	M12 connector, (A-coded)
-------------------	--------------------------

### Light properties

Source of light type	LED
Number of LEDs	42

# LED machine light - PLD M 260 W-85/95 540/D40/SC - 2702935

## Technical data

### Light properties

Service life, lighting appliance	60000 h (L70)
Light color	Neutral white
Color temperature / wavelength	5000 K
Color rendering index	80
Luminous flux	approx. 1680 lm (Net luminous flux)
Illumination	max. 732 lx (Distance of 1 m)
Average illumination	541 lx (Distance of 1 m over 1 m <sup>2</sup> area)
Emission angle	85 ° (C0-C180)

### Standards and Regulations

Mechanical tests	Vibration resistance in acc. with EN 60068-2-6/IEC 60068-2-6 4g
	Shock in acc. with EN 60068-2-27/IEC 60068-2-27 50g
Protection class	III (IEC 61140, EN 61140, VDE 0140-1)

## Drawings

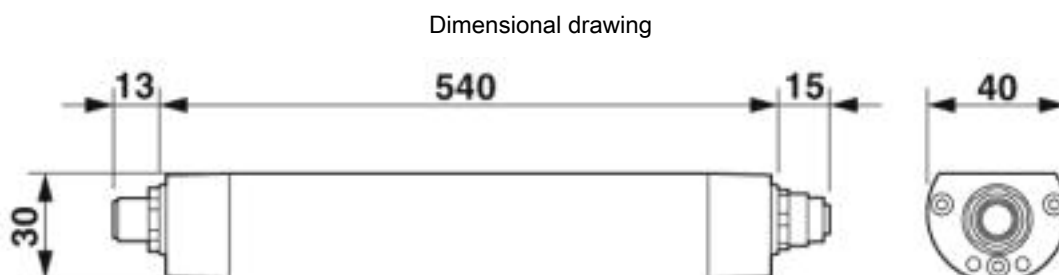

## Classifications

### eCl@ss

eCl@ss 5.1	27119101
eCl@ss 7.0	27119010
eCl@ss 8.0	27119010
eCl@ss 9.0	27110345

### ETIM

ETIM 3.0	EC000348
ETIM 4.0	EC000348
ETIM 5.0	EC000348
ETIM 6.0	EC000302
ETIM 7.0	EC000302

### UNSPSC

UNSPSC 6.01	39111510
UNSPSC 7.0901	39111510

# LED machine light - PLD M 260 W-85/95 540/D40/SC - 2702935

## Classifications

### UNSPSC

UNSPSC 11	39111510
UNSPSC 12.01	39111510
UNSPSC 13.2	39101601
UNSPSC 18.0	39101601
UNSPSC 19.0	39101601
UNSPSC 20.0	39101601
UNSPSC 21.0	39101601

## Approvals

### Approvals

#### Approvals

ETLus / cETL / cETLus

#### Ex Approvals

### Approval details

ETLus		<a href="http://www.intertek.com">http://www.intertek.com</a>	LV-Lighting-Systems
-------	--	---	---------------------

cETL		<a href="http://www.intertek.com">http://www.intertek.com</a>	Luminaires
------	--	---	------------

cETLus			
--------	--	--	--

## Accessories

### Accessories

Sensor/actuator cable

## LED machine light - PLD M 260 W-85/95 540/D40/SC - 2702935

### Accessories

Sensor/actuator cable - SAC-4P- 1,5-PUR/M12FS - 1668108



Sensor/actuator cable, 4-position, PUR halogen-free, black-gray RAL 7021, free cable end, on Socket straight M12, A-coded, cable length: 1.5 m

---

Sensor/actuator cable - SAC-4P- 3,0-PUR/M12FS - 1668111



Sensor/actuator cable, 4-position, PUR halogen-free, black-gray RAL 7021, free cable end, on Socket straight M12, A-coded, cable length: 3 m

---

Sensor/actuator cable - SAC-4P- 5,0-PUR/M12FS - 1668124



Sensor/actuator cable, 4-position, PUR halogen-free, black-gray RAL 7021, free cable end, on Socket straight M12, A-coded, cable length: 5 m

---

Sensor/actuator cable - SAC-4P- 1,5-PUR/M12FR - 1668221



Sensor/actuator cable, 4-position, PUR halogen-free, black-gray RAL 7021, free cable end, on Socket angled M12, A-coded, cable length: 1.5 m

---

Sensor/actuator cable - SAC-4P- 3,0-PUR/M12FR - 1668234



Sensor/actuator cable, 4-position, PUR halogen-free, black-gray RAL 7021, free cable end, on Socket angled M12, A-coded, cable length: 3 m

---

## LED machine light - PLD M 260 W-85/95 540/D40/SC - 2702935

### Accessories

Sensor/actuator cable - SAC-4P- 5,0-PUR/M12FR - 1668247



Sensor/actuator cable, 4-position, PUR halogen-free, black-gray RAL 7021, free cable end, on Socket angled M12, A-coded, cable length: 5 m

---

### Necessary add-on products

Mounting holder - PLD M-ME MC/D40 - 2702492



Mounting holder, AlMgSi0,5: Aluminum, for machine lights PLD M 260 .../D40, Swiveling range  $\pm 20^\circ$

Mounting brackets - PLD M-ME MB/D40 - 2702527



Mounting brackets, stainless, 2A (X5CrNi-18-10): Steel, for machine lights PLD M 260 .../D40, Swiveling range  $\pm 45^\circ$