

## Protective covers - EV-T2SC - 1405217

Please be informed that the data shown in this PDF Document is generated from our Online Catalog. Please find the complete data in the user's documentation. Our General Terms of Use for Downloads are valid (<http://phoenixcontact.com/download>)



Self-closing protective cover for infrastructure socket outlet, Type 2, IEC 62196-2, Front mounting, screwed on the front, Rear protective cover screw connection, With imprinted Phoenix Contact logo, M5 thread

### Product Description

Self-closing protective cover for infrastructure socket outlet

### Your advantages

- ✓ Certified in accordance with IATF 16949:2016 and ISO 9001:2015

### Key Commercial Data

Packing unit	1 pc
GTIN	 4 046356 738507
GTIN	4046356738507
Weight per Piece (excluding packing)	108.200 g
Custom tariff number	39269097
Country of origin	Germany
Note	Made to Order (non-returnable)

### Technical data

#### Product definition

Product type	Self-closing protective cover for infrastructure socket outlet
Type	Rear protective cover screw connection
	With imprinted Phoenix Contact logo
Standards/regulations	IEC 62196-2
Charging standard	Type 2
Charging mode	Mode 3, Case B

#### Dimensions

Height	93.7 mm
Width	85 mm

# Protective covers - EV-T2SC - 1405217

## Technical data

### Dimensions

Depth	32.5 mm
Bore dimensions	60 mm x 60 mm

### Ambient conditions

Ambient temperature (operation)	-30 °C ... 50 °C
Ambient temperature (storage/transport)	-40 °C ... 80 °C
Degree of protection	IP54
Degree of protection (IK)	IK08

### Mechanical properties

Cover mechanism	Self-closing
-----------------	--------------

### Mounting

Possible mounting positions	Front mounting, screwed on the front
Required mounting screws	M5 thread

### Design

Design line	Standard
Housing color	black
Customer variations	On request

### Material

Material	Plastic
----------	---------

### Environmental Product Compliance

REACH SVHC	Lead 7439-92-1
China RoHS	Environmentally friendly use period: unlimited = EFUP-e
	No hazardous substances above threshold values

## Drawings

## Protective covers - EV-T2SC - 1405217

Dimensional drawing

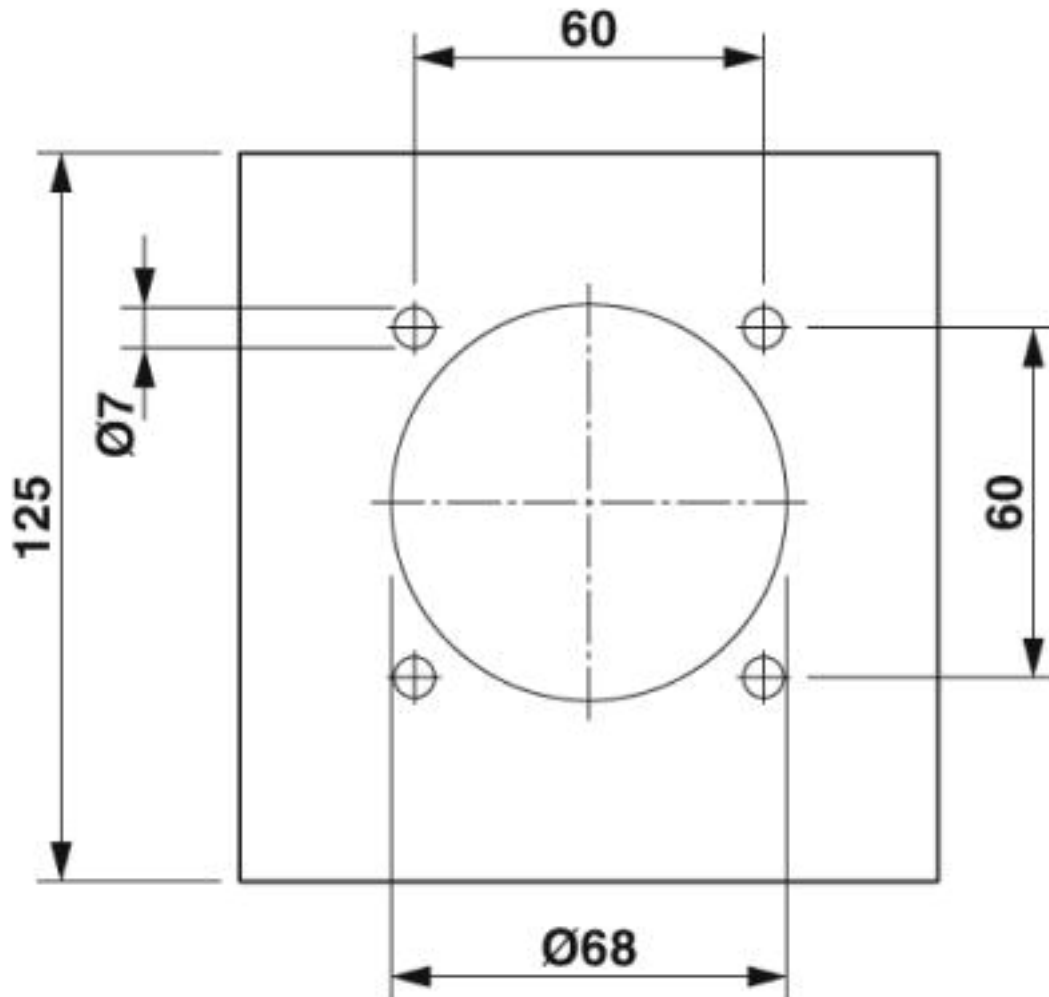

Hole image

# Protective covers - EV-T2SC - 1405217

Dimensional drawing

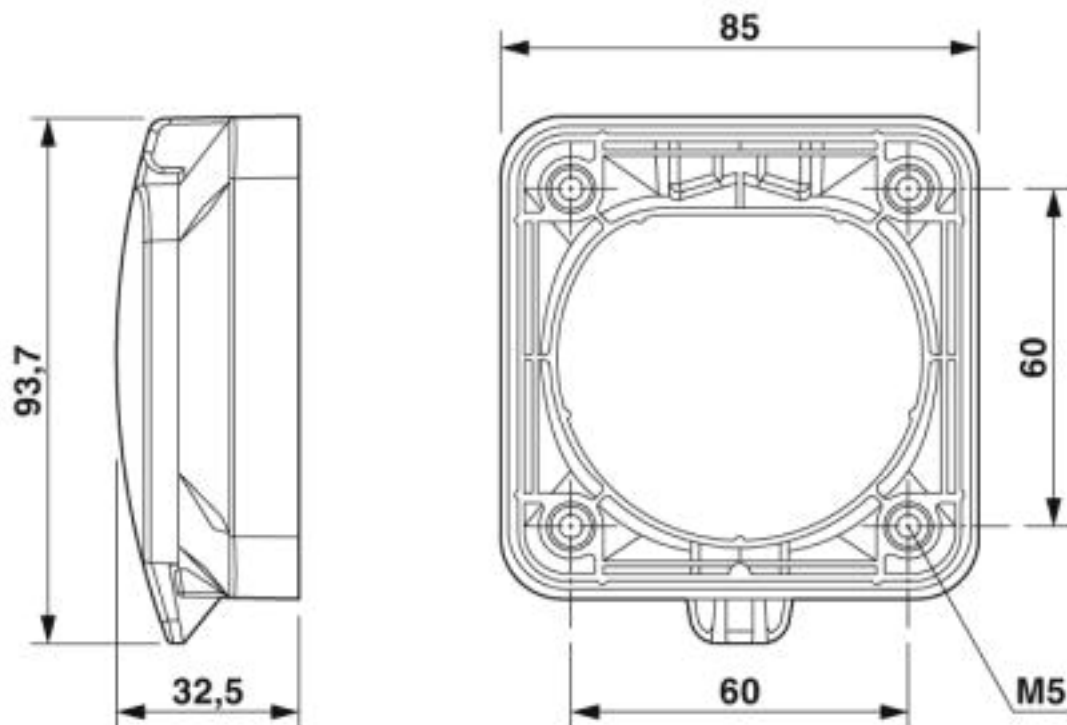

Dimensional drawing

## Protective covers - EV-T2SC - 1405217

Schematic diagram

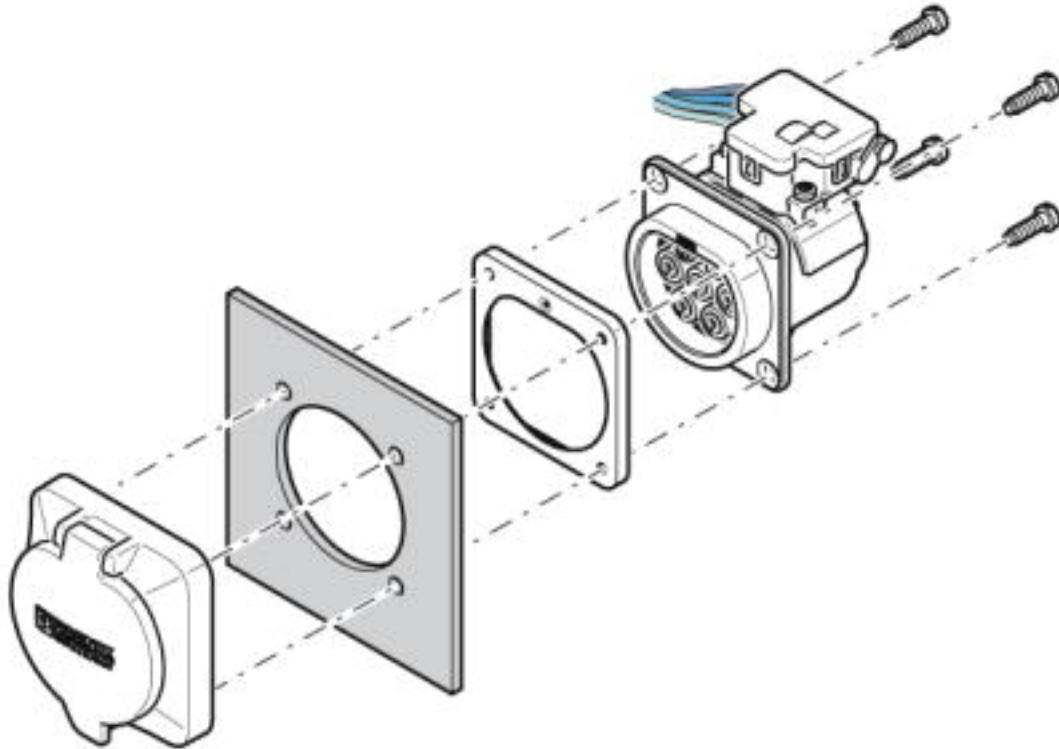

### Rear mounting with rear protective cover screw connection

The screw connection for a protective cover from the accessories range (EV-T2SC) only supports rear mounting. The panel thickness must not exceed 5 mm. The sealing frame that is slid on from the rear must contact the housing panel flush with the flat side and must completely surround the infrastructure socket outlet.

# Protective covers - EV-T2SC - 1405217

Schematic diagram

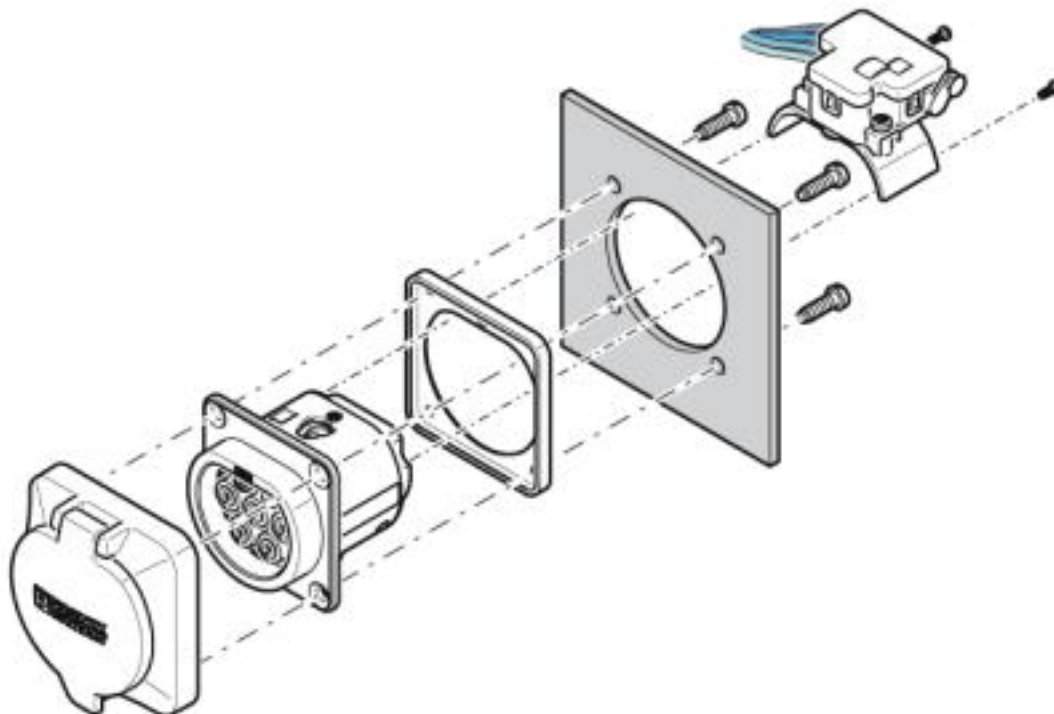

### Front mounting with rear protective cover screw connection

Front mounting is only possible when the locking actuator is removed. We recommend using an infrastructure socket outlet without pre-assembled locking actuator (EV-T2M3SE-...E0..., e.g., 1621729).

The screw connection for a protective cover from the accessories range (EV-T2SC) only supports rear mounting. The panel thickness must not exceed 10 mm. The sealing frame that is slid on from the front must contact the housing panel flush with the flat side and must completely surround the infrastructure socket outlet.

## Classifications

eCl@ss

eCl@ss 10.0.1	27144792
eCl@ss 4.0	27141200
eCl@ss 4.1	27141200
eCl@ss 5.0	27149100
eCl@ss 5.1	27149100
eCl@ss 6.0	27261200
eCl@ss 7.0	27440208
eCl@ss 8.0	27440208
eCl@ss 9.0	27144792

ETIM

ETIM 2.0	EC000241
ETIM 3.0	EC002061
ETIM 4.0	EC002061

# Protective covers - EV-T2SC - 1405217

## Classifications

### ETIM

ETIM 5.0	EC002314
ETIM 6.0	EC002884
ETIM 7.0	EC002884

### UNSPSC

UNSPSC 6.01	30211923
UNSPSC 7.0901	39121522
UNSPSC 11	39121522
UNSPSC 12.01	39121522
UNSPSC 13.2	39121522
UNSPSC 18.0	39121522
UNSPSC 19.0	39121522
UNSPSC 20.0	39121522
UNSPSC 21.0	39121522

## Accessories

### Accessories

#### Infrastructure socket outlet

Socket Outlet - EV-T2M3SE12-3AC32A-0,7M6,0E10 - 1405214



Infrastructure Socket Outlet for charging electric vehicles with alternating current (AC), compatible with Infrastructure Plugs, Type 2, IEC 62196-2, 32 A / 480 V (AC), 12 V Locking actuator, Single wires, length: 0.7 m, Rear panel mounting, Rear protective cover screw connection

Socket Outlet - EV-T2M3SE24-3AC32A-0,7M6,0E10 - 1405216



Infrastructure Socket Outlet for charging electric vehicles with alternating current (AC), compatible with Infrastructure Plugs, Type 2, IEC 62196-2, 32 A / 480 V (AC), 24 V Locking actuator, Single wires, length: 0.7 m, Rear panel mounting, Rear protective cover screw connection