

Enquiry N°: 1858

Created by: WT / Approved by: DB

SERVO MOTOR

115UDB306BFCAA



Definition

Type	Unimotor HD	
Frame Size (mm)	115	
Voltage	U	400 V
Magnet type	D	High Dynamic
Frame Length	B	
Speed (min ⁻¹)	30	3000
Brake	6	Braked
Connection type	B	Power and Signal 90° rotatable (Size 1)
Output shaft	F	Key and half key supplied in bag
Feedback device code	CA	4096 ppr Incremental encoder (CFS50)
Inertia & thermistor	A	Standard inertia + PTC thermistor
PCD	130	130 (FF 130 / 110)
Shaft Diameter	240	24j6 x 50.0
Fan Box	-	
Insulation class	F	
UL Motor / UL Stator	UL Motor / UL Stator	

Nominal characteristics

Motor Ambient Temperature (°C)	40	Drive Fsw (kHz)	12
Motor Stall Torque (N.m)	10.2	Stall Current (A)	6.38
Rated Torque (N.m)	7.7	Nominal Current (A)	4.81
Motor Peak Torque (N.m)	30.6	Kt (Nm/A)	1.6
Rated Power (kW)	2.42	Ke (V/kmin ⁻¹)	98.0
Winding Thermal Time Constant (s)	164	R (ph-ph) (Ohm)	1.83
Number of Poles	10	L (ph-ph) (mH)	16.93
Maximum Cogging (N.m)	0.3		
Inertia (kg.cm ²)	5.29	Weight (kg)	8.7
Ingress Protection Level (IP)	IP65		
Brake	Type 6	Static Torque (N.m)	16
Release Time (ms)	105	Backlash (°)	0.38
Brake Supply Voltage (V)	24	Brake Coil Power (W)	17.5

Torque / speed graph

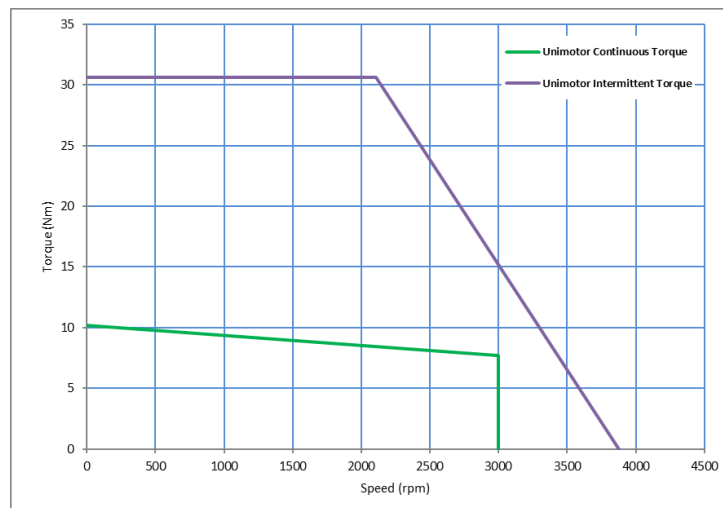

SERVO MOTOR

Motors (° & mm)

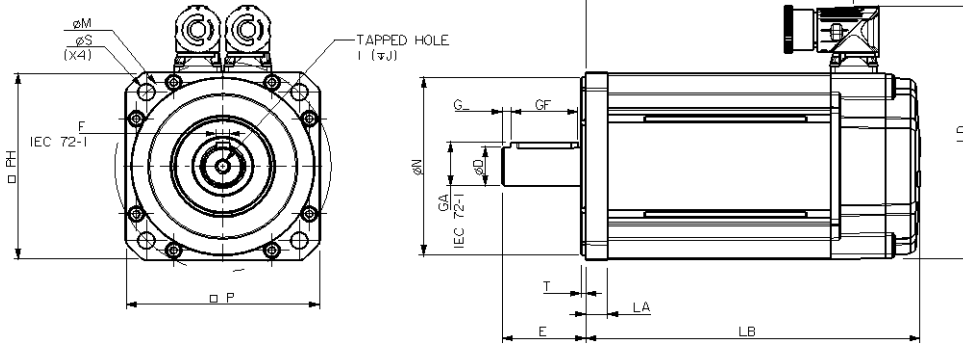

LB	Total length	243.9
LC	Power connector position	191.1
LA	Flange thickness	13.2
T	Register Length	2.7
N	Register Diameter	110.0
LD	Connector overall height	156.5
P	Flange Square	116.0
S	Fixing Hole Diameter	10.0
M	Fixing hole PCD	130.0
PH	Motor Housing Width	115.0
D	Shaft Diameter	24j6
E	Shaft Length	50.0
GA	Key Height	27.0
GF	Key Length	40.0
G	Key to Shaft End	5.3
F	Key Width	8.0
I	Tapped Hole Thread Size	M8 x 1.25
J	Tapped Hole Depth	20.0
	Mounting Bolt	M8

Motor electrical interface Connectors option:

Feedback device code: CA – 4096 ppr Incremental encoder (CF550)

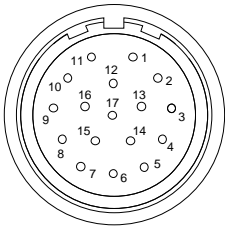

- | | |
|----------------|------------|
| 1 - Thermistor | 10 - A |
| 2 - Thermistor | 11 - Z |
| 3 - - | 12 - Z/ |
| 4 - U | 13 - A/ |
| 5 - U/ | 14 - B |
| 6 - V | 15 - B/ |
| 7 - V/ | 16 - Power |
| 8 - W | 17 - 0 V |
| 9 - W/ | Screen |

Connection type: B – Power and Signal 90° rotatable (Size 1)

