

1. Safety switches with separate actuator / Class 2
1.27 ST 14 range

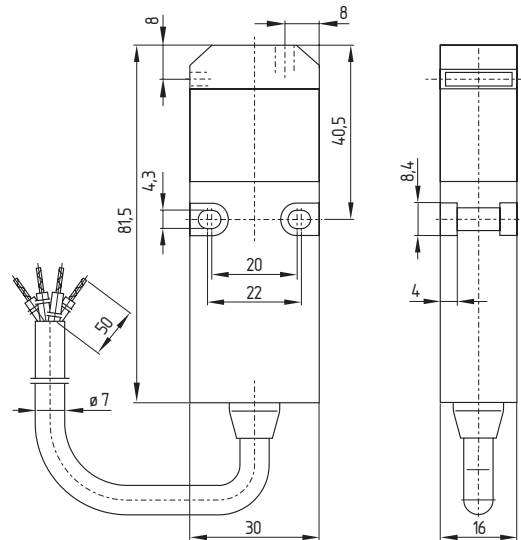

Features

- Thermoplastic enclosure
- Slim design
- Multiple coding
- Long life
- Double insulated
- High level of contact reliability with low voltages and currents
- Pre-wired with 1 m cable
- Actuator with rubber mountings
- EEx version see chapter 14.1.1.2

**Contacts/
Switch travel**

1 NO
1 NC

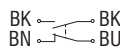

2 NC

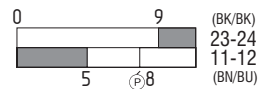
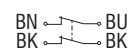

Standard version

ST 14 1Ö/1S



ST 14 2Ö

Notes

Inserted position of actuator = 0 in switch travel diagrams.
 Actuators must be ordered separately.
 A selection of suitable actuators can be found in 1.28.

1. Safety switches with separate actuator / Class 2

1.27 ST 14 range



Cable lengths

- 2 metres long, Ordering suffix -2m
 - 5 metres long, Ordering suffix -5m
 - 10 metres long, Ordering suffix -10m
- Other cable lengths possible on enquiry.

Ordering details

To order, select the part number of the desired switch from the table "Contacts/Switch travel", e.g. safety switch with two NC contacts, 2 m long cable: ST 14 2Ö-2m

Actuators and accessories must be ordered separately, e.g. angled actuator: ST 14-B5

The applicable ordering suffix is added at the end of the part number of the safety switch.
Further variants not shown here are available on enquiry.

Info

- Alternative version with side cable entry, ordering suffix -s, e.g. ST14 1Ö/1S-s

Approvals



D



USA



CAN



Straight actuator ST 14-B1

- On hinged guards, minimum actuating radius 140 mm
- Damps vibration on guards



- The axis of the hinge should be 30 mm above the top edge of the safety switch and in the same plane

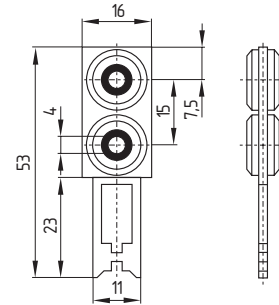

Adjustable actuator ST 14-B3

- Particularly suitable for hinged guards
- For very small actuating radii at 90° to the plane of the actuator
- Minimum actuating radius 50 mm on hinged guards

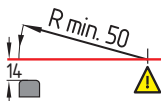

- The axis of the hinge should be 14 mm above the top edge of the safety switch and in the same plane

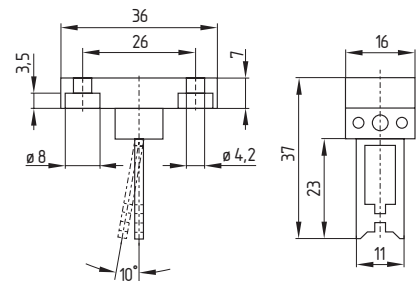

Angled actuator ST 14-B5

- Particularly suitable for hinged guards
- Minimum actuating radius 140 mm on hinged guards



- The axis of the hinge should be 15 mm above the top edge of the safety switch and in the same plane

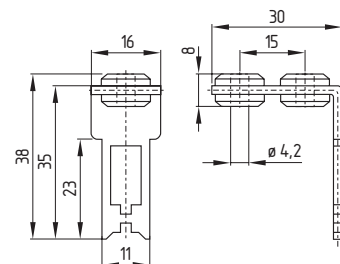

1. Safety switches with separate actuator / Class 2
1.29 Technical data



ST 14

Standards: IEC/EN 60947-5-1/DIN VDE 0660-200; EN 1088; BG-GS-ET-15

Enclosure material: Glass-fibre reinforced thermoplastic, self-extinguishing

Actuator: Stainless steel 1.4301

Protection class: IP 67 to IEC/EN 60529/DIN VDE 0470-1

Contact material: Silver

Contact type: Changeover with double break Zb
 or 2 NC contacts

Switching system: ⊖ IEC 60947-5-1; ⊕ BG-GS-ET-15; slow action, NC contact with positive break

Termination: Pre-wired cable H05/VV-F4 x 0.75 mm²
 1 m, 2 m, 5 m or 10 m long

Rated impulse

withstand voltage U_{imp} : 4 kV

Rated insulation

voltage U_i : 250 V

Thermal test current I_{th} : 10 A

Utilisation category: AC-15

Rated operating

current/voltage I_e/U_e : 4 A/230 V

Max. fuse rating: 6 A (slow blow)

Positive break travel: 5 mm

Positive break force: Min. 15 N

Ambient temperature: - 20 °C ... + 80 °C

Mechanical life: > 1 million operations

