

A range of diecast boxes in various sizes, manufactured in a robust aluminium alloy. These lightweight enclosures provide excellent screening against EMI/RFI and are therefore ideal housing for electronic components and circuits.

The close fitting lid is secured using four, six or eight countersunk screws. Also available with integral PCB guides.

The box is fitted with a self-adhesive rubber seal, providing IP66 rating.

Material :Aluminium Alloy LM24
 Box & Lid :Aluminium Alloy LM24
 Screws :Stainless Steel M3.5x12
 Seal :Neoprene Closed cell, black
 Finish :60-80 microns Powder coating

Admiralty Grey
 BS4800 REF18B25

Black RAL 9005

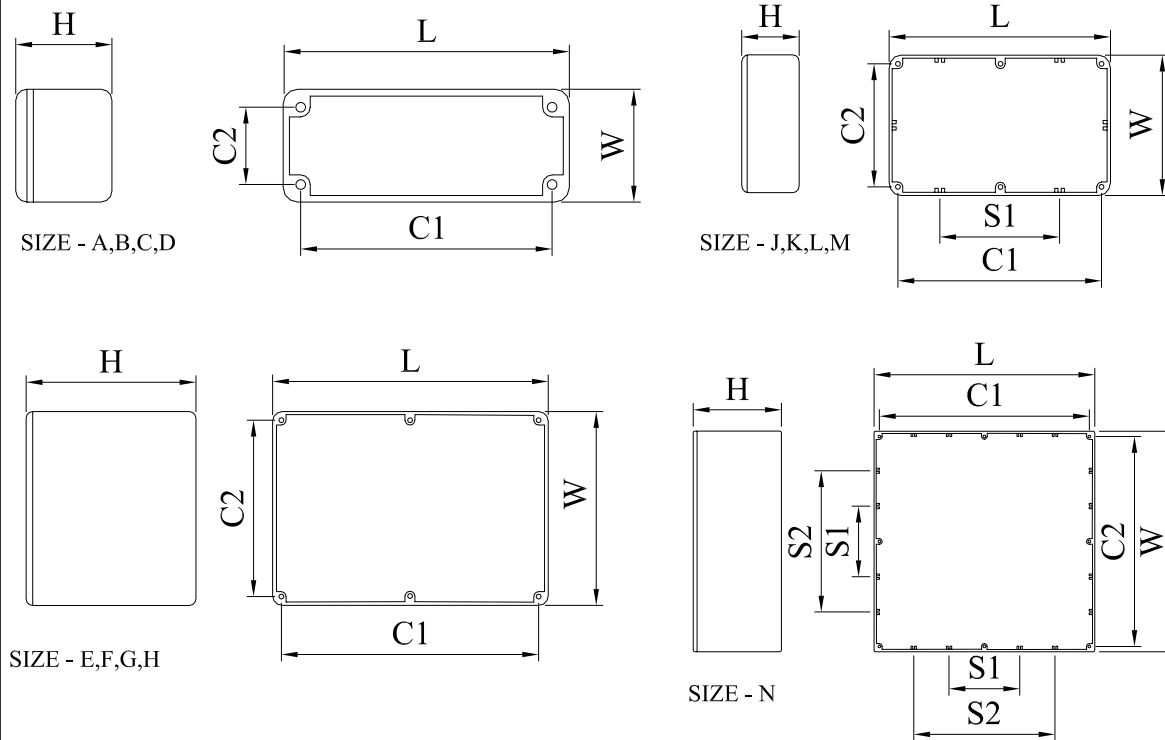

Add letter after order code for colour required.
 Black - E

TAPER 1.5° PER SIDE

Part No	Size	L	W	H	C1	C2	S1	S2	Wall Thickness	Taper
453-0010	A	88.9	34.9	30.5	79.4	25.4			1.5mm	Base to Lid
453-0020	B	114.5	64	30.5	104.6	54.1			1.5mm	Lid to Base
453-0030	C	115.7	90.5	55.9	104.6	79.4			1.5mm	Lid to Base
453-0040	D	115.3	64.5	55.9	103.4	52.5			2.0mm	Lid to Base
453-0050	E	171.5	120.6	55.9	160.5	109.6			2.0mm	Base to Lid
453-0060	F	171.5	120.6	106.7	160.5	109.6			2.0mm	Base to Lid
453-0070	G	222.3	146	56	211.5	135.3			2.0mm	Base to Lid
453-0080	H	222.3	146	106.7	211.5	135.3			2.0mm	Base to Lid
453-0090	J	275	175	66	264	164	132		2.0mm	Base to Lid
453-0100	K	139.7	101.6	77	128.7	90.6	64.4		2.0mm	Base to Lid
453-0110	L	165	127	77	154.1	116	77		2.0mm	Base to Lid
453-0120	M	120	100	36	108.3	88.2	50		2.0mm	Base to Lid
453-0130	N	250	250	101	238	238	80	160	2.5mm	Base to Lid

DrgNo 453 SERIES

TITLE POWDER COATED GREY IP66 SEALED DIECAST BOX

ALL DIMENSIONS IN MM
 ANGLES IN DECIMAL DEGREES

DELTRON Components

ISSUE 2

GENERAL SPECIFICATION
 FOR 453 SERIES

CUSTOMER

FILTER REF

Aprvd Date 01/12/03

Aprvd By BS

Drwn by BS

Scale: NTS

Sheet 1 / 1