

1 2 3 4 5 6

A

B

C

D

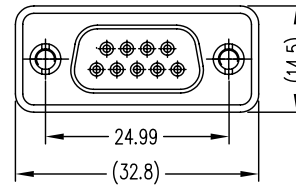
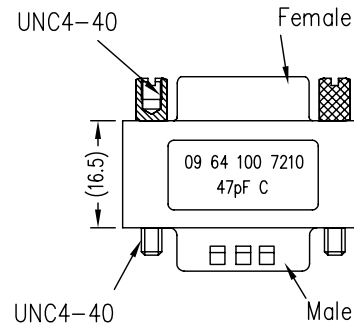
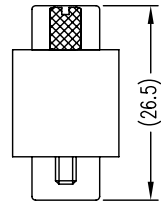
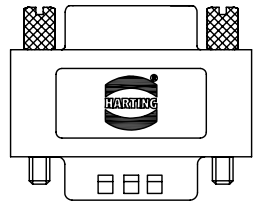

Specification

Filter type	C
Capacitance	47pf±20%
Working Voltage	100V
Current rating	6.5 A

Minimum Insertion Loss

FREQUENCY (MHz)	ATTENUATION dB
5	-
10	-
50	-
100	-
500	30dB
1000	35dB

Notes

Screws are not pre-mounted to allow mounting from any ends

All Dimensions in mm Original Size: DIN A 4			Techn. Character.			Free size tolerances			
				Dat.	Name	Scale	Male/Female D-Sub Filter Adapter 9pin, 47pF		
			Detail.	03.09.07	J.S.				
			Insp.	03.09.07	J.S.				
			Stand.						
			Zhuhai HARTING Limited				TB 09 64 100 7210		Page
Mod.	Dat.	Name					Sub.		