

1 2 3 4 5 6

A

B

C

D

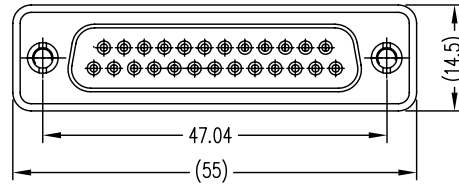
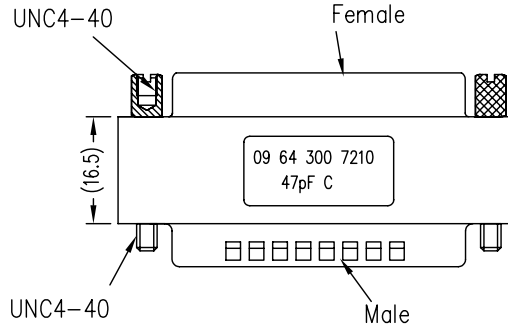
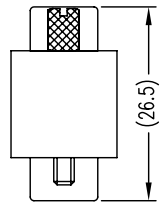
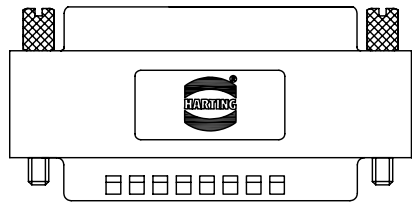

Specification

| | |
|-----------------|----------|
| Filter type | C |
| Capacitance | 47pF±20% |
| Working Voltage | 100V |
| Current rating | 6.5 A |

Minimum Insertion Loss

| FREQUENCY (MHz) | ATTENUATION dB |
|-----------------|----------------|
| 5 | - |
| 10 | - |
| 50 | - |
| 100 | - |
| 500 | 30dB |
| 1000 | 35dB |

Notes

Screws are not pre-mounted to allow mounting from any ends

| | | | | | | |
|---|-------------------|---------|-----------------------|---|--------------|------|
| <p>All Dimensions in mm Original Size DIN A 4</p> | Techn. Character. | | | Free size tolerances | | |
| | | Dat. | Name | | Scale 1:1 | |
| | | Detail. | 03.09.07 | | | J.S. |
| | | Insp. | 03.09.07 | | | J.S. |
| | | Stand. | | | | |
| | | | | Male/Female D-Sub Filter Adapter 25pin, 47pF | | |
| Mod. | Dat. | Name | Zuhai HARTING Limited | TB 09 64 300 7210 | | |
| | | | | Page Sub. | | |