

# EPIC® H-B 10 Housings

Housing style H-B. The industry standard.



## H-B 10 TGB

### Suitable inserts:

- EPIC® H-BVE 3 Screw termination see page 453
- EPIC® H-BVE 3 Cage clamp see page 453
- EPIC® H-DD 42 see page 440
- EPIC® H-EE 18 see page 449
- EPIC® MCR 10 see page 462
- EPIC® H-BE 10 Screw termination see page 444
- EPIC® H-BE 10 Crimp termination see page 444
- EPIC® H-BE 10 Cage clamp see page 444



## H-B 10 TGBH



## H-B 10 TS

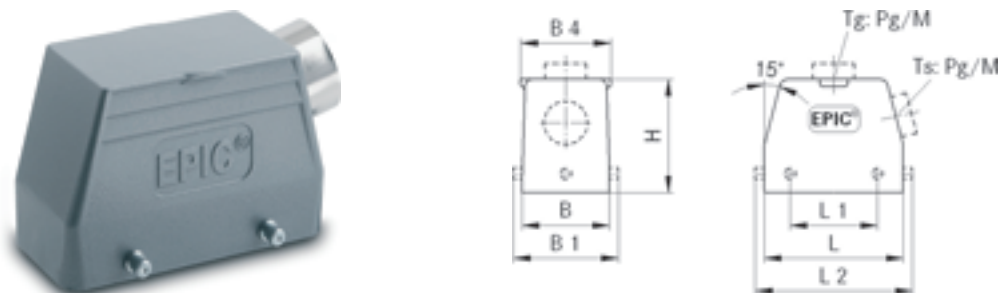

Part number	Part	PG	M	ZW	L	L1	B	B1	B2	H	s
<b>H-B housing: Hood (straight cable entry, double lever)</b>											
10041000	H-B 10 TGB 16	16		yes	73	27	43	57,8	53	52	116
19041000	H-B 10 TGB M20		20		73	27	43	57,8	53	52	116
79055700	H-B 10 TGB M25		25		73	27	43	57,8	53	52	116
<b>H-B housing: Hood (straight cable entry, double lever, high version)</b>											
70055200	H-B 10 TGBH 21	21		yes	73	27	43	57,8	53	72	116
70055400	H-B 10 TGBH 29	29		yes	73	27	43	57,8	53	72	116
79055200	H-B 10 TGBH M25		25		73	27	43	57,8	53	72	116
79055400	H-B 10 TGBH M32		32		73	27	43	57,8	53	72	116
<b>H-B housing: Hood (side cable entry, bolts for double lever)</b>											
10042000	H-B 10 TS 16	16		yes	73	27	43	57,8		52	
10042100	H-B 10 TS 21	21		yes	73	27	43	57,8		52	
19042000	H-B 10 TS M20		20	yes	73	27	43	57,8		52	
19042100	H-B 10 TS M25		25	yes	73	27	43	57,8		52	

# EPIC® H-B 10 Housings

Housing style H-B. The industry standard.



## H-B 10 AG-LB

### Suitable inserts:

- EPIC® H-BVE 3 Screw termination see page 453
- EPIC® H-BVE 3 Cage clamp see page 453
- EPIC® H-DD 42 see page 440
- EPIC® H-EE 18 see page 449
- EPIC® MCR 10 see page 462
- EPIC® H-BE 10 Screw termination see page 444
- EPIC® H-BE 10 Crimp termination see page 444
- EPIC® H-BE 10 Cage clamp see page 444

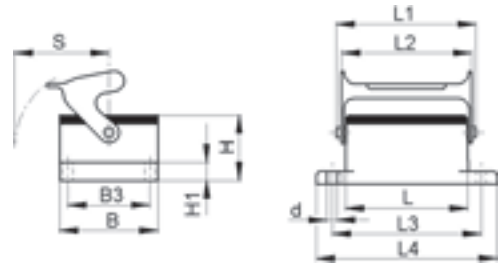

## H-B 10 AD-LB

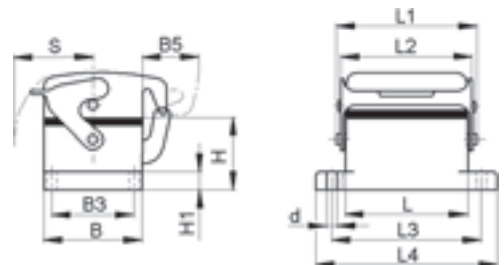

## H-B 10 AG

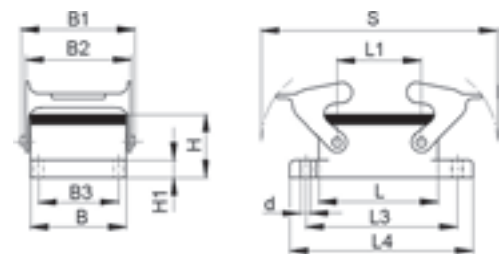

Part number	Part	L	L1	L2	L3	L4	B	B1	B2	B3	B5	H	H1	s	d
<b>H-B housing: Panel mount base (single lever)</b>															
10032900	H-B 10 AG-LB	73	91	88,5	83	93	43			32		27,8	4	50	4,3
<b>H-B housing: Panel mount base (cover, single lever)</b>															
10033900	H-B 10 AD-LB	73	91	88,5	83	93	43			32	25	27,8	4	50	4,3
<b>H-B housing: Panel mount base (double lever)</b>															
10032000	H-B 10 AG	73	27		83	93	43	57,8	53	32		27,8	4	116	4,3

# EPIC® H-BE Inserts

The standard inserts with screw termination, crimp termination and cage clamp termination



## H-BE 10 screw termination

The characteristic qualities of the proven EPIC® H-BE series are their suitability for applications with high voltages and current as well as their high reliability.

Ranges of application:

From machine building to control cabinet manufacturing, Light & Sound, polymer engineering

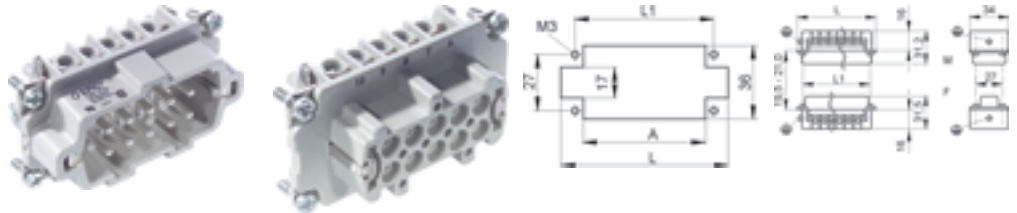

## Suitable housing:

EPIC® H-B 10 Housings see page 489

## H-BE 10 crimp termination

### Suitable housing:

EPIC® H-B 10 Housings see page 489

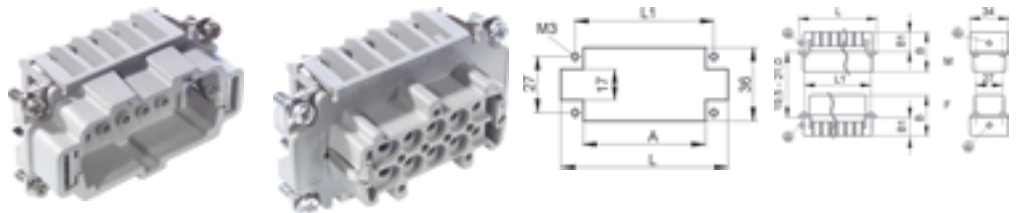

## Suitable contacts:

EPIC® H-BE 2,5 machined contacts see page 466

## H-BE 10 cage clamp

### Suitable housing:

EPIC® H-B 10 Housings see page 489

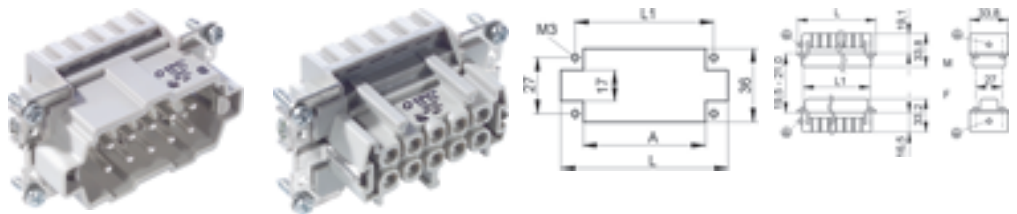

## Technical Data

Rated voltage  
IEC: 500 V  
UL: 600 V  
CSA: 600 V

Rated impulse Voltage  
6 kV

Rated current  
IEC: 16 A  
UL: 16 A  
CSA: 16 A

Pollution degree  
3

Contact resistance  
EPIC® H-BE 10 Screw termination  
< 2 mOhm  
EPIC® H-BE 10 Crimp termination  
< 2 mOhm  
EPIC® H-BE 10 Cage clamp  
1.5 - 4 mOhm

Contacts  
EPIC® H-BE 10 Screw termination  
Copper alloy, hard silver plated  
EPIC® H-BE 10 Crimp termination  
Copper alloy, hard silver / gold plated  
EPIC® H-BE 10 Cage clamp  
Copper alloy, hard silver plated

Numbers of contacts  
10 + PE

Termination methods  
EPIC® H-BE 10 Screw termination  
Screw termination: 0.5 - 2.5 mm<sup>2</sup>  
EPIC® H-BE 10 Crimp termination  
Crimp termination: 0.5 - 4.0 mm<sup>2</sup>  
EPIC® H-BE 10 Cage clamp  
Cage clamp termination: 0.5 - 2.5 mm<sup>2</sup>

Cycle of mechanical operation  
100

Range of temperature  
-40°C - +100°C, temporary up to +125°C

Part number	Part	Version	Type	Wire protection	Contacts	L	L1	A	B	B1
<b>H-BE 10 screw termination</b>										
10192000	H-BE 10 SS	male		yes	1 - 10	64	57	52		
10193000	H-BE 10 BS	male		yes	1 - 10	64	57	52		
10192100	H-BE 10 SS	male		-	1 - 10	64	57	52		
10193100	H-BE 10 BS	male		-	1 - 10	64	57	52		
<b>H-BE 10 crimp termination</b>										
10182000	H-BE 10 SCM	male	machined		1 - 10	64	57	52	33	18
10183000	H-BE 10 BCM	male	machined		1 - 10	64	57	52	34	18
<b>H-BE 10 cage clamp termination</b>										
10400100	H-BE 10 SF	male			1 - 10	62,8	57	52		
10401100	H-BE 10 BF	male			1 - 10	62,8	57	52		

VDE approval is not valid for applications using the cage clamp termination

# 5.1 EPIC® CERTOSA M & PG

Kabelverschraubungen metrisch / Cable glands metric thread / Presse-étoupes pas métrique

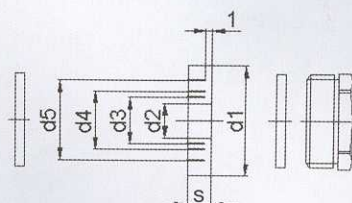

## EPIC® SM-M

Artikel part article	Art.Nr. part No. N° art.	M metric thread pas métrique	d1	d2	Kabel Ø cable Ø câble Ø	d3	Kabel Ø cable Ø câble Ø	d4	Kabel Ø cable Ø câble Ø	d5	Kabel Ø cable Ø câble Ø	S	SW mm opening of the spanner ouverture de clef	VPE packing unit condition- nement
SM-M12	71200000	12	10	5	4-6							5	12	5
SM-M16	71200100	16	13,8	3	2-4	6	5-7	9	8-10			5,5	16	5
SM-M20	71200200	20	13,9	4	3-5	7	6-8	10	9-11	13	12-13,5	6	20	5
SM-M25	71200300	25	22,6	8,5	7,5-9,5	11,5	10,5-12,5	14,5	13,5-15,5	17,5	16,5-18,5	7,5	25	5
SM-M32	71200400	32	29,6	16	15-17	19	18-20	22	21-23	25	24-26	9,5	32	5
SM-M40	71200500	40	37,6	23	22-24	26	25-27	29	28-30	32	31-33	12	40	5
SM-M50	71200600	50	47,6	30	29-31	33	32-34	36	35-37	39	38-40	14	50	5

Material / material / matière: Metall, Messing vernickelt / metal, brass, nickel plated / métallique, laiton nickelage

Schutzart / protection class / degré de protection: IP 65 (EN60529)

Temperaturbereich / temperature range / gamme de température: -40 °C bis +80 °C

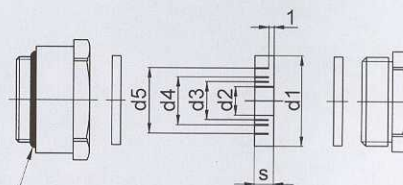

O-Ring  
O-ring  
joint terrique

## EPIC® CM-M

Artikel part article	Art.Nr. part No. N° art.	M metric thread pas métrique	d1	d2	Kabel Ø cable Ø câble Ø	d3	Kabel Ø cable Ø câble Ø	d4	Kabel Ø cable Ø câble Ø	d5	Kabel Ø cable Ø câble Ø	S	SW mm opening of the spanner ouverture de clef	VPE packing unit condition- nement
CM-M12	71201000	12	10	5	4-6							5	15	5
CM-M16	71201100	16	13,8	3	2-4	6	5-7	9	8-10			5,5	19	5
CM-M20	71201200	20	13,9	4	3-5	7	6-8	10	9-11	13	12-13,5	6	23	5
CM-M25	71201300	25	22,6	8,5	7,5-9,5	11,5	10-12,5	14,5	13,5-15,5	17,5	16,5-18,5	7,5	28	5
CM-M32	71201400	32	29,6	16	15-17	19	18-20	22	21-23	25	24-26	9,5	36	5
CM-M40	71201500	40	37,6	23	22-24	26	25-27	29	28-30	32	31-33	12	46	5
CM-M50	71201600	50	47,6	30	29-31	33	32-34	36	35-37	39	38-40	14	55	5

Material / material / matière: Metall, Messing vernickelt / metal, brass, nickel plated / métallique, laiton nickelage

Schutzart / protection class / degré de protection: IP 65 (EN60529)

Temperaturbereich / temperature range / gamme de température: -40 °C bis +80 °C