

Phone line protection

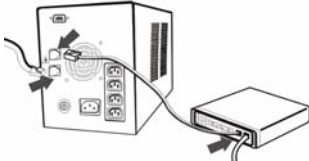

Connect incoming phone line to 'IN'
Connect a phone cable from 'OUT' to a modem

⚠ UPS does not provide dial-up function!

UK

Reminders

- ⚠ Fully discharge then recharge the battery every 3 month for longer battery life.
- ⚠ The backup time of the UPS depends on the connected devices and battery condition.
- ⚠ The batteries have self-discharge characteristic. It might happen that the battery capacity is already low just out of box. Please charge the UPS for 8 hours before using its power.
- ⚠ If UPS cannot be found in software, please read appendix D in manual on CD.
- ⚠ **Reset circuit breaker:** (1) disconnect some devices on UPS; (2) push it back.
- ⚠ **Replace battery :** in case it is necessary,

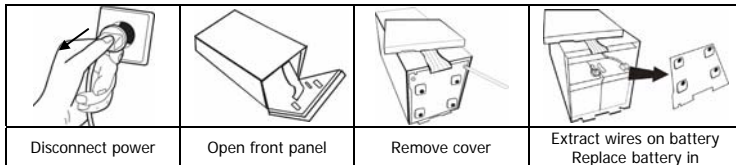

Technical specification		
Type of UPS		Line-Interactive UPS
Output capacity		1300VA/600 W
Input		230 VAC
	Voltage range	170 – 280 VAC
	Frequency	47-63 Hz
Output		230 VAC
	Frequency	50 o 60 Hz
	Freq. regulation	+/- 1 Hz

Surge current protection [J]		Max. 150
Maximum surge current [Amp]		6,500 A
Transfer time (typical)		Less than 3 ms
Battery	Battery type & number	CSB GP1270(F2), 12V/ 7AH
	Backup time (min.)	2 pieces
	Charge time	38 ~ 70
	Working surroundings	8 hours to 90% after full discharge
Surroundings	Working surroundings	0 ~ 40° C, 0-90% relative humidity
	Sound level	< 40 dB
Weight		13.8 kg

Safety

- Warning: This product contains sealed lead-acid battery(s).
May release toxic materials into the environment when not disposed properly.
Must be recycled properly. Contact your local government.
Short circuit of the battery(s) may cause burns, fire or explosion.
Do not disassemble, puncture or expose to high temperatures. Acid and toxic materials might be released, causing injury.
- This UPS generates leakage current less than 0.5mA, please use in comfort.
- The sum of the leakage current of the UPS and its connected equipments must not exceed 3.5mA.
- Do not open or repair this device.
- Disconnect the power plug from the mains supply before cleaning the device.
- Keep this device away from liquids, such as water.
- Do not use this device in combination with non-computer related items, such as medical equipment, microwave ovens, vacuum cleaners, etc.
- Make sure the UPS is placed on a firm surface, such as your desk or the floor.
- ALWAYS use the UPS with an earthed plug socket.
- Do not connect a multiple socket to the UPS.
- Never cover the UPS to avoid overheating. Keep the UPS out of the reach of heat sources, such as the sun, heaters, etc.
- The outputs may have a high voltage, even when the device is turned off.
- Keep the UPS at least 20 cm from your monitor.
- Do not expose the battery to a naked flame. This may cause the battery to explode.
- Never drill holes into the battery.
- The battery must not be opened or damaged. If the battery is opened or damaged, electrolyte may be released, which is harmful to skin, eyes and the environment.
- When the battery is empty, ask your local authority where you can dispose of it.
- The fan in UPS may get dusty after using a while, please remove the AC input power and turn off the UPS then use a soft brush gently clean off the dust for better ventilation of the UPS and longer product life.
- Do not insert any object into the fan while it's spinning which may lead to the broken of the fan, or damage of the UPS, or damage of the object being inserted.