

Aluminium Electrolytic Capacitors - Screw Terminals

multicomp PRO

**RoHS
Compliant**



Specifications

- Voltage range: 50 V DC to 550 V DC
- Can size: 35φ × 62mm to 90φ × 240mm
- Operating Temperature range: -40°C to +85°C
- Capacitance: 330μF to 470000μF Tolerance ±20%
- Leakage current: The max. leakage current (IL) is given by the formula:

$$I_r = 0.003 CV \text{ (microamps)}$$

C = capacitance in microfarads

V = DC rated voltage

Pre-conditioning of the capacitors prior to testing for leakage current is essential.

Ripple Current: All capacitors withstand rms ripple current at 100 Hz at 85°C. When capacitors operate at temperatures other than 85°C, the permissible rms ripple current at 85°C should be multiplied by the factors given below:

+40°C	+45°C	+50°C	+65°C
2.2	2.1	1.9	1.6

Where capacitors are required to operate at frequencies other than 100 Hz, the multiplying factors given below, may be used to determine the ripple current capacity, at that frequency.

Frequency Hz	100	250	500	1k to 10k	>10K
Multiplying Factor	1.0	1.05	1.20	1.32	1.35

Notes:

1. Can is negative, However, it is isolated with a PVC insulating sleeve and polypropylene end-disc.
2. Maximum ripple current for each capacitor diameter.

Capacitor Diameter (mm)	35	50	63	76	90
Max. Ripple Current (Amps)	20	20	40	40	72

Capacitor mounting

Capacitors are available in screw terminals in three mounting styles

AEST - Screw terminals with plain insulated base.

AEST-D - Screw terminals with stud mounting.

AEST-AL - Capacitor with aluminium bottom disc.

Capacitor Terminal Style

Capacitors are available in two different terminal style, round and across flat. Below table summarizes the available terminal styles in different capacitors diameter

Capacitors Diameter (mm)	35	50	63	76	90
Terminal Style - Round	○	○	○	○	○
Terminal Style - Across Flat		○	○	○	○

Marking on capacitors

Each capacitor will have the following information printed on it, sequentially:

- The Company's symbol f followed by the words ALCON ELECTROLYTIC
- The capacitor grade viz. PG-6DI
- The capacitance value_ μF, rated voltage_ V DC
- The surge voltage
- Capacity tolerance
- Climatic category
- Part number on non-standard capacitors
- CE marking

Aluminium Electrolytic Capacitors - Screw Terminals



Usefullife

Useful life is a period of time which the capacitor takes to reach "end of life".

For PG-601 capacitors the useful life is estimated as 12000 hours at maximum rated temperature, ripple current and voltages.

End of the defined as follows:

1. Catastrophic failure: capacitor short or open circuit
2. Mechanical failure: operation of safety vent or sleeve damage
3. Parametric failure:
 - a. Capacitance change $\pm 30\%$
 - b. ESR exceed three times specified value
- c. Leakage current exceed specified value

The useful life for a known ripple current load and ambient temperature (T_a) °C is determined on the basis of the "Life graph" shown below

Manufacturing Date Code Chart

The manufacturing code shall consists of four digits (alphanumeric). The first two shall denote the date (numeric). The third stands for the month (alpha numeric). The fourth stands for the year (alphabet)

First two spaces DATE	Third space MONTH	Fourth space YEAR
01	1 = JANUARY	A = 2012
02	2 = FEBRUARY	B = 2013
03	3 = MARCH	C = 2014
.	4 = APRIL	D = 2015
.	5 = MAY	E = 2016
.	6 = JUNE	F = 2017
10	7 = JULY	G = 2018
11	8 = AUGUST	H = 2019
.	9 = SEPTEMBER	J = 2020
.	X = OCTOBER	K = 2021
.	Y = NOVEMBER	L = 2022
31	Z = DECEMBER	M = 2023

For example:

1. Manufacturing code 023A will mean 2nd March, 2012
2. Manufacturing code IOXA will mean 10111 October, 2012

**LIFE GRAPH
PG -6DI**

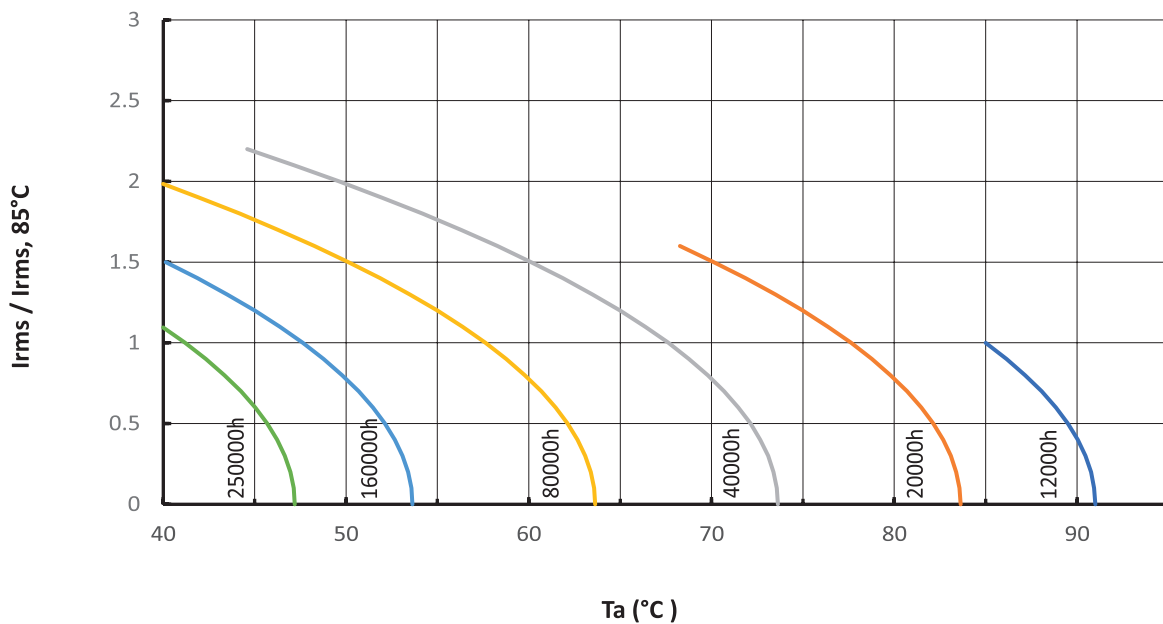

Aluminium Electrolytic Capacitors - Screw Terminals

multicomp PRO

Standard Capacitor Values

Rated Voltage (VDC)	Surge Voltage (VDC)	Capacitance Nominal (µF)	MAX ESR at 100Hz, 25°C (Ohms)	Ripple Current (Irms, 85°C) at 100Hz, 85°C(Amps)	Can size Nominal D × L mm	Case code	Part Number
400		2200	62.5	8.49	63 × 120	039	MP004243
350		10000	15.0	25.30	76 × 220	092	MP004244
350	MP004245						
350		2200	51.2	9.37	63 × 120	039	MP004246
450		2200	72.7	7.87	63 × 120	039	MP004247
450	MP004248						
500		2200	68.0	9.44	76 × 105	028	MP004249
500	MP004250						
350		2200	51.2	9.37	63 × 120	039	MP004251
400		2200	62.5	8.49	63 × 120	039	MP004252
500		3300	54.6	12.10	76 × 146	081	MP004253
500	MP004254						
350		3300	37.9	10.89	63 × 120	039	MP004255
350	MP004256						
400		3300	51.5	10.39	76 × 120	041	MP004257
400	MP004258						
450		3300	52.1	11.20	76 × 146	081	MP004259
450	MP004260						
500		4700	41.7	13.30	90 × 105	093	MP004261
500	MP004262						
350		4700	33.6	13.95	76 × 146	081	MP004263
350	MP004264						
400		4700	40.3	12.74	76 × 146	081	MP004265
400	MP004266						
450		4700	33.8	13.92	76 × 146	081	MP004267
450	MP004268						
450		5600	28.6	15.35	90 × 120	097	MP004269
450	MP004270						
500		5600	39.7	14.40	90 × 120	097	MP004271
500	MP004272						
350		5600	25.7	15.95	76 × 146	081	MP004273
350	MP004274						
400		5600	36.6	13.37	76 × 146	081	MP004275
400	MP004276						
350		6800	22.0	17.25	76 × 146	081	MP004277
350	MP004278						
400		6800	38.2	15.84	76 × 220	092	MP004279
400	MP004280						

Newark.com/multicomp-pro
Farnell.com/multicomp-pro
Element14.com/multicomp-pro

multicomp PRO

Aluminium Electrolytic Capacitors - Screw Terminals

multicomp PRO

Terminal Style And Dimension With Round Insert

Screw Terminal Type AEST/AEST-D

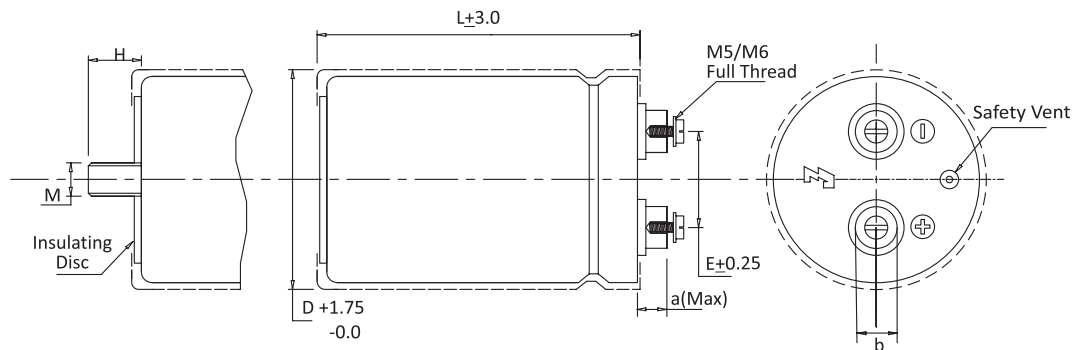

AEST -Screw terminals with plain insulated base.

AEST-D - Screw terminals with stud mounting.

Dimensions : Millimetres

Terminal	D	E	L	a (Max)	b ±0.1	M	H ±1.0
MS	35	12.6	62	7.8	9.5	-	-
MS	35	12.6	80	7.8	9.5	-	-
MS	35	12.6	105	7.8	9.5	-	-
MS	50	22.1	80	7.8	9.5	MU	17
MS	50	22.1	105	7.8	9.5	MU	17
MS	50	22.1	120	7.8	9.5	MU	17
MS	63	28.5	105	7.8	12	MU	17
MS	63	28.5	120	7.8	12	MU	17
MS	63	28.5	146	7.8	12	MU	17
MS	76	31.6	105	7.8	12	MU	17
MS	76	31.6	120	7.8	12	MU	17
MS	76	31.6	146	7.8	12	MU	17
MS	76	31.6	175	7.8	12	MU	17
MS	76	31.6	220	7.8	12	MU	17
MS	76	31.6	240	7.8	12	MU	17
M6	76	31.6	105	5.3*	16	MU	17
M6	76	31.6	120	5.3*	16	MU	17
M6	76	31.6	146	5.3*	16	MU	17
M6	76	31.6	175	5.3*	16	MU	17
M6	76	31.6	220	5.3*	16	MU	17.0
M6	76	31.6	240	5.3*	16	MU	17.0
M6	90	32	105	5.3*	16	MU	17.0
M6	90	32	146	5.3*	16	MU	17.0
M6	90	32	175	5.3*	16	MU	17.0
M6	90	32	220	5.3*	16	MU	17.0
M6	90	32	240	5.3*	16	MU	17.0

* Low Post Design

Newark.com/multicomp-pro
Farnell.com/multicomp-pro
Element14.com/multicomp-pro

multicomp PRO

Aluminium Electrolytic Capacitors - Screw Terminals

multicomp PRO

Terminal Style And Dimension With A/F Insert

Screw Terminal Type AEST/AEST-D

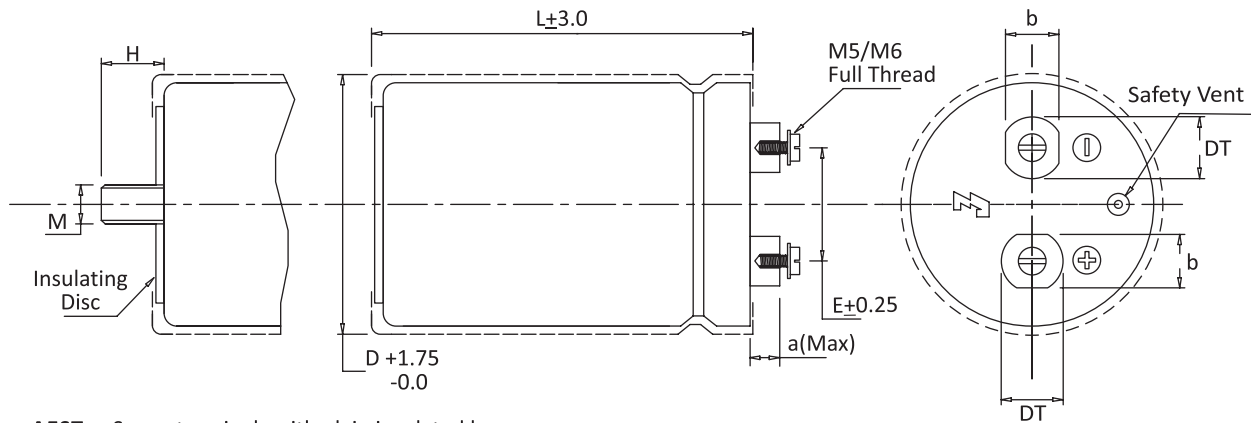

AEST -Screw terminals with plain insulated base.

AEST-D - Screw terminals with stud mounting.

Dimensions : Millimetres

Terminal	D	E	L	a (Max)	b (-0.2/+0.1)	DT (±0.1)	M	H ±1.0
M6	63	28.5	105	6.5	13	15	12	17
M6	63	28.5	120	6.5	13	15	12	17
M6	63	28.5	146	6.5	13	15	12	17
M6	76	31.6	105	6.5	13	15	12	17
M6	76	31.6	120	6.5	13	15	12	17
M6	76	31.6	146	6.5	13	15	12	17
M6	76	31.6	175	6.5	13	15	12	17
M6	76	31.6	220	6.5	13	15	12	17
M6	76	31.6	240	6.5	13	15	12	17
M6	90	32	105	6.5	13	15	12	17
M6	90	32	120	6.5	13	15	12	17
M6	90	32	146	6.5	13	15	12	17
M6	90	32	175	6.5	13	15	12	17
M6	90	32	220	6.5	13	15	12	17
M6	90	32	240	6.5	13	15	12	17
M6	100	32	105	6.5	13	15	12	17
M6	100	32	120	6.5	13	15	12	17
M6	100	32	146	6.5	13	15	12	17
M6	120	41.5	105	6.5	13	15	12	17
M6	120	41.5	120	6.5	13	15	12	17
M6	120	41.5	146	6.5	13	15	12	17

Aluminium Electrolytic Capacitors - Screw Terminals

Terminal Style And Dimension

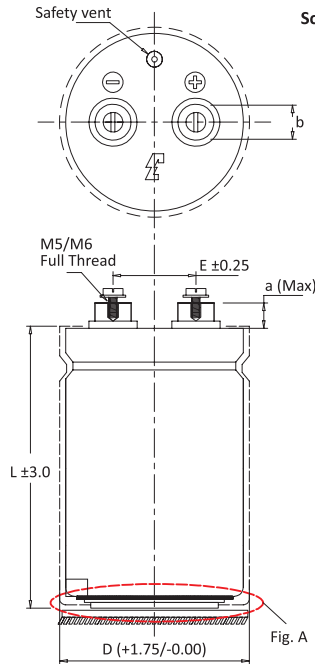

Screw Terminal Type AEST-AL

Note :
Ripple current rating of a capacitor with AEST-AL mounting can increase 20-30% with efficient cooling of the aluminum mounting plate / heat sink

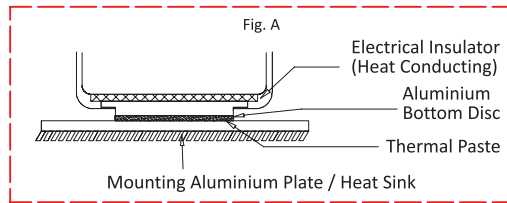

Dimensions : Millimetres

Terminal	D	E	L	a (Max)	b ±0.1
M5	63	28.5	105	7.8	12
M5	63	28.5	120	7.8	12
M5	63	28.5	146	7.8	12
M5	76	31.6	105	7.8	12
M5	76	31.6	120	7.8	12
M5	76	31.6	146	7.8	12
M5	76	31.6	175	7.8	12
M5	76	31.6	220	7.8	12
M5	76	31.6	240	7.8	12
M6	76	31.6	105	5.3*	16
M6	76	31.6	120	5.3*	16
M6	76	31.6	146	5.3*	16
M6	76	31.6	175	5.3*	16
M6	76	31.6	220	5.3*	16
M6	76	31.6	240	5.3*	16
M6	90	32	105	5.3*	16
M6	90	32	146	5.3*	16
M6	90	32	175	5.3*	16
M6	90	32	220	5.3*	16
M6	90	32	240	5.3*	16

* Low Post Design

Aluminium Electrolytic Capacitors - Screw Terminals

Mounting Accessories

Mounting Nut and Washers for Cans with Bottom Stud

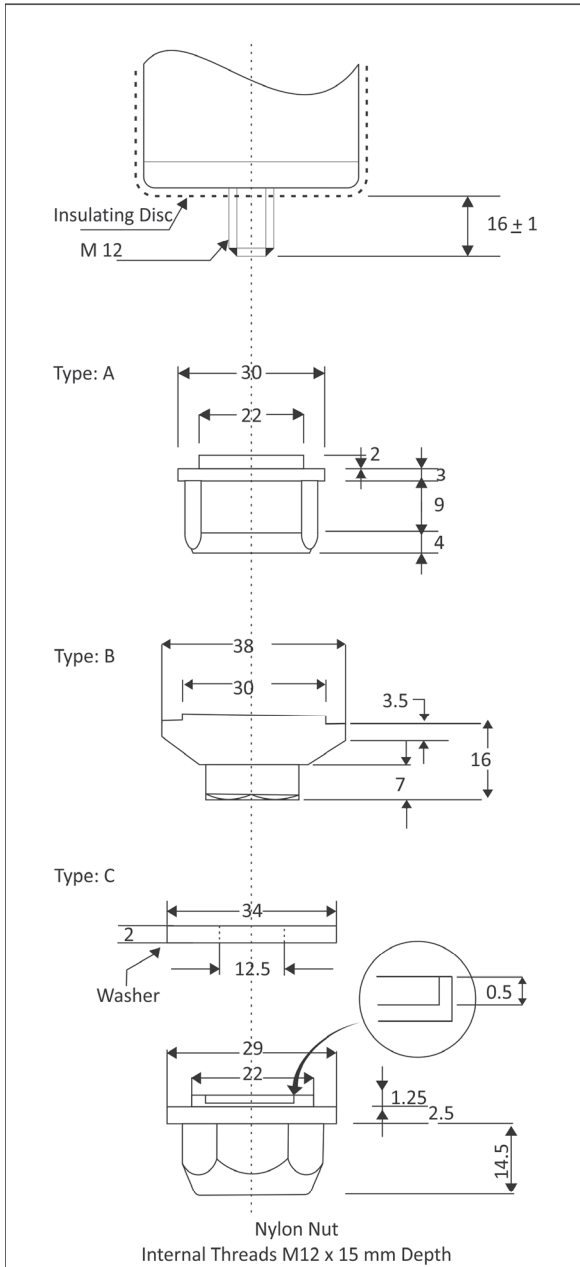

Vertical Mounting Clamps

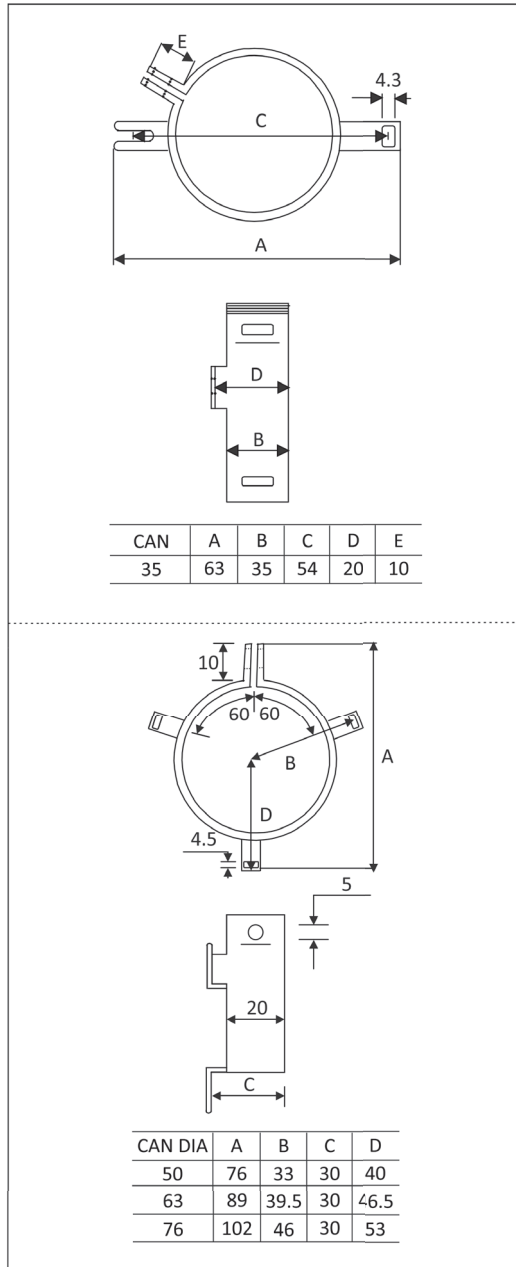

Important Notice : This data sheet and its contents (the "Information") belong to the members of the AVNET group of companies (the "Group") or are licensed to it. No licence is granted for the use of it other than for information purposes in connection with the products to which it relates. No licence of any intellectual property rights is granted. The Information is subject to change without notice and replaces all data sheets previously supplied. The Information supplied is believed to be accurate but the Group assumes no responsibility for its accuracy or completeness, any error in or omission from it or for any use made of it. Users of this data sheet should check for themselves the Information and the suitability of the products for their purpose and not make any assumptions based on information included or omitted. Liability for loss or damage resulting from any reliance on the Information or use of it (including liability resulting from negligence or where the Group was aware of the possibility of such loss or damage arising) is excluded. This will not operate to limit or restrict the Group's liability for death or personal injury resulting from its negligence. Multicomp Pro is the registered trademark of Premier Farnell Limited 2019.