

## Cable sockets and plugs with molded-on lead

### Product features

- connection of inductive or capacitive proximity switches
- photoelectric barriers
- pressure-operated switches etc.

### Variations

- cable sockets and plugs without LED (housing black, cable black)
- cable sockets with LED (housing transparent, cable black)

### Basic data

- protection class IP 68 (IEC 60529)
- high flexible lead
- conductor color identification complies with European standards (EN 50044)

### Further information

see technical data in the catalog  
Circular connectors for automation technique  
DS 280 490-450.

**For tailor-made systems,**  
see page 6

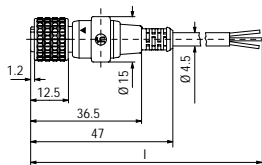
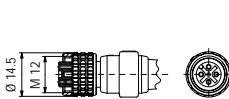

ELKA-KV...

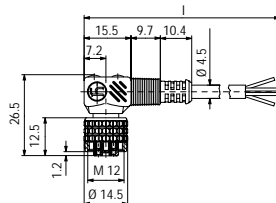
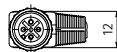

ELWIKA-KV...

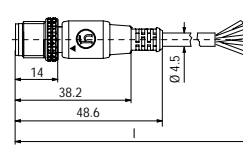
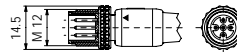

ELST-KV...

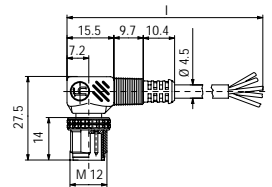
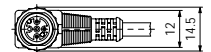

ELWIST-KV...

## Componentries (cable sockets with LED)

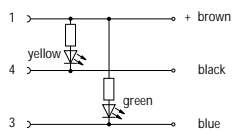

NS/C

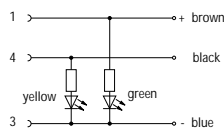

PS/A

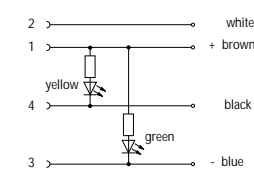

NS/G

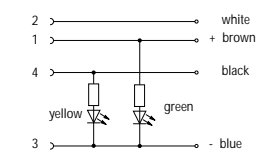

PS/F

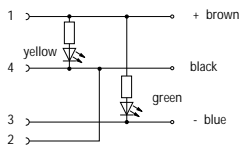

NS/M

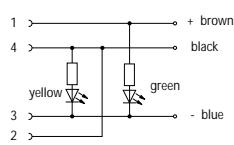

PS/K

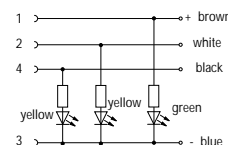

PS/P

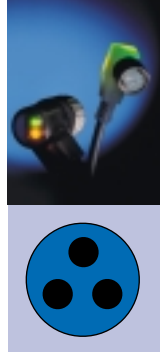

## Cable sockets and plugs with molded-on lead

poles	cable material	length	socket		plug		operating voltage	componentry (cable sockets with LED)				
			straight ELKA-KV	angled ELWIK-AKV	straight ELST-KV	angled ELWIST-KV						
3	4312	PUR	2m	933 330-021	933 316-021	933 337-021	933 340-021	UC 250 V (≈)				
			5m	933 330-022	933 316-022	933 337-022	933 340-022					
		PVC	2m	933 237-041	933 226-041	933 241-041	933 244-041					
			5m	933 237-042	933 226-042	933 241-042	933 244-042					
		4312 NS/C	PUR	2m	933 327-021	933 318-021					DC 10...30 V (=)	NPN normally open LED green/LED yellow
				5m	933 327-022	933 318-022						
	PVC	2m	933 275-041	933 228-041								
		5m	933 275-042	933 228-042								
	4312 PS/A	PUR	2m	933 326-021	933 317-021			DC 10...30 V (=)	PNP normally open LED green/LED yellow			
			5m	933 326-022	933 317-022							
	PVC	2m	933 240-041	933 227-041								
		5m	933 240-042	933 227-042								
4	4412	PUR	2m	933 331-021	933 319-021	933 338-021	933 341-021	UC 250 V (≈)				
			5m	933 331-022	933 319-022	933 338-022	933 341-022					
		PVC	2m	933 238-041	933 235-041	933 242-041	933 245-041					
			5m	933 238-042	933 235-042	933 242-042	933 245-042					
		4412 NS/G	PUR	2m	933 328-021	933 321-021					DC 10...30 V (=)	NPN normally open/closed (antivalent) LED green/LED yellow
				5m	933 328-022	933 321-022						
	PVC	2m	933 276-041	933 231 041								
		5m	933 276-042	933 231-042								
	4412 PS/F	PUR	2m	933 329-021	933 320-021			DC 10...30 V (=)	PNP normally open/closed (antivalent) LED green/LED yellow			
			5m	933 329-022	933 320-022							
	PVC	2m	933 277-041	933 230-041								
		5m	933 277-042	933 230-042								
	4412 NS/M	PUR	2m		933 323-021			DC 10...30 V (=)	NPN normally open/closed (pole 2 + 4 bridged) LED green/LED yellow			
			5m		933 323-022							
			2m		933 233-041							
	PVC	2m			933 233-042							
		5m										
	4412 PS/K	PUR	2m		933 322-021			DC 10...30 V (=)	PNP normally open/closed (pole 2 + 4 bridged) LED green/2x LED yellow			
			5m		933 322-022							
	PVC	2m			933 232-041							
		5m			933 232-042							
	4412 PS/P	PUR	2m		933 324-021			DC 10...30 V (=)	PNP normally open/closed (antivalent) LED green/LED yellow			
			5m		933 324-022							
	PVC	2m			933 234-041							
5m				933 234-042								
5	5512	PUR	2m	933 332-021	933 325-021	933 339-021	933 342-021	UC 50 V (≈)				
			5m	933 332-022	933 325-022	933 339-022	933 342-022					
		PVC	2m	933 239-041	933 236-041	933 243-041	933 246-041					
	5m		933 329-042	933 236-042	933 243-042	933 246-042						

Example for placing orders: 933 326-021 ELKA-KV 4312 PS/A PUR 034 2m

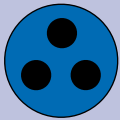

## Cable sockets and plugs for self-assembly

### Product features

- connection of
  - inductive or capacitive proximity switches
  - photoelectric barriers
  - pressure-operated switches etc.

### Variations

- cable sockets and plugs without LED (housing black, PG7 and PG9)
- cable sockets and connectors, LED insertable (accessories), (housing transparent/topas, PG7)
- cable sockets and connectors with plastic coupling nut/thread (housing black, PG7)

### Basic data

- protection class IP 67 (IEC 60529)
- strain relief by means of clamping cage
- type of termination screw

### Further information

see technical data in the catalog  
Circular connectors for automation technique DS 280 490-450.  
**For tailor-made systems,** see page 6

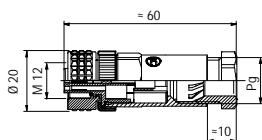

ELKA...PG...

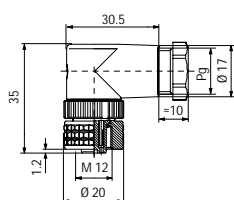

ELWIKA...PG...

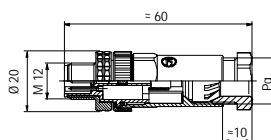

ELST...PG...

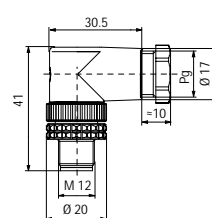

ELWIST...PG...

**Cable accommodation:** PG7:  $\varnothing$  4...6 mm (0,160...0,235 inches)  
PG9:  $\varnothing$  6...8 mm (0,24...0,315 inches)

**Plastic-coupling nut/thread:** standard with type 4012 K PG 7; for all other types on demand.

poles	socket		plug		operating voltage	comments	
	straight ELKA	angled ELWIKA	straight ELST	angled ELWIST			
4	4012 PG 7	933 139-100	933 172-100	933 098-100	UC 250 V ( $\approx$ ) <sup>1)</sup>	housing transparent, accessories LED insert <sup>2)</sup> plastic-coupling nut/thread	
	4012 PG 7 TO	933 210-199	933 173-199				
	4012 K PG 7	933 725-100	933 726-100	933 727-100			933 728-100
	4012 PG 9	933 169-100	933 174-100	933 162-100			933 166-100
5	5012 PG 7	933 170-100	933 175-100	933 163-100	UC 50 V ( $\approx$ )		
	5012 PG 9	933 171-100	933 176-100	933 164-100		933 168-100	

<sup>1)</sup> operating voltage without LED insert, type ELKA 4012 PG 7 TO and ELWIKA 4012 PG 7 TO

<sup>2)</sup> LED insert PNP/normally open 933 405-001 E 2 LED PNP (DC 10...30 V)  
LED insert NPN/normally open 933 404-001 E 2 LED NPN (DC 10...30 V)

**Example for placing orders:** 933 139-100 ELKA 4012 PG7

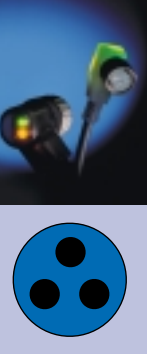

## Appliance sockets and connectors for self-assembly with wire ends

### Product features

Installation of controls and switch gear in housing (instead of standard PG screw couplings)

### Variations

Appliance sockets and connectors for self-assembly with wire ends.

### Basic data

- protection class IP 67 (IEC 60529)
- conductor color identification complies with European standards (EN 50044)

### Further information

see technical data in the catalog Circular connectors for automation technique DS 280 490-450.

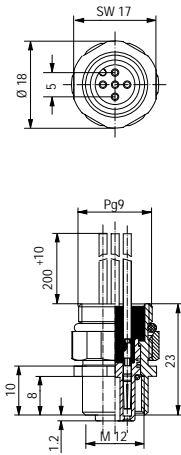

ELKE...PG 9

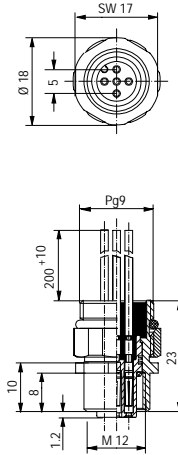

ELKE...PG 9 P

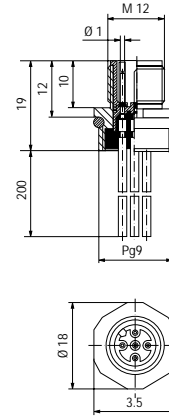

ELST...PG 9

poles		socket ELKE		plug ELST		operating voltage	comments
		contacts tin-plated	contacts gold-plated	contacts tin-plated	contacts gold-plated		
4	412 PG 9	933 039-100		933 916-206	933 216-106	UC 250 V (≈)	
	412 PG 9 P		933 044-100			UC 250 V (≈)	coding with adjusting nut, re-positionable
5	512 PG 9		933 040-100		932 878-100	UC 50 V (≈)	
	512 PG 9 P		933 045-100			UC 50 V (≈)	coding with adjusting nut, re-positionable

accessories: fastening nut with PG 9 thread 733 877-001 ELST M PG 9

**Example for placing orders:** 933 039-100 ELKE 412 PG9

## Appliance sockets and connectors for front panel mounting

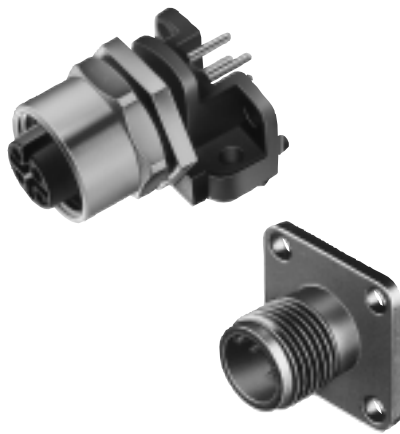

### Product features

usage in housings of control systems, switch cabinets, sensors and actuators (combined front panel and circuit board installation especially for industrial mounting)

### Variations

- cable sockets for combined front panel and circuit board installation
- cable plug for flange mounting

### Basic data

- protection class IP 68 (IEC 60529)

- type of termination solder

### Further information

see technical data in the catalog  
Circular connectors for automation technique DS 280 490-450.

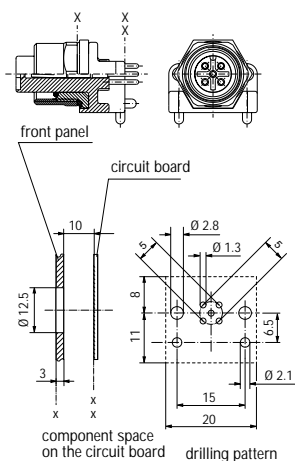

ELKE... FM

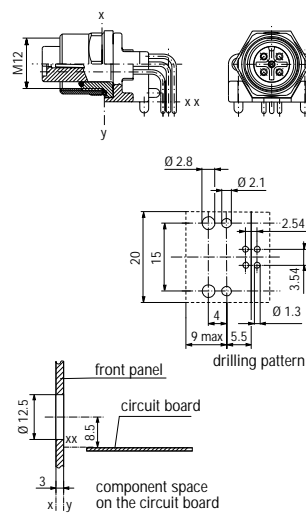

ELKE... FM H

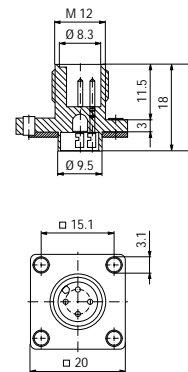

ELST 412 FA

poles	socket ELKE		plug ELST		operating voltage	comments
	contacts tin-plated	contacts gold-plated	contacts tin-plated	contacts gold-plated		
4	412 FM 412 FM H	933 279-100 933 395-100			UC 150 V (≈)	
	412 FA		932 328-206		UC 150 V (≈) UC 50 V (≈)	with flat gasket (only ELST 412 FA)
5	512 FM 512 FM H	933 551-100 933 821-100				

Example for placing orders: 933 279-100 ELKE 412 FM

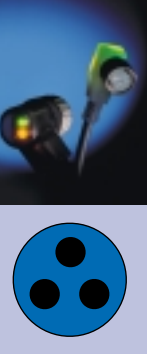

## Appliance connectors for press-in fit

### Product features

mounting in sensor tubes (press-in mounting) of proximity switches, photoelectric barriers etc.

### Variations

- appliance connectors without thread
- appliance connectors with thread
- appliance connectors with thread and LED

### Basic data

- protection class IP 68 (IEC 60529) (ELST 400/12 093 and ELST 400 L/12 093: IP 67)
- type of connection solder

### Further information

see technical data in the catalog  
Circular connectors for automation technique  
DS 280 490-450.

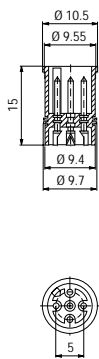

ELST 400/12 093  
(without vent hole)

ELST L 400/12 093

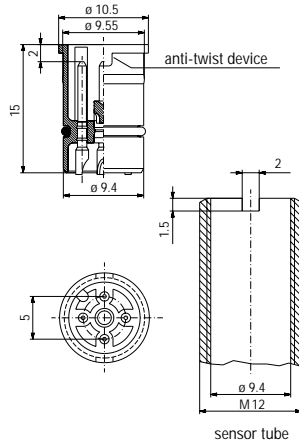

ELST 400 RD/12  
(without anti-twist device)

ELST 400 RD/12 V

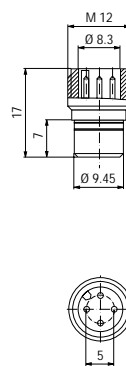

ELST 412

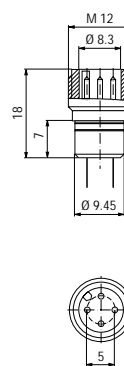

ELST 412 LED

poles		plug ELST		operating voltage	comments
		contacts tin-plated	contacts gold-plated		
4	400/12 093	932 440-206	932 440-106	UC 150 V (≈)	without vent hole
	400 L/12 093	932 416-206	932 416-106		with vent hole
	400 RD/12	932 559-406	932 559-306		with sealable vent hole
	400 RD/12 V	933 442-406	933 442-306		with sealable vent hole and anti-twist device
	412	932 902-206	932 902-106		without vent hole
	412 LED red	932 256-212	932 256-112	UC 50 V	without vent hole, LED max. 10 mA
	412 LED yellow	933 363-212	933 363-112	(≈)	without vent hole, LED max. 10 mA

Example for placing orders: 932 440-206 ELST 400/12 093