

# KST K.S. TERMINALS INC.

## INSULATED QUICK DISCONNECTORS

### NYLON-INSULATED FLAG FEMALE DISCONNECTORS

MAXIMUM ELECTRIC CURRENT :  
 22-18 A.W.G. : 10 AMPERE 16-14 A.W.G. : 15 AMPERE  
 MAXIMUM ELECTRICAL RATING : 105°C 300 VOLTS MAX.  
 INSULATION MATERIAL : NYLON  
 INSULATION COLOR :  
 22-18 A.W.G.: RED ■■■ 16-14 A.W.G.: BLUE ■■■  
 TERMINAL MATERIAL : BRASS

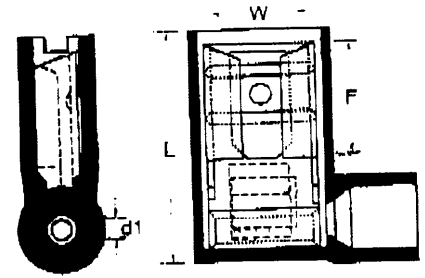

WIRE RANGE A.W.G. mm <sup>2</sup>	ITEM NO.	NEMA TAB	DIMENSION <small>inch mm</small>					CRIMPING TOOL	QTY BOX
			W	F	L	d1	T		
22-18 A.W.G. 0.5-1.5 mm <sup>2</sup>	FLDNY1-250	.032 x .250 (0.8 x 6.35)	.260 6.6	.299 7.6	.630 16.0	.067 1.7	.016 0.4	K.S. MODEL KST2000F WITH DIE INDEX COLOR : RED	1000
16-14 A.W.G. 1.5-2.5 mm <sup>2</sup>	FLDNY2-250	.032 x .250 (0.8 x 6.35)	.260 6.6	.299 7.6	.630 16.0	.091 2.3	.016 0.4	K.S. MODEL KST2000F WITH DIE INDEX COLOR : BLUE	1000

### NON-INSULATED FLAG FEMALE DISCONNECTORS

MAXIMUM ELECTRIC CURRENT :  
 22-18 A.W.G. : 10 AMPERE  
 16-14 A.W.G. : 15 AMPERE  
 12-10 A.W.G. : 24 AMPERE  
 TERMINAL MATERIAL : BRASS

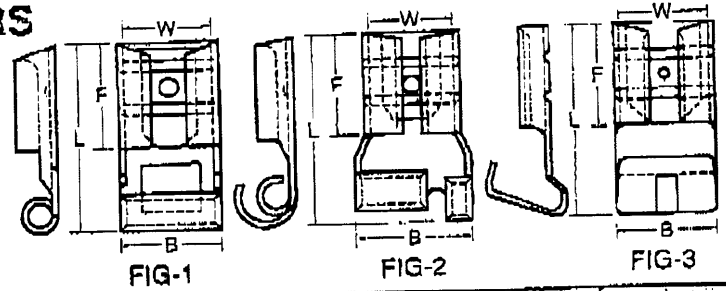

WIRE RANGE A.W.G. mm <sup>2</sup>	ITEM NO.	NEMA TAB	DIMENSION <small>inch mm</small>					FIG	CRIMPING TOOL	QTY BOX
			W	F	L	B	T			
22-18 A.W.G.	FLDNB1-187(5)	.020 x .187 (0.5 x 4.75)	.187 5.0	.244 6.2	.445 11.3	.217 5.5	.016 0.4	1		1000
	FLDNB1-187(8)	.032 x .187 (0.8 x 4.75)	.197 5.0	.244 6.2	.445 11.3	.217 5.5	.016 0.4	1		1000
0.5-1.5 mm <sup>2</sup>	FLDNB1-250	.032 x .250 (0.8 x 6.35)	.260 6.6	.299 7.6	.551 14.0	.291 7.4	.016 0.4	1		1000
	FLDNG1-250		.260 6.6	.307 7.8	.591 15.0	.366 9.3	.018 0.45	2		1000
16-14 A.W.G.	FLDNB2-187(5)	.020 x .187 (0.5 x 4.75)	.197 5.0	.244 6.2	.457 11.6	.217 5.5	.016 0.4	1		1000
	FLDNB2-187(8)	.032 x .187 (0.8 x 4.75)	.197 5.0	.244 6.2	.457 11.6	.217 5.5	.016 0.4	1		1000
1.5-2.5 mm <sup>2</sup>	FLDNB2-250	.032 x .250 (0.8 x 6.35)	.260 6.6	.299 7.6	.551 14.0	.291 7.4	.016 0.4	1		1000
	FLDNG2-250		.260 6.6	.307 7.8	.591 15.0	.366 9.3	.018 0.45	2		1000
12-10 A.W.G. 4-6 mm <sup>2</sup>	FLDNB5-250	.032 x .250 (0.8 x 6.35)	.260 6.6	.299 7.6	.571 14.5	.295 7.5	.018 0.45	3		500